

Price List 1-2008



Concorde

REISEMOBILE AUS LEIDENSCHAFT

STANDARD SPECIFICATION

Iveco Daily 50C15 chassis

CARVER

Turbocharged diesel engine with electrically controlled Common Rail direct injection	•
Compliance with Euro 4 emissions standard by means of exhaust gas recirculation and particle filter	•
6-speed transmission with dashboard gear shift	•
Rear wheel drive with ASR traction control system	•
Independent front wheel suspension	•
Rear axle with comfortable parabolic springs, air suspension available as an option	•
Twin rear wheels with 195/75 R 16	•
Disc brakes on front and rear axles	•
Electronic brake-pad wear indicator	•
Electronic brake-force distribution (EBD)	•
Electronically controlled anti-lock braking system (ABS)	•
Cruise control system	•
Alternator 14 V, 140 A / 1,960 W	•
Battery 12 V / 110 Ah	•
Fuel tank - 100 l	•
Thermostatically controlled heating system with 4-stage blower and recirculation circuit	•
Cab air-conditioning system	•
Twin headlights	•
Electrically adjustable, heated door mirrors	•
Independent driver-active dashboard	•
Sound insulation for cab floor and front wall	•
Warning triangle and first-aid kit	•
Warning lamp and two wheel chocks	•

Coachwork

CARVER

Modern bus design	•
Panoramic tinted, laminated glass windscreen with heated windscreen wiper parking section	•
Sliding toughened, tinted, insulating glass side windows with integrated blind	•
Tinted double-glazed tilting/sliding plastic windows in the living area with integrated blind and fly screen	•
Electrically operated insulating roller blind for the windscreen	•
Rugged long-life Solidtherm aluminium sandwich construction	•
"Faraday cage" lightning protection	•
Fully insulated wall joining technique using high-density solid PU profiles to eliminate cold spots	•
Completely insulated cab	•
Heater between insulating roller blind and windscreen	•
Walls 42 mm thick with 40 mm closed-cell, high-resistance RTM foam	•
Chromated aluminium alloy external and internal wall, roof and underbody panels	•
Smooth outer panels with white baked enamel finish	•
Walk-on roof	•
Aluminium roof profile sections with rain channel to reduce soiling of the side walls	•
Front and side skirts made of strong but flexible, corrosion-free GRP material	•
GRP sandwich rear wall construction (approx. 45 mm thick) with PU foam core	•
Separate GRP rear bumper for easy replacement	•
Heated double floor construction, intrafloor space approx. 300 mm high, accessible via outside flaps	•
Luggage locker doors with flush, aerodynamic cast aluminium hinges	•
Sandwich-type floor and intermediate panel construction with 40 mm and 30 mm RTM foam insulation respectively, adding up to a total of 70 mm	•
Rugged GRP wheel arches with fully insulated sandwich construction for the rear axle	•
Illuminated rear garage with doors on the right-hand side and loading flap on the left-hand side, luggage tie-down system and 230 V socket-outlet	•
Illuminated, heated double step inside the door	•
Electrically retractable step outside the door with safety circuit	•
Solid door with safety lock	•
Exterior light with safety circuit, switches off automatically when the engine is started	•
Cockpit seats with armrests for driver and co-driver covered in the same material as the seats in the living area	•
"Carver" decals in blue and silver	•

STANDARD SPECIFICATION

Living area / Bedroom

CARVER

Single-level Concorde floor from the dashboard right through to the rear	•
Walls and ceiling covered in colour-coordinated carpet	•
Easy-clean plastic floor covering	•
Removable quality carpets	•
Ergonomic, high-quality, Diolen-upholstered seating elements with zip-off covers	•
Caramel microfibre covers on the seats in the living area and in the cab	•
Bench seat with seat belts for one passenger	•
High-quality furnishings with laminate or veneer construction	•
Furniture flaps and doors with real wood veneer on both sides, with metal hinges and catches	•
Spacious wardrobe with mirror on the inside of the door	•
Rear bed with slatted frame and comfortable cold foam mattress	•
Double-glazed Midi roof hatch in the living area with integrated lighting, blind and fly screen	•
Roof hatch in the bedroom with integrated blind and fly screen	•
Sturdy laminated table with wood grain finish	•
Fabric curtains at the windows in the living area and bedroom	•
Lighting canopies with halogen spotlights and integrated lighting	•
Sturdy, solid-wood handle inside the door	•
12 V and 230 V socket-outlets throughout living area and bedroom	•
Curtain between living area and cab	•

Pulldown bed (Option)

Mattress dimensions approx. 198 x 126 cm	•
Headroom above bed approx. 86 cm	•
Two-part sprung slatted frame with single Carawinx mattress	•
Roof hatch with integrated blind and fly screen	•

Kitchen

CARVER

Flush-fitted three-flame stainless steel gas hob with automatic ignition	•
Flush-fitted stainless steel sink	•
Level glass covers for hob and sink	•
Single-lever chrome sink mixer with retractable handspray	•
Worktop in the kitchen area with hard-wearing laminate finish	•
97 l AES refrigerator with separate freezer compartment (manual/automatic three-way energy changeover switch - 12 V / 230 V / gas)	•
Generously dimensioned cupboards with removable shelving	•
Cutlery drawer	•
Thermostatically controlled roof fan	•
Lighting with halogen spotlights in the light canopy and under the wall cupboards	•
2 x 230 V socket-outlets	•

Bathroom / Toilet

Bathroom designed to match the living area, wood-panelled walls	•
Bathroom cabinet with mirror and shelf	•
Lighting with halogen spotlights and outside switch	•
Corisan washstand with seamlessly integrated washbasin	•
Single-lever chrome mixer with extendable shower attachment on the washstand	•
Cupboard under washbasin in semicircular design	•
Generously sized shower cubicle with acrylic glass door	•
Shower column with soap dishes and chrome railings	•
Shower mixer with wall rail and shower head with height adjustment facility	•
Integrated water-flush toilet	•
Toilet paper holder, liquid soap dispenser, towel rail and hooks	•
Roof hatch with integrated fly screen and blind	•
2 x 230 V socket-outlets	•

STANDARD SPECIFICATION

Water / Gas / Heating

CARVER

Gas compartment capable of accommodating 2 x 11 kg gas bottles, 30 mb gas pressure	•
Cut-off valves for all appliances	•
Gas regulator with state-of-the-art automatic bottle changeover system	•
Freshwater and wastewater tanks fitted in the heated intrafloor area, each approx. 170 l	•
Easy access wastewater drain valve in the heated intrafloor area	•
Access to both tanks from living area for easy cleaning	•
Direct drainage facility for the freshwater tank using the valve in the heated intrafloor area	•
Wastewater drain hose with bayonet connection	•
Automatically operating central water pump with surge tank	•
5500 W engine-independent gas-fired central heating / hot-water system with thermostatic control and time switch, 230 V / 3000 W electric heater, automatic vent valve, non-return valve	•
Integrated hot-water boiler to supply all taps	•
Heat exchanger that uses the heat produced by the engine to heat the living area	•
Service access via separate outside flap	•

Electricity / TV / Radio

150 AH gel battery in the intrafloor area	•
230 V CEE connection in the luggage compartment with cable routing through the intrafloor area	•
Central control and distribution module with microprocessor technology	•
Automatic battery charging facility with electronic control and battery temperature sensor, 25 A maximum charging current	•
Automatic charging of leisure and vehicle batteries when connected up to an external power supply and while driving	•
Automatic connection and disconnection of leisure and vehicle batteries	•
Automatic refrigerator cut-off in 12 V mode when the engine is switched off	•
Deactivation of on-board electrical system when voltage too low or in the event of overheating, with automatic reactivation	•
Automatic residual-current-operated circuit breaker	•
300 W sine-wave power inverter (230 V to all socket-outlets – even when not connected to external power supply) and mains priority circuit	•
230 V socket-outlet in the garage	•
Radio with CD and MP3 player	•
Broadband speakers with separate tweeters and frequency separating filter behind the side trim panels in the cab	•

On-board electronics

CARVER

Ultra-modern microprocessor-controlled on-board electronic system with BUS technology (Binary Unit System)	•
Central control and monitoring panel	•
Master switch for all items of equipment	•
Pushbuttons to switch the following systems on and off:	
• Heating	•
• Anti-freeze system for the gas pressure regulator	•
• Lighting	•
• Water pump	•
• Power inverter	•
LCD indicator panel for monitoring of:	
• Freshwater tank	•
• Wastewater tank	•
• Voltage of the leisure and vehicle batteries	•
• Outside and inside temperatures	•
• Charging and discharging current	•
• External power supply	•
• Batteries connected in parallel	•
• Date and time with alarm clock function	•
Alarm facilities for:	
• Wastewater tank full	•
• Freshwater tank empty	•
• Low battery voltage	•
• Reserve gas bottle in use	•
• Step extended	•

TECHNICAL DATA

Carver

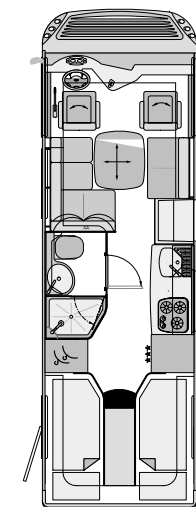
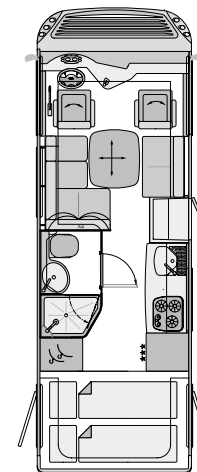
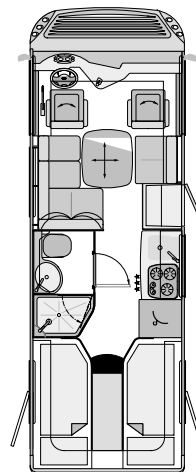
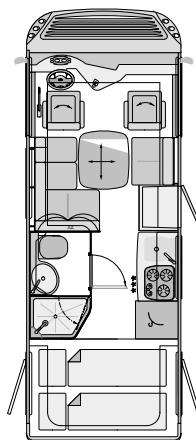

	CARVER 642 H	CARVER 692 L	CARVER 692 H	CARVER 742 L
Basic vehicle	Iveco Daily	Iveco Daily	Iveco Daily	Iveco Daily
Chassis	50C15	50C15	50C15	50C15
Engine	4-cylinder	4-cylinder	4-cylinder	4-cylinder
Cubic capacity	3.0 l	3.0 l	3.0 l	3.0 l
Power	107 kW (146 HP)	107 kW (146 HP)	107 kW (146 HP)	107 kW (146 HP)
Torque	350 Nm	350 Nm	350 Nm	350 Nm
Overall length (mm)	6480	6980	6980	7480
Overall width (mm)	2380	2380	2380	2380
Overall height (mm)	3190	3190	3190	3190
Wheelbase (mm)	3450	3750	3750	3950
Maximum permissible weight (kg)	5200	5200	5200	5200
Kerb weight ¹ (kg)	4070	4230	4230	4390
Payload ¹ (kg)	1130	970	970	810
Trailer load in kg	2500	2500	2500	2500
Seats with three-point safety belts	3	3	3	3
Left-hand seating element (mm)	1400/980	1400/980	1400/980	1400/980
Right-hand bench seat (mm)	710/640	710/640	910/640	910/640
Rear bed (mm)	2100/1460	2 x 1960/850	2100/1460	2 x 1960/850
Pulldown bed dimensions (optional, mm)	1980/1260	1980/1260	1980/1260	1980/1260
Headroom above pulldown bed (mm)	860	860	860	860
Right-hand garage door H/W (mm)	1250/800	1250/800	1250/800	1250/800
Left-hand garage door H/W (mm)	500/800	500/800	500/800	500/800
Price in euros (including 19% VAT)	116,000.00	118,000.00	118,000.00	123,000.00

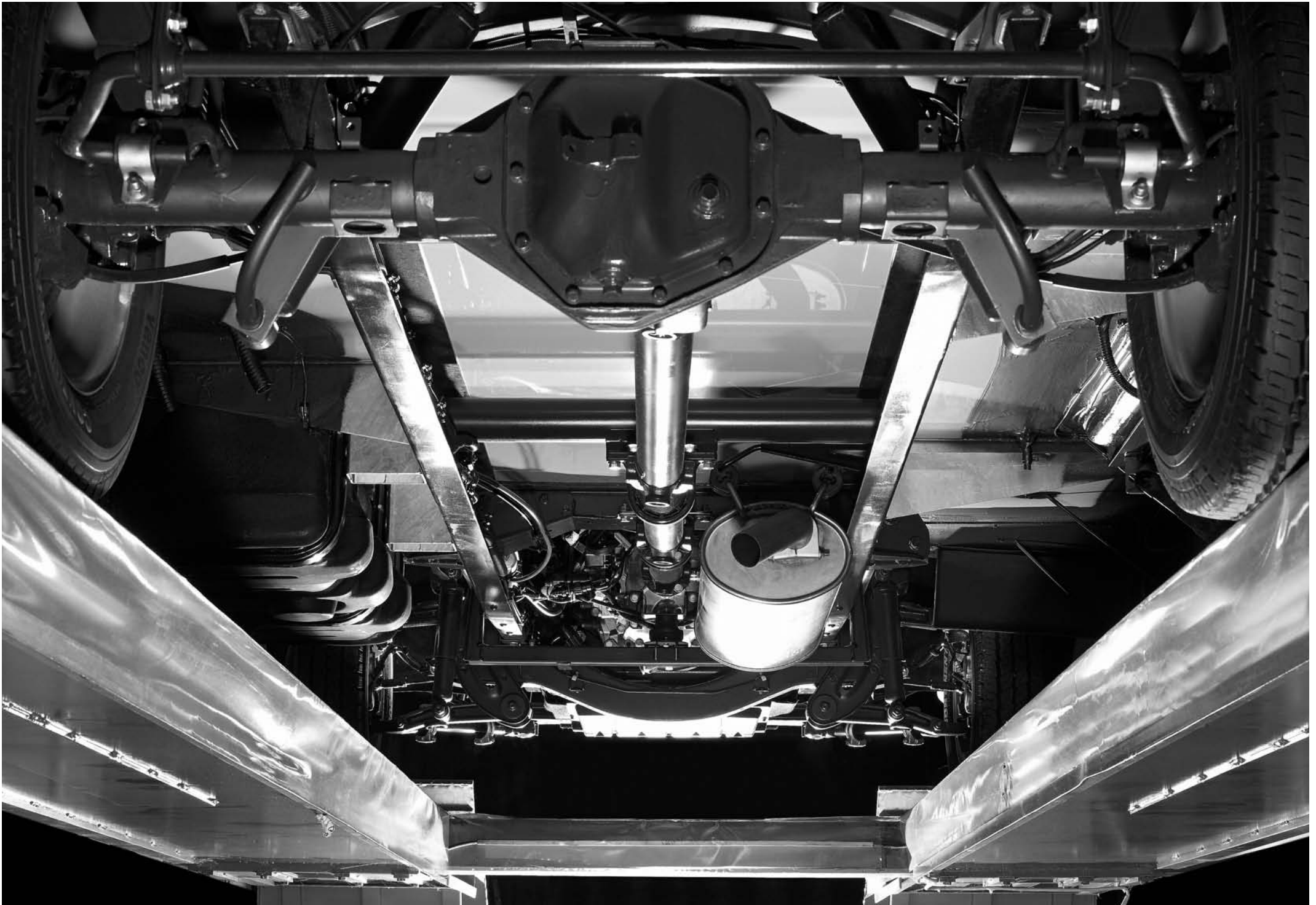

SPECIAL OPTIONS - CHASSIS / COACHWORK

Iveco Daily chassis

		PRICE IN EUROS incl. 19 % VAT	EXTRA WEIGHT in kg
709 052	Complete basic vehicle package Carver (975 euros saving in comparison to individual order) Engine version 18, 130 kW / 177 HP / 3500 rpm, 400 Nm torque at 1250 - 3070 rpm Trailer coupling (increases the overall length of the vehicle by around 65 mm) Aluminium rims for front axle with 225/65R16 tyres, hub cap for steel wheel rim for rear axle with 195/75R16 tyres Agile automated 6-speed manual transmission Elegant wood grain finish for dashboard Increased permitted load on front axle including 4 persons	5,550.00	54
125 046	Engine version 18, 130 kW / 177 HP / 3500 rpm, 400 Nm torque at 1250 - 3070 rpm	1,200.00	5
702 215	Aluminium rims for front axle with 225/65R16 tyres, hub cap for steel wheel rim for rear axle with 195/75R16 tyres Increased permitted load on front axle including 4 persons	1,790.00	-2
700 051	Trailer coupling (only available as a factory-fitted option, increases the overall length of the vehicle by around 65 mm)	1,350.00	29
700 043	Deduction for ball hitch and bumper cutout for trailer coupling	- 150.00	- 4
700 041	Removable ball hitch (in conjunction with trailer coupling only)	400.00	5
125 024	Agile automated 6-speed manual transmission	1,690.00	20
700 054	Bi-xenon headlights with cleaning system + additional high-beam headlights, direction indicators with LED side light array (in conjunction with rear axle air suspension only)	1,490.00	5
125 060	Differential lock for rear axle	850.00	15
703 5091	Elegant wood grain finish for dashboard	495.00	2
700 079	Carver jacks with automatic levelling	6,500.00	70
125 065	Air suspension on rear axle with "raise + lower" function	4,400.00	25
702 230	Wheel trims	360.00	8

Coachwork

700 2431	"Security Plus" door upgrade with combination lock	990.00	10
700 381	Luxury outside mirror with wide-angle section	500.00	8
700 385	Kerb mirror on co-driver's side	110.00	3
700 245	Fly screen for main door	390.00	5
701 584	Garage door 1250 x 800 mm (driver's side) instead of standard flap	360.00	8



SPECIAL OPTIONS - COACHWORK

Coachwork

		PRICE IN EUROS incl. 19 % VAT	EXTRA WEIGHT in kg
700 094	Silver-coloured awning - 4.0 m (for model 642)	900.00	27
700 095	Silver-coloured awning - 4.5 m (for models 692 and 742)	1,050.00	36
700 089	Electric motor for awning, mounted on the right-hand side	450.00	4

Living area / Bedroom

701 506	Pulldown bed instead of the wall cupboards	890.00	50
700 754	Midi roof hatch with lighting in the bedroom instead of the standard roof hatch	590.00	6
701 5471	Lowerable table with seat cushion	450.00	8

Kitchen

700 44.	Corisan kitchen worktop with seamlessly integrated sink	990.00	8
700 8081	175 l refrigerator with silver-coloured door frame instead of 97 l standard refrigerator (models 692H and 742L only)	890.00	26
700 8091	175 l refrigerator / oven combination instead of 97 l standard refrigerator (for models 692H and 742L only)	1,790.00	42

Water / Gas / Heating / Bathroom

700 412	Outside shower in the garage (driver's side)	275.00	2
700 862	"Motor Caravan" heating system with convenient continuous heating function (5.2 kW) and time switch	2,590.00	10
700 898	Gas alarm for living area	360.00	2
700 830	2.1 kW air conditioner for living area with 1.2 kW heating element (mounted on the roof, overall vehicle height 3300 mm)	1,890.00	34
701 811	SOG toilet roof vent	299.00	1
701 800	Additional toilet tank with storage unit	200.00	5

Electrical equipment

700 740	Electrical power package 1 Additional 150 Ah gel battery (making a total of 2) with 45 A charger instead of 25 A charger, power inverter from 12 V to 230 V, 1500 W sine-wave with remote control and automatic mains priority circuit	1,555.00	55
701 200	Alarm system	1,150.00	3
700 684	Double reversing camera with shutter and 7" display	1,495.00	4

SPECIAL OPTIONS - COACHWORK

Electrical equipment

		PRICE IN EUROS incl. 19 % VAT	EXTRA WEIGHT in kg
700 706	Additional 150 Ah gel battery (making a total of 2, not in conjunction with Electrical power package 1)	450.00	45
700 705	Additional 150 Ah gel battery (making a total of 2) + 45 A charger (not in conjunction with Electrical power package 1)	790.00	50
700 720	Solar unit with approx. 120 W maximum power	1,490.00	15
700 483	Power inverter from 12 V to 230 V, 1500 W sine-wave with remote control and automatic mains priority circuit	1,190.00	8

TV / Radio / Telephone

700 6902	Digital satellite receiving system with 85 cm dish, fully automatic orientation, digital receiver with 2 CI slots for encrypted programmes, multi-party capability thanks to TWIN LNB, connection for second receiver with 12 V/230 V and antenna socket in the bedroom, audio playback facility via radio (overall vehicle height approx. 3300 mm)	3,690.00	25
700 610	Radio with CD and MP3 player, with Bluetooth and hands-free talking facility for the telephone (instead of standard radio)	320.00	0
700 670	Roof-mounted telephone antenna for D and E networks (specify cable end)	250.00	1
700 6993	20" flat panel display (in the living area)	1,190.00	13
700 699	20" flat panel display (in the bedroom, not for H-models)	1,190.00	20
700 69021	Additional digital satellite receiver for the bedroom	290.00	3

Furnishings, fabrics and leather upholstery

01	Soft-look leather upholstery in the living area, including cab seats - Mint Green	2,700.00	25
02	Soft-look leather upholstery in the living area, including cab seats - Caramel	2,700.00	25
03	Soft-look leather upholstery in the living area, including cab seats - Sandstone	2,700.00	25
04	Soft-look leather upholstery in the living area, including cab seats - Dove Blue	2,700.00	25
41	Soft-look microfibre upholstery in the living area, including cab seats - Mint Green	0.00	0
42	Soft-look microfibre upholstery in the living area, including cab seats - Caramel	0.00	0
43	Soft-look microfibre upholstery in the living area, including cab seats - Sandstone	Standard	0
44	Soft-look microfibre upholstery in the living area, including cab seats - Dove Blue	0.00	0

Miscellaneous

800 000	Delivery (with comprehensive instruction, handover inspection and approx. 80 l diesel)	650.00	-
---------	---	--------	---

¹ The kerb weight includes: driver (75 kg), full fuel and freshwater tanks, gas, tools and spare wheel. Weights and dimensions may vary according to special options and accessories. All measurements and weights reflect the specifications at the time of going to press. Deviations by +/- 5 % are possible and permitted.

CHASSIS AND SECTIONAL DRAWING

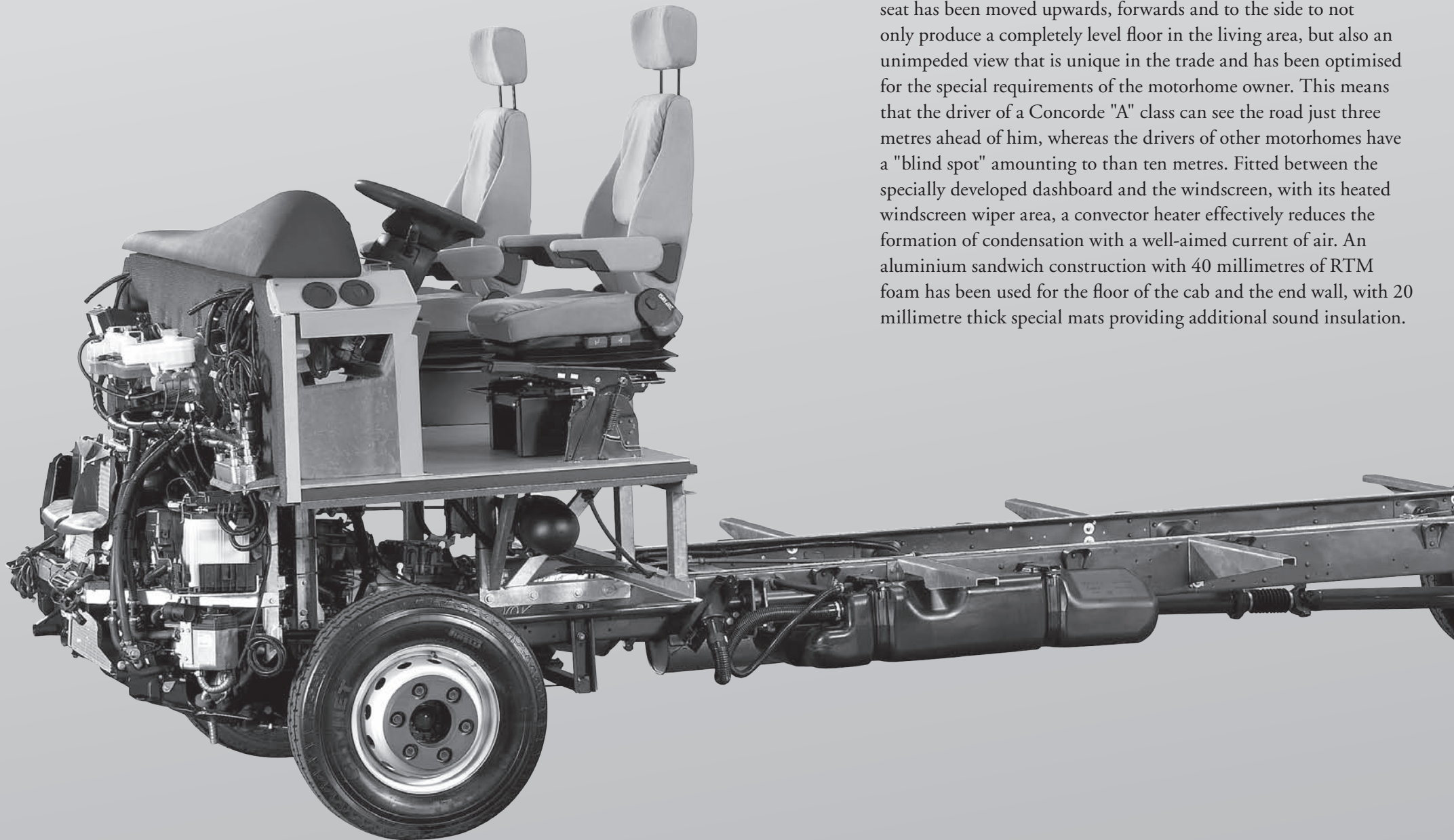

THE CHASSIS OF THE CONCORDE CARVER

Concorde plays a pioneering role in the motorcaravan industry once again when it comes to the chassis: the position of the driver's seat has been moved upwards, forwards and to the side to not only produce a completely level floor in the living area, but also an unimpeded view that is unique in the trade and has been optimised for the special requirements of the motorhome owner. This means that the driver of a Concorde "A" class can see the road just three metres ahead of him, whereas the drivers of other motorhomes have a "blind spot" amounting to than ten metres. Fitted between the specially developed dashboard and the windscreen, with its heated windscreen wiper area, a convector heater effectively reduces the formation of condensation with a well-aimed current of air. An aluminium sandwich construction with 40 millimetres of RTM foam has been used for the floor of the cab and the end wall, with 20 millimetre thick special mats providing additional sound insulation.

THE CABIN CONSTRUCTION OF THE CONCORDE CARVER

As far as motorhome building is concerned, the name Concorde is regarded as being a synonym for perfect insulation and outstanding stability. This is primarily due to the fully bonded Solidtherm® cabin construction with high-density solid PU profiles to eliminate cold spots and the side wall insulation with a 40 millimetre layer of RTM foam. As if that were not enough: sandwich constructions are also used for the floor and intermediate panels, with insulation layers adding up to a total of 70 millimetres, contributing to the as yet unparalleled insulation values achieved by Concorde. Furthermore, the side skirts, the bumpers and the front and rear sections are made of rugged but flexible GRP material. The completely smooth, high gloss, aluminium sandwich wall panels create an automobile impression and aluminium roof profile sections with rain channels reduce soiling of the side walls to ensure that the attractive appearance is maintained over the years.

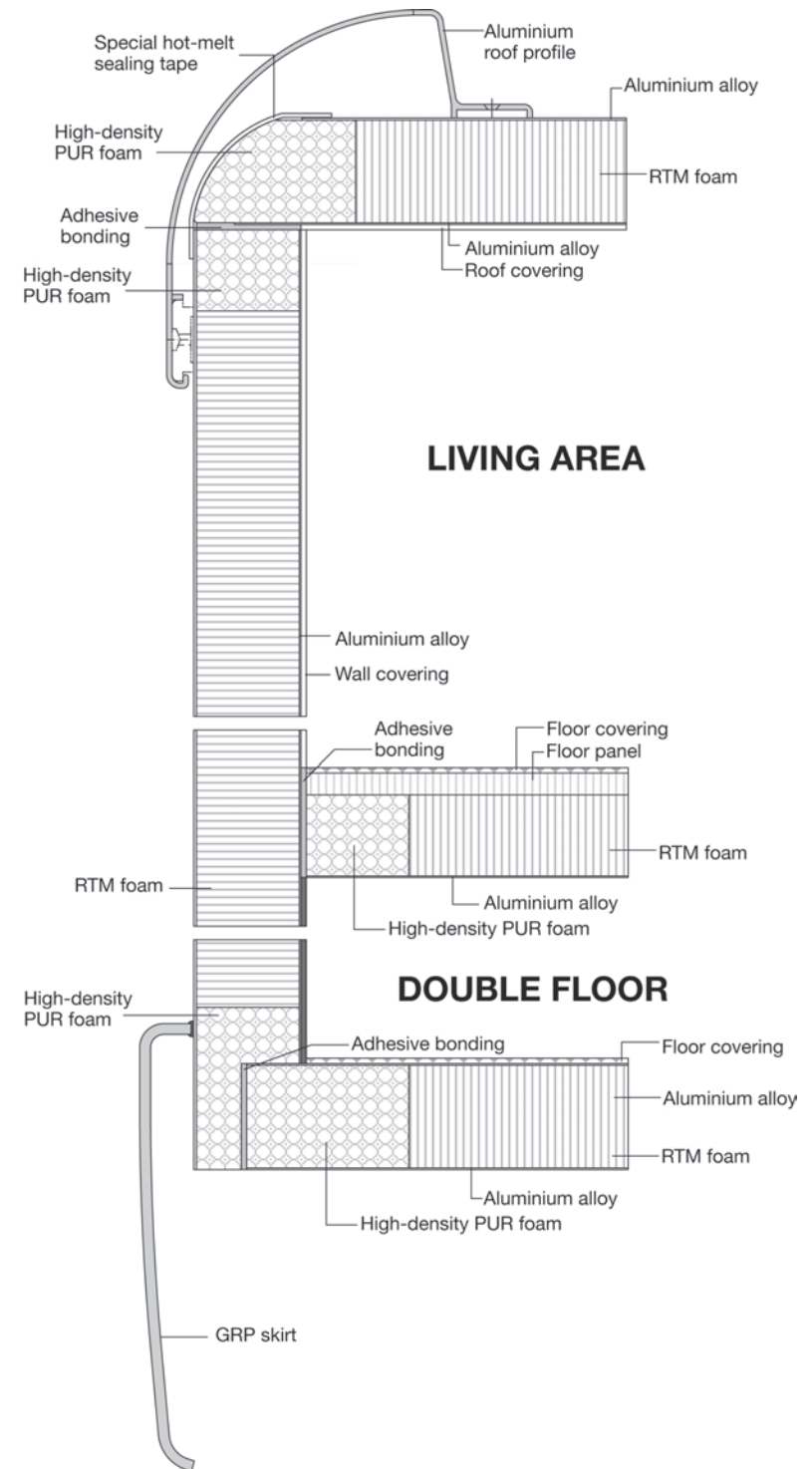
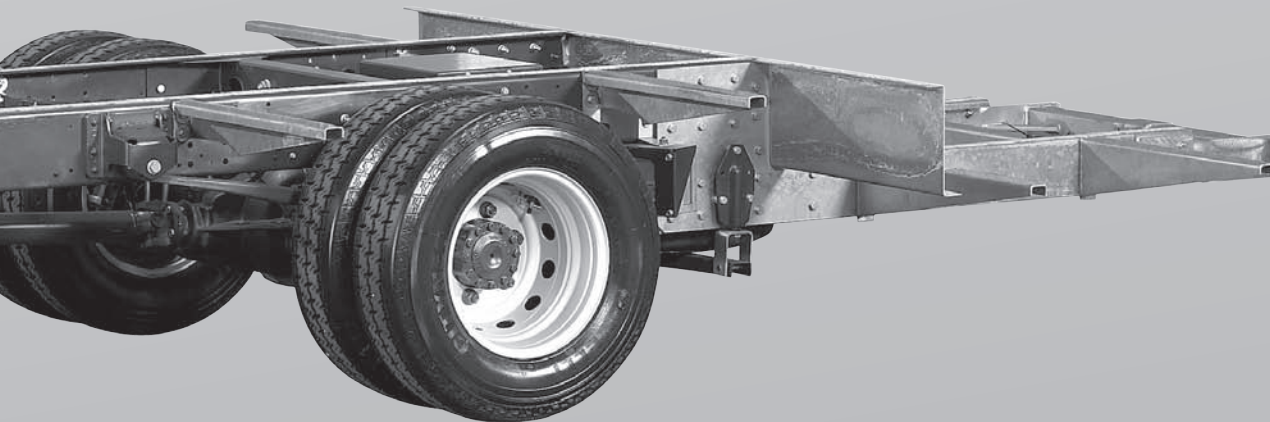

The prices for vehicles and special options apply to vehicles purchased and registered in Germany and are quoted in euros including 19 % value-added tax. Concorde reserves the right to adjust the quoted prices in the event of an increase in value-added tax between order and delivery. All prices are recommended retail prices ex works. If the vehicle manufacturers change their prices, this will necessitate a corresponding adjustment to the price of the finished vehicle. The prices for special options only apply where these are installed in the factory, assuming that adequate notice has been given. Retrospective installation work incurs additional costs for materials and labour. The quoted prices include the ancillary expenses for delivery of the chassis and acceptance by the German Technical Inspectorate (TÜV). Concorde reserves the right to implement technical modifications as long as the quality of the product remains the same or is improved, and the intended purpose is not adversely affected. This price list supersedes all previous price lists.

Concorde

REISEMOBILE AUS LEIDENSCHAFT

Concorde Reisemobile GmbH
Concorde-Strasse 2-4, 96132 Schlüsselfeld-Aschbach, Germany
Phone ++49(0) 95 55 / 92 25-0 - Fax ++49(0) 95 55 / 92 25-44
Web site: www.concorde.eu
eMail: info@concorde.eu