

Price List 2-2008



***Concorde***

REISEMOBILE AUS LEIDENSCHAFT

# STANDARD SPECIFICATION

## Chassis

|   | IVECO<br>DAILY | IVECO<br>EUROCARGO | MAN<br>TGL |
|---|----------------|--------------------|------------|
| Turbocharged diesel engine with electronically controlled Common Rail direct injection  | •              | •                  | •          |
| Compliance with Euro 4 emissions standard by means of SCR technology (AdBlue)   | –              | •                  | –          |
| Compliance with Euro 4 emissions standard by means of particle filter   | •              | –                  | •          |
| 6-speed manual transmission with dashboard gear shift   | •              | •                  | •          |
| 6-speed manual transmission with 210 engine, 9-speed with 240 engine  | –              | –                  | •          |
| Rear-wheel drive with ASR traction control system   | •              | –                  | •          |
| Rear axle with comfortable parabolic springs, air suspension available as an option   | •              | •                  | •          |
| 225/75 R 16 tyres, twin rear wheels   | •              | –                  | –          |
| Twin wheels with 225/75 R 17,5 tyres, rear wheels with all-seasons tyres (M+S)  | –              | •                  | –          |
| Twin wheels with 235/75 R 17,5 tyres, rear wheels with all-seasons tyres (M+S)  | –              | –                  | •          |
| Dual-circuit air brakes with disc brakes on front and rear axles  | –              | •                  | •          |
| Electronically controlled anti-lock braking system (ABS)  | •              | •                  | •          |
| Engine brake  | –              | •                  | •          |
| Exhaust valve brake system (EVB)  | –              | –                  | •          |
| Cruise control system   | •              | •                  | •          |
| Alternator 14 V, 140 A (1960 watt)  | •              | –                  | –          |
| Alternator 28 V, 70 A (1960 watt)   | –              | •                  | –          |
| Alternator 28 V, 80 A (2240 watt)   | –              | –                  | •          |
| Additional alternator 14 V 80 A (1120 watt) to charge on-board leisure batteries while driving                                | –              | •                  | •          |
| Fuel tank - 100 l   | •              | –                  | –          |
| Fuel tank - 180 l   | –              | •                  | •          |
| Cab air-conditioning system   | •              | •                  | •          |
| Tinted cab windows  | •              | •                  | •          |
| Electrically adjustable, heated door mirrors with wide-angle section  | •              | •                  | •          |
| Electric door window lifter on both driver's and passenger's side   | •              | •                  | •          |
| Front fog lights  | •              | •                  | •          |
| Cab seats covered in original material, passenger's seat adjustable in 2 positions  | •              | –                  | –          |
| Heated driver's and passenger's seat with air suspension and lumbar support, covered in original material (MAN with armrests) | –              | •                  | •          |
| Radio / CD / MP3 with speakers in the cab and living area, speaker balance control  | •              | •                  | •          |
| Adjustable steering wheel   | –              | •                  | •          |
| Warning triangle and first-aid kit, warning lamp and two wheel chocks   | •              | •                  | •          |

## Coachwork

|  | <b>CRUISER</b> |
|--|----------------|
| Rugged, long-life Solidtherm aluminium sandwich construction   | •              |
| "Faraday cage" lightning protection  | •              |
| Fully insulated wall joining technique using high-density solid PU profiles to eliminate cold spots  | •              |
| Walls 42 mm thick with 40 mm closed-cell, high-resistance RTM foam   | •              |
| Chromated aluminium alloy external and internal wall, roof and underbody panels  | •              |
| Smooth outer panels with white baked enamel finish   | •              |
| Walk-on roof   | •              |
| Aluminium roof profile sections  | •              |
| Side skirts made of strong but flexible, corrosion-free GRP material   | •              |
| GRP sandwich rear wall construction (approx. 45 mm thick) with PU foam core  | •              |
| Separate GRP rear bumper for easy replacement  | •              |
| Heated double floor construction, intrafloor space approx. 350 mm high, accessible via outside flaps   | •              |
| Luggage locker doors with flush, aerodynamic cast aluminium hinges   | •              |
| Sandwich-type floor and intermediate panel construction with 40 mm and 30 mm RTM foam insulation respectively, adding up to a total of 70 mm | •              |
| Rugged GRP wheel arches with fully insulated sandwich construction   | •              |
| Illuminated rear garage with doors on both sides, luggage tie-down system and 230 V socket-outlet  | •              |
| Illuminated, heated double step inside the door  | •              |
| Electrically retractable step outside the door with safety circuit   | •              |
| "Security Plus" door with combination security lock and key-operated emergency override switch   | •              |
| Double-glazed, tinted tilting/sliding plastic windows with PU frames in the living area with integrated blind and fly screen                 | •              |
| Exterior light with safety circuit (switches off automatically when the engine is started)   | •              |
| Aluminium roof rails with cross bars, rear ladder and ladder extension in white lacquer finish   | •              |
| "Cruiser" decals in blue and silver  | •              |

# STANDARD SPECIFICATION

## Living area / Bedroom

|  | CRUISER |
|--|---------|
| Walls and ceiling covered in colour-coordinated carpet   | •       |
| Easy-clean plastic floor covering  | •       |
| Removable quality carpets  | •       |
| Ergonomic, Diolen-upholstered seating elements with seat belts and zip-off covers  | •       |
| Sandstone microfibre covers in the living area   | •       |
| Lengthwise bench seat can be combined with seating elements to produce a larger seating arrangement (including the table extension with the dinette) | •       |
| High-quality furnishings with laminate or veneer construction  | •       |
| Furniture flaps and doors with real wood veneer on both sides, with metal hinges and catches   | •       |
| Wardrobe with clothes rail, mirror on the inside of the door and lighting  | •       |
| Rear bed with Lattoflex supportive spring system, adjustable headrest and Carawinx mattress  | •       |
| Insulated sliding door leading to the cab, may be locked from the living area  | •       |
| Double-glazed panoramic roof hatch with integrated lighting, blind and fly screen  | •       |
| Roof hatch with integrated blind and fly screen  | •       |
| Sturdy laminated table with wood grain finish  | •       |
| Fabric curtains at the windows in the living area and bedroom  | •       |
| TV cabinet near the door with 12 V and 230 V socket-outlets  | •       |
| Glass-fronted cocktail cabinet with shelves and assorted glasses   | •       |
| Lighting canopies with halogen spotlights and integrated lighting  | •       |
| Glass-fronted cabinets with LED lighting   | •       |
| Sturdy, solid-wood handle inside the door  | •       |
| 12 V and 230 V socket-outlets throughout living area and bedroom   | •       |

## Overcab area

|   |   |
|---|---|
| Bed with Lattoflex supportive spring system and Carawinx mattress                             | • |
| Shelves with halogen spotlights on both sides and 12 V / 230 V socket-outlet on driver's side | • |
| Two double-glazed opening windows with blinds   | • |
| Roof hatch with integrated blind and fly screen   | • |
| Ladder  | • |
| Curtain to separate the overcab bedroom from the living area                                  | • |
| Safety net with straps and bayonet fasteners  | • |

## Kitchen

|  | <b>CRUISER</b> |
|--|----------------|
| Flush-fitted three-flame stainless steel gas hob with automatic ignition   | •              |
| Flush-fitted stainless steel sink  | •              |
| Level glass covers for hob and sink  | •              |
| Chrome railing in front of the hob   | •              |
| Single-lever chrome sink mixer with retractable handspray  | •              |
| Worktop and wall in the kitchen area with hard-wearing laminate finish   | •              |
| 142 l refrigerator with separate freezer compartment, interior lighting and AES (manual/automatic three-way energy changeover switch - 12 V / 230 V / gas) | •              |
| 230 V socket-outlet in the cupboard above the refrigerator   | •              |
| Generously dimensioned cupboards with removable shelving   | •              |
| Easy slide with "cushion close" function   | •              |
| Cutlery drawer   | •              |
| Thermostatically controlled roof fan   | •              |
| Lighting with halogen spotlights in the light canopy and under the wall cupboards  | •              |
| Double waste bin   | •              |
| 3 x 230 V socket-outlets   | •              |

## Bathroom / Toilet

|  |   |
|--|---|
| Bathroom designed to match the living area, wood-panelled walls  | • |
| Bathroom cabinet with mirror and shelf   | • |
| Open shelving with chrome railings   | • |
| Lighting with designer light fittings and halogen spotlights   | • |
| Corisan washstand with seamlessly integrated washbasin   | • |
| Single-lever chrome mixer with extendable shower attachment on the washstand                             | • |
| Generously sized shower cubicle with acrylic glass door  | • |
| Shower mixer with wall rail and shower head with height adjustment facility                              | • |
| Integrated water-flush toilet with spare cassette and cassette storage unit                              | • |
| Toilet paper holder, liquid soap dispenser, towel rail and hooks   | • |
| Toilet window (models with Premium bathroom only)  | • |
| Roof hatch with integrated fly screen and blind  | • |
| 2 x 230 V socket-outlets   | • |
| Spacious wardrobe with mirror on the inside of the door and lighting (models with Premium bathroom only) | • |

# STANDARD SPECIFICATION

## Water / Gas / Heating

|   | CRUISER |
|---|---------|
| Gas compartment capable of accommodating 2 x 11 kg gas bottles, 30 mb gas pressure  | •       |
| Cut-off valves for all appliances   | •       |
| Gas regulator with state-of-the-art automatic bottle changeover system with "use while driving" technology  | •       |
| Freshwater and wastewater tanks fitted in the heated intrafloor area, each approx. 250 l  | •       |
| Easy access wastewater drain valve in the heated intrafloor area  | •       |
| Access to both tanks from living area for easy cleaning   | •       |
| Direct drainage facility for the freshwater tank using the valve in the heated intrafloor area  | •       |
| Wastewater drain hose with bayonet connection   | •       |
| Automatically operating central water pump with surge tank  | •       |
| 5500 W engine-independent gas-fired central heating / hot-water system with thermostatic control and time switch,<br>230 V / 3000 W electric heater, automatic vent valve, non-return valve | •       |
| Integrated hot-water boiler to supply all taps  | •       |
| Heat exchanger that uses the heat produced by the engine to heat the living area  | •       |
| Service access via separate outside flap  | •       |

## Electricity / TV / Radio

|  |   |
|--|---|
| 150 AH gel battery in the intrafloor area  | • |
| 230 V CEE connection in the luggage compartment with cable routing through the intrafloor area   | • |
| Central control and distribution module with microprocessor technology   | • |
| Automatic battery charging facility with electronic control and battery temperature sensor, 25 A maximum charging current                  | • |
| Automatic charging of leisure and vehicle batteries when connected up to an external power supply and while driving                        | • |
| Automatic connection and disconnection of leisure and vehicle batteries  | • |
| Automatic refrigerator cut-off in 12 V mode when the engine is switched off  | • |
| Deactivation of on-board electrical system when voltage too low or in the event of overheating, with automatic reactivation                | • |
| Automatic residual-current-operated circuit breaker  | • |
| 300 W sine-wave power inverter (230 V to all socket-outlets – even when not connected to external power supply) and mains priority circuit | • |
| 230 V socket-outlet in the garage  | • |

## On-board electronics

|  | <b>CRUISER</b> |
|--|----------------|
| Ultra-modern microprocessor-controlled on-board electronic system with BUS technology (Binary Unit System) | •              |
| Central control and monitoring panel   | •              |
| Master switch for all items of equipment   | •              |
| Pushbuttons to switch the following systems on and off:  |                |
| • Heating  | •              |
| • Anti-freeze system for the gas pressure regulator  | •              |
| • Gas valve (in conjunction with gas tank only)  | •              |
| • Lighting   | •              |
| • Water pump   | •              |
| • Power inverter   | •              |
| LCD indicator panel for monitoring of:   |                |
| • Freshwater tank  | •              |
| • Wastewater tank  | •              |
| • Voltage of the leisure and vehicle batteries   | •              |
| • Outside and inside temperatures  | •              |
| • Charging and discharging current   | •              |
| • External power supply  | •              |
| • Gas level (in conjunction with gas tank only)  | •              |
| • Batteries connected in parallel  | •              |
| • Date and time with alarm clock function  | •              |
| Alarm facilities for:  |                |
| • Wastewater tank full   | •              |
| • Freshwater tank empty  | •              |
| • Low battery voltage  | •              |
| • Reserve gas bottle in use  | •              |
| • Step extended  | •              |

# TECHNICAL DATA

## Cruiser 791 H with Divided bathroom

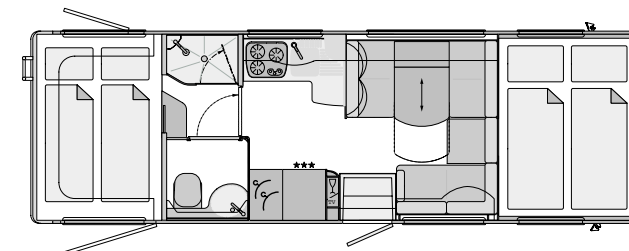

|  |                   |                   |                   |                   |                   |                   |
|--|-------------------|-------------------|-------------------|-------------------|-------------------|-------------------|
| Basic vehicle  | Iveco Daily       | Iveco Daily       | Iveco Eurocargo   | Iveco Eurocargo   | MAN TGL           | MAN TGL           |
| Chassis  | 60C18             | 65C18             | 75E18             | 80E22             | 8.210             | 8.240             |
| Engine   | 4-cylinder        | 4-cylinder        | 4-cylinder        | 6-cylinder        | 4-cylinder        | 6-cylinder        |
| Cubic capacity   | 3,0 l             | 3,0 l             | 3,9 l             | 5,9 l             | 4,6 l             | 6,9 l             |
| Power  | 130 kW (177 HP)   | 130 kW (177 HP)   | 130 kW (177 HP)   | 160 kW (217 HP)   | 151 kW (206 HP)   | 177 kW (240 HP)   |
| Torque   | 400 Nm            | 400 Nm            | 570 Nm            | 680 Nm            | 830 Nm            | 925 Nm            |
| Overall length (mm)  | 8470              | 8470              | 7830              | 7830              | 7830              | 7830              |
| Overall width (mm)   | 2380              | 2380              | 2490              | 2490              | 2490              | 2490              |
| Overall height (mm)  | 3420              | 3420              | 3570              | 3600              | 3600              | 3600              |
| Wheelbase (mm)   | 4750              | 4750              | 3900              | 3900              | 3900              | 3900              |
| Maximum permissible weight / Chassis downgrade <sup>1</sup> (kg) | 6000              | 6700              | 7490              | 8600              | 8800/7490         | 8800              |
| Kerb weight <sup>2</sup> (kg)                                    | 4950              | 4950              | 6000              | 6460              | 6340              | 6730              |
| Payload / Chassis downgrade <sup>2</sup> (kg)                    | 1050              | 1750              | 1490              | 2140              | 2460/1150         | 2070              |
| Trailer load in kg   | 3500              | 3500              | 3500              | 3500              | 3500              | 3500              |
| Seats with three-point safety belts                              | 4                 | 4                 | 4                 | 4                 | 4                 | 4                 |
| Left-hand seating element (mm)                                   | 1910/980          | 1910/980          | 1910/980          | 1910/980          | 1910/980          | 1910/980          |
| Right-hand bench seat (mm)                                       | 1270/640          | 1270/640          | 1270/640          | 1270/640          | 1270/640          | 1270/640          |
| Rear bed (mm)  | 2100/1500         | 2100/1500         | 2100/1500         | 2100/1500         | 2100/1500         | 2100/1500         |
| Size of overcab area (mm)  | 2230/1580         | 2230/1580         | 2340/1680         | 2340/1680         | 2340/1680         | 2340/1680         |
| Overcab bed dimensions (mm)                                      | 2100/1450         | 2100/1450         | 2100/1550         | 2100/1550         | 2100/1550         | 2100/1550         |
| Headroom above overcab bed mattress (mm)                         | 700               | 700               | 700               | 700               | 700               | 700               |
| Right-hand garage door H/W (mm)                                  | 1250/1150         | 1250/1150         | 1250/1150         | 1250/1150         | 1250/1150         | 1250/1150         |
| Left-hand garage door H/W (mm)                                   | 1250/800          | 1250/800          | 1250/800          | 1250/800          | 1250/800          | 1250/800          |
| <b>Price in euros (including 19 % VAT)</b>                       | <b>121,000.00</b> | <b>122,000.00</b> | <b>135,000.00</b> | <b>139,000.00</b> | <b>147,000.00</b> | <b>152,000.00</b> |



## Cruiser 841 L with Divided bathroom

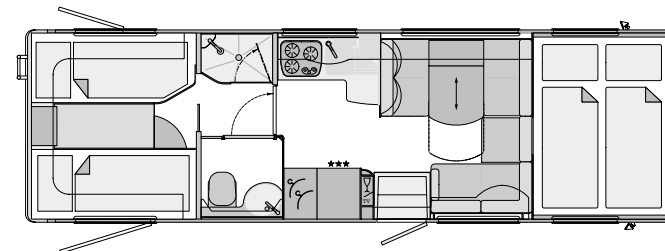

| Basic vehicle  | Iveco Daily       | Iveco Daily       | Iveco Eurocargo   | Iveco Eurocargo   | MAN TGL           | MAN TGL           |
|--|-------------------|-------------------|-------------------|-------------------|-------------------|-------------------|
| Chassis  | 60C18             | 65C18             | 75E18             | 80E22             | 8.210             | 8.240             |
| Engine   | 4-cylinder        | 4-cylinder        | 4-cylinder        | 6-cylinder        | 4-cylinder        | 6-cylinder        |
| Cubic capacity   | 3,0 l             | 3,0 l             | 3,9 l             | 5,9 l             | 4,6 l             | 6,9 l             |
| Power  | 130 kW (177 HP)   | 130 kW (177 HP)   | 130 kW (177 HP)   | 160 kW (217 HP)   | 151 kW (206 HP)   | 177 kW (240 HP)   |
| Torque   | 400 Nm            | 400 Nm            | 570 Nm            | 680 Nm            | 830 Nm            | 925 Nm            |
| Overall length (mm)  | 8970              | 8970              | 8330              | 8330              | 8330              | 8330              |
| Overall width (mm)   | 2380              | 2380              | 2490              | 2490              | 2490              | 2490              |
| Overall height (mm)  | 3420              | 3420              | 3570              | 3600              | 3600              | 3600              |
| Wheelbase (mm)   | 4900              | 4900              | 4185              | 4185              | 4200              | 4200              |
| Maximum permissible weight / Chassis downgrade <sup>1</sup> (kg) | 6000              | 6700              | 7490              | 8600              | 8800/7490         | 8800              |
| Kerb weight <sup>2</sup> (kg)                                    | 5100              | 5100              | 6150              | 6610              | 6490              | 6880              |
| Payload / Chassis downgrade <sup>2</sup> (kg)                    | 900               | 1600              | 1340              | 1990              | 2310/1000         | 1920              |
| Trailer load in kg   | 3500              | 3500              | 3500              | 3500              | 3500              | 3500              |
| Seats with three-point safety belts                              | 4                 | 4                 | 4                 | 4                 | 4                 | 4                 |
| Left-hand seating element (mm)                                   | 1910/980          | 1910/980          | 1910/980          | 1910/980          | 1910/980          | 1910/980          |
| Right-hand bench seat (mm)                                       | 1270/640          | 1270/640          | 1270/640          | 1270/640          | 1270/640          | 1270/640          |
| Rear bed (mm)  | 2 x 2000/850      | 2 x 2000/850      | 2 x 2000/850      | 2 x 2000/850      | 2 x 2000/850      | 2 x 2000/850      |
| Size of overcab area (mm)  | 2230/1580         | 2230/1580         | 2340/1680         | 2340/1680         | 2340/1680         | 2340/1680         |
| Overcab bed dimensions (mm)                                      | 2100/1450         | 2100/1450         | 2100/1550         | 2100/1550         | 2100/1550         | 2100/1550         |
| Headroom above overcab bed mattress (mm)                         | 700               | 700               | 700               | 700               | 700               | 700               |
| Right-hand garage door H/W (mm)                                  | 1250/1150         | 1250/1150         | 1250/1150         | 1250/1150         | 1250/1150         | 1250/1150         |
| Left-hand garage door H/W (mm)                                   | 1250/800          | 1250/800          | 1250/800          | 1250/800          | 1250/800          | 1250/800          |
| <b>Price in euros (including 19 % VAT)</b>                       | <b>124,000.00</b> | <b>125,000.00</b> | <b>138,000.00</b> | <b>142,000.00</b> | <b>150,000.00</b> | <b>155,000.00</b> |

# TECHNICAL DATA

## Cruiser 841 F with Divided bathroom

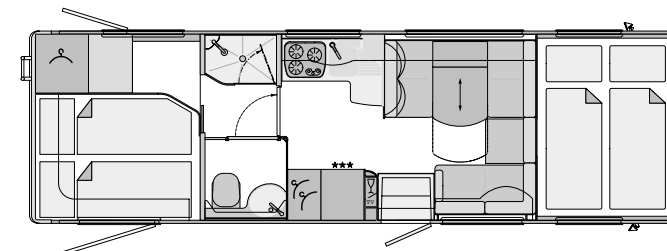

|  |                   |                   |                   |                   |                   |                   |
|--|-------------------|-------------------|-------------------|-------------------|-------------------|-------------------|
| Basic vehicle  | Iveco Daily       | Iveco Daily       | Iveco Eurocargo   | Iveco Eurocargo   | MAN TGL           | MAN TGL           |
| Chassis  | 60C18             | 65C18             | 75E18             | 80E22             | 8.210             | 8.240             |
| Engine   | 4-cylinder        | 4-cylinder        | 4-cylinder        | 6-cylinder        | 4-cylinder        | 6-cylinder        |
| Cubic capacity   | 3,0 l             | 3,0 l             | 3,9 l             | 5,9 l             | 4,6 l             | 6,9 l             |
| Power  | 130 kW (177 HP)   | 130 kW (177 HP)   | 130 kW (177 HP)   | 160 kW (217 HP)   | 151 kW (206 HP)   | 177 kW (240 HP)   |
| Torque   | 400 Nm            | 400 Nm            | 570 Nm            | 680 Nm            | 830 Nm            | 925 Nm            |
| Overall length (mm)  | 8970              | 8970              | 8330              | 8330              | 8330              | 8330              |
| Overall width (mm)   | 2380              | 2380              | 2490              | 2490              | 2490              | 2490              |
| Overall height (mm)  | 3420              | 3420              | 3570              | 3600              | 3600              | 3600              |
| Wheelbase (mm)   | 4900              | 4900              | 4185              | 4185              | 4200              | 4200              |
| Maximum permissible weight / Chassis downgrade <sup>1</sup> (kg) | 6000              | 6700              | 7490              | 8600              | 8800/7490         | 8800              |
| Kerb weight <sup>2</sup> (kg)                                    | 5100              | 5100              | 6150              | 6610              | 6490              | 6880              |
| Payload / Chassis downgrade <sup>2</sup> (kg)                    | 900               | 1600              | 1340              | 1990              | 2310/1000         | 1920              |
| Trailer load in kg   | 3500              | 3500              | 3500              | 3500              | 3500              | 3500              |
| Seats with three-point safety belts                              | 4                 | 4                 | 4                 | 4                 | 4                 | 4                 |
| Left-hand seating element (mm)                                   | 1910/980          | 1910/980          | 1910/980          | 1910/980          | 1910/980          | 1910/980          |
| Right-hand bench seat (mm)                                       | 1270/640          | 1270/640          | 1270/640          | 1270/640          | 1270/640          | 1270/640          |
| Rear bed (mm)  | 2000/1550         | 2000/1550         | 2000/1550         | 2000/1550         | 2000/1550         | 2000/1550         |
| Size of overcab area (mm)  | 2230/1580         | 2230/1580         | 2340/1680         | 2340/1680         | 2340/1680         | 2340/1680         |
| Overcab bed dimensions (mm)                                      | 2100/1450         | 2100/1450         | 2100/1550         | 2100/1550         | 2100/1550         | 2100/1550         |
| Headroom above overcab bed mattress (mm)                         | 700               | 700               | 700               | 700               | 700               | 700               |
| Right-hand garage door H/W (mm)                                  | 1250/1150         | 1250/1150         | 1250/1150         | 1250/1150         | 1250/1150         | 1250/1150         |
| Left-hand garage door H/W (mm)                                   | 1250/800          | 1250/800          | 1250/800          | 1250/800          | 1250/800          | 1250/800          |
| <b>Price in euros (including 19 % VAT)</b>                       | <b>124,000.00</b> | <b>125,000.00</b> | <b>138,000.00</b> | <b>142,000.00</b> | <b>150,000.00</b> | <b>155,000.00</b> |

## Cruiser 891 M with Divided bathroom

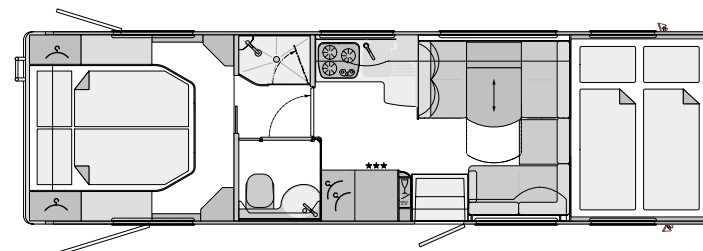

|  |                   |                   |                   |                   |                   |                   |
|--|-------------------|-------------------|-------------------|-------------------|-------------------|-------------------|
| Basic vehicle  | Iveco Daily       | Iveco Daily       | Iveco Eurocargo   | Iveco Eurocargo   | MAN TGL           | MAN TGL           |
| Chassis  | 60C18             | 65C18             | 75E18             | 80E22             | 8.210             | 8.240             |
| Engine   | 4-cylinder        | 4-cylinder        | 4-cylinder        | 6-cylinder        | 4-cylinder        | 6-cylinder        |
| Cubic capacity   | 3,0 l             | 3,0 l             | 3,9 l             | 5,9 l             | 4,6 l             | 6,9 l             |
| Power  | 130 kW (177 HP)   | 130 kW (177 HP)   | 130 kW (177 HP)   | 160 kW (217 HP)   | 151 kW (206 HP)   | 177 kW (240 HP)   |
| Torque   | 400 Nm            | 400 Nm            | 570 Nm            | 680 Nm            | 830 Nm            | 925 Nm            |
| Overall length (mm)  | 9470              | 9470              | 8830              | 8830              | 8830              | 8830              |
| Overall width (mm)   | 2380              | 2380              | 2490              | 2490              | 2490              | 2490              |
| Overall height (mm)  | 3420              | 3420              | 3570              | 3600              | 3600              | 3600              |
| Wheelbase (mm)   | 5100              | 5100              | 4455              | 4455              | 4500              | 4500              |
| Maximum permissible weight / Chassis downgrade <sup>1</sup> (kg) | 6000              | 6700              | 7490              | 8600              | 8800/7490         | 8800              |
| Kerb weight <sup>2</sup> (kg)                                    | 5270              | 5270              | 6320              | 6780              | 6660              | 7050              |
| Payload / Chassis downgrade <sup>2</sup> (kg)                    | 730               | 1430              | 1170              | 1820              | 2140/830          | 1750              |
| Trailer load in kg   | 3500              | 3500              | 3500              | 3500              | 3500              | 3500              |
| Seats with three-point safety belts                              | 4                 | 4                 | 4                 | 4                 | 4                 | 4                 |
| Left-hand seating element (mm)                                   | 1910/980          | 1910/980          | 1910/980          | 1910/980          | 1910/980          | 1910/980          |
| Right-hand bench seat (mm)                                       | 1270/640          | 1270/640          | 1270/640          | 1270/640          | 1270/640          | 1270/640          |
| Rear bed (mm)  | 2000/1600         | 2000/1600         | 2000/1600         | 2000/1600         | 2000/1600         | 2000/1600         |
| Size of overcab area (mm)  | 2230/1580         | 2230/1580         | 2340/1680         | 2340/1680         | 2340/1680         | 2340/1680         |
| Overcab bed dimensions (mm)                                      | 2100/1450         | 2100/1450         | 2100/1550         | 2100/1550         | 2100/1550         | 2100/1550         |
| Headroom above overcab bed mattress (mm)                         | 700               | 700               | 700               | 700               | 700               | 700               |
| Right-hand garage door H/W (mm)                                  | 1250/1150         | 1250/1150         | 1250/1150         | 1250/1150         | 1250/1150         | 1250/1150         |
| Left-hand garage door H/W (mm)                                   | 1250/800          | 1250/800          | 1250/800          | 1250/800          | 1250/800          | 1250/800          |
| <b>Price in euros (including 19 % VAT)</b>                       | <b>129,000.00</b> | <b>130,000.00</b> | <b>142,000.00</b> | <b>146,000.00</b> | <b>154,000.00</b> | <b>159,000.00</b> |

# TECHNICAL DATA

## Cruiser 840 H / 840 HR with Premium bathroom

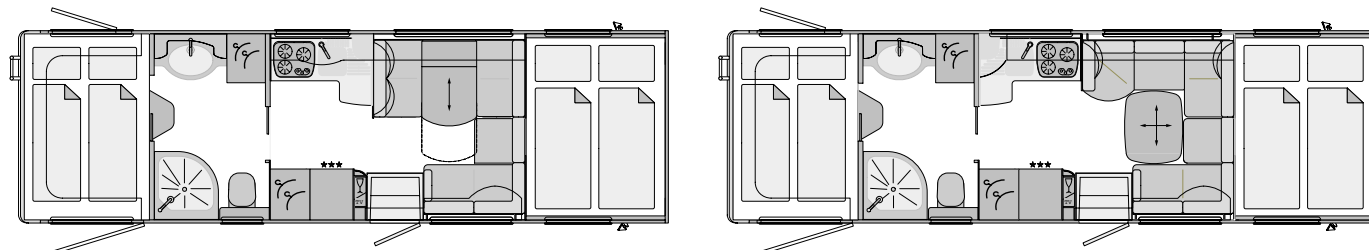

|  |                   |                   |                   |                   |                   |                   |
|--|-------------------|-------------------|-------------------|-------------------|-------------------|-------------------|
| Basic vehicle  | Iveco Daily       | Iveco Daily       | Iveco Eurocargo   | Iveco Eurocargo   | MAN TGL           | MAN TGL           |
| Chassis  | 60C18             | 65C18             | 75E18             | 80E22             | 8.210             | 8.240             |
| Engine   | 4-cylinder        | 4-cylinder        | 4-cylinder        | 6-cylinder        | 4-cylinder        | 6-cylinder        |
| Cubic capacity   | 3,0 l             | 3,0 l             | 3,9 l             | 5,9 l             | 4,6 l             | 6,9 l             |
| Power  | 130 kW (177 HP)   | 130 kW (177 HP)   | 130 kW (177 HP)   | 160 kW (217 HP)   | 151 kW (206 HP)   | 177 kW (240 HP)   |
| Torque   | 400 Nm            | 400 Nm            | 570 Nm            | 680 Nm            | 830 Nm            | 925 Nm            |
| Overall length (mm)  | 8970              | 8970              | 8330              | 8330              | 8330              | 8330              |
| Overall width (mm)   | 2380              | 2380              | 2490              | 2490              | 2490              | 2490              |
| Overall height (mm)  | 3420              | 3420              | 3570              | 3600              | 3600              | 3600              |
| Wheelbase (mm)   | 4900              | 4900              | 4185              | 4185              | 4200              | 4200              |
| Maximum permissible weight / Chassis downgrade <sup>1</sup> (kg) | 6000              | 6700              | 7490              | 8600              | 8800/7490         | 8800              |
| Kerb weight <sup>2</sup> (kg)                                    | 5100              | 5100              | 6150              | 6610              | 6490              | 6880              |
| Payload / Chassis downgrade <sup>2</sup> (kg)                    | 900               | 1600              | 1340              | 1990              | 2310/1000         | 1920              |
| Trailer load in kg   | 3500              | 3500              | 3500              | 3500              | 3500              | 3500              |
| Seats with three-point safety belts H / HR                       | 4/3               | 4/3               | 4/3               | 4/3               | 4/3               | 4/3               |
| Left-hand seating element (mm)                                   | 1910/980          | 1910/980          | 1910/980          | 1910/980          | 1910/980          | 1910/980          |
| Right-hand bench seat (mm)                                       | 1270/640          | 1270/640          | 1270/640          | 1270/640          | 1270/640          | 1270/640          |
| Rear bed (mm)  | 2100/1500         | 2100/1500         | 2100/1500         | 2100/1500         | 2100/1500         | 2100/1500         |
| Size of overcab area (mm)  | 2230/1580         | 2230/1580         | 2340/1680         | 2340/1680         | 2340/1680         | 2340/1680         |
| Overcab bed dimensions (mm)                                      | 2100/1450         | 2100/1450         | 2100/1550         | 2100/1550         | 2100/1550         | 2100/1550         |
| Headroom above overcab bed mattress (mm)                         | 700               | 700               | 700               | 700               | 700               | 700               |
| Right-hand garage door H/W (mm)                                  | 1250/1150         | 1250/1150         | 1250/1150         | 1250/1150         | 1250/1150         | 1250/1150         |
| Left-hand garage door H/W (mm)                                   | 1250/800          | 1250/800          | 1250/800          | 1250/800          | 1250/800          | 1250/800          |
| <b>Price in euros (including 19 % VAT)</b>                       | <b>124,000.00</b> | <b>125,000.00</b> | <b>138,000.00</b> | <b>142,000.00</b> | <b>150,000.00</b> | <b>155,000.00</b> |

## Cruiser 890 L / 890 LR with Premium bathroom

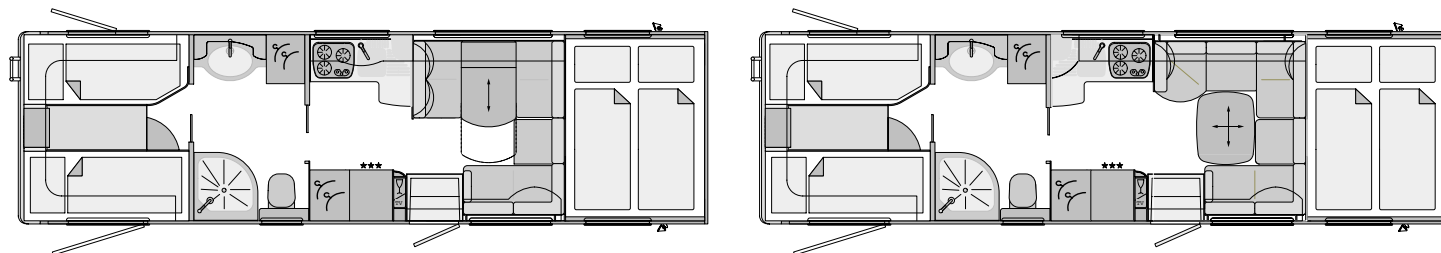

|  |                   |                   |                   |                   |                   |                   |
|--|-------------------|-------------------|-------------------|-------------------|-------------------|-------------------|
| Basic vehicle  | Iveco Daily       | Iveco Daily       | Iveco Eurocargo   | Iveco Eurocargo   | MAN TGL           | MAN TGL           |
| Chassis  | 60C18             | 65C18             | 75E18             | 80E22             | 8.210             | 8.240             |
| Engine   | 4-cylinder        | 4-cylinder        | 4-cylinder        | 6-cylinder        | 4-cylinder        | 6-cylinder        |
| Cubic capacity   | 3,0 l             | 3,0 l             | 3,9 l             | 5,9 l             | 4,6 l             | 6,9 l             |
| Power  | 130 kW (177 HP)   | 130 kW (177 HP)   | 130 kW (177 HP)   | 160 kW (217 HP)   | 151 kW (206 HP)   | 177 kW (240 HP)   |
| Torque   | 400 Nm            | 400 Nm            | 570 Nm            | 680 Nm            | 830 Nm            | 925 Nm            |
| Overall length (mm)  | 9470              | 9470              | 8830              | 8830              | 8830              | 8830              |
| Overall width (mm)   | 2380              | 2380              | 2490              | 2490              | 2490              | 2490              |
| Overall height (mm)  | 3420              | 3420              | 3570              | 3600              | 3600              | 3600              |
| Wheelbase (mm)   | 5100              | 5100              | 4455              | 4455              | 4500              | 4500              |
| Maximum permissible weight / Chassis downgrade <sup>1</sup> (kg) | 6000              | 6700              | 7490              | 8600              | 8800/7490         | 8800              |
| Kerb weight <sup>2</sup> (kg)                                    | 5270              | 5270              | 6320              | 6780              | 6660              | 7050              |
| Payload / Chassis downgrade <sup>2</sup> (kg)                    | 730               | 1430              | 1170              | 1820              | 2140/830          | 1750              |
| Trailer load in kg   | 3500              | 3500              | 3500              | 3500              | 3500              | 3500              |
| Seats with three-point safety belts L/LR                         | 4/3               | 4/3               | 4/3               | 4/3               | 4/3               | 4/3               |
| Left-hand seating element (mm)                                   | 1910/980          | 1910/980          | 1910/980          | 1910/980          | 1910/980          | 1910/980          |
| Right-hand bench seat (mm)                                       | 1270/640          | 1270/640          | 1270/640          | 1270/640          | 1270/640          | 1270/640          |
| Rear bed (mm)  | 2 x 2000/850      | 2 x 2000/850      | 2 x 2000/850      | 2 x 2000/850      | 2 x 2000/850      | 2 x 2000/850      |
| Size of overcab area (mm)  | 2230/1580         | 2230/1580         | 2340/1680         | 2340/1680         | 2340/1680         | 2340/1680         |
| Overcab bed dimensions (mm)                                      | 2100/1450         | 2100/1450         | 2100/1550         | 2100/1550         | 2100/1550         | 2100/1550         |
| Headroom above overcab bed mattress (mm)                         | 700               | 700               | 700               | 700               | 700               | 700               |
| Right-hand garage door H/W (mm)                                  | 1250/1150         | 1250/1150         | 1250/1150         | 1250/1150         | 1250/1150         | 1250/1150         |
| Left-hand garage door H/W (mm)                                   | 1250/800          | 1250/800          | 1250/800          | 1250/800          | 1250/800          | 1250/800          |
| <b>Price in euros (including 19 % VAT)</b>                       | <b>129,000.00</b> | <b>130,000.00</b> | <b>142,000.00</b> | <b>146,000.00</b> | <b>154,000.00</b> | <b>159,000.00</b> |

# TECHNICAL DATA

## Cruiser 890 F / 890 FR with Premium bathroom

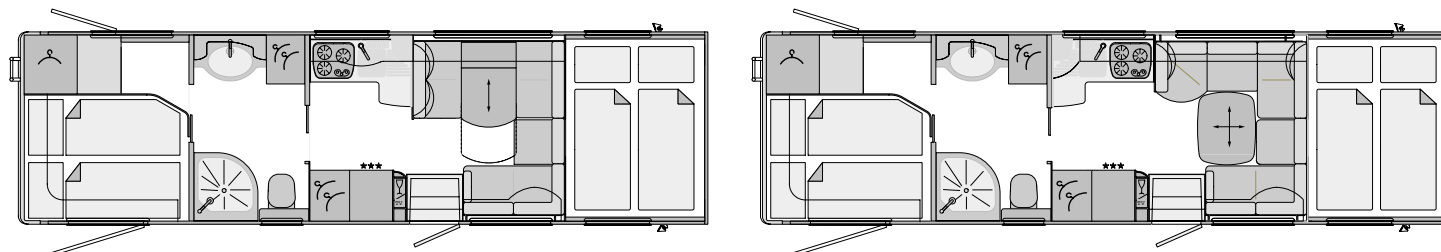

|  |                   |                   |                   |                   |                   |                   |
|--|-------------------|-------------------|-------------------|-------------------|-------------------|-------------------|
| Basic vehicle  | Iveco Daily       | Iveco Daily       | Iveco Eurocargo   | Iveco Eurocargo   | MAN TGL           | MAN TGL           |
| Chassis  | 60C18             | 65C18             | 75E18             | 80E22             | 8.210             | 8.240             |
| Engine   | 4-cylinder        | 4-cylinder        | 4-cylinder        | 6-cylinder        | 4-cylinder        | 6-cylinder        |
| Cubic capacity   | 3,0 l             | 3,0 l             | 3,9 l             | 5,9 l             | 4,6 l             | 6,9 l             |
| Power  | 130 kW (177 HP)   | 130 kW (177 HP)   | 130 kW (177 HP)   | 160 kW (217 HP)   | 151 kW (206 HP)   | 177 kW (240 HP)   |
| Torque   | 400 Nm            | 400 Nm            | 570 Nm            | 680 Nm            | 830 Nm            | 925 Nm            |
| Overall length (mm)  | 9470              | 9470              | 8830              | 8830              | 8830              | 8830              |
| Overall width (mm)   | 2380              | 2380              | 2490              | 2490              | 2490              | 2490              |
| Overall height (mm)  | 3420              | 3420              | 3570              | 3600              | 3600              | 3600              |
| Wheelbase (mm)   | 5100              | 5100              | 4455              | 4455              | 4500              | 4500              |
| Maximum permissible weight / Chassis downgrade <sup>1</sup> (kg) | 6000              | 6700              | 7490              | 8600              | 8800/7490         | 8800              |
| Kerb weight <sup>2</sup> (kg)                                    | 5270              | 5270              | 6320              | 6780              | 6660              | 7050              |
| Payload / Chassis downgrade <sup>2</sup> (kg)                    | 730               | 1430              | 1170              | 1820              | 2140/830          | 1750              |
| Trailer load in kg   | 3500              | 3500              | 3500              | 3500              | 3500              | 3500              |
| Seats with three-point safety belts F / FR                       | 4/3               | 4/3               | 4/3               | 4/3               | 4/3               | 4/3               |
| Left-hand seating element (mm)                                   | 1910/980          | 1910/980          | 1910/980          | 1910/980          | 1910/980          | 1910/980          |
| Right-hand bench seat (mm)                                       | 1270/640          | 1270/640          | 1270/640          | 1270/640          | 1270/640          | 1270/640          |
| Rear bed (mm)  | 2000/1550         | 2000/1550         | 2000/1550         | 2000/1550         | 2000/1550         | 2000/1550         |
| Size of overcab area (mm)  | 2230/1580         | 2230/1580         | 2340/1680         | 2340/1680         | 2340/1680         | 2340/1680         |
| Overcab bed dimensions (mm)                                      | 2100/1450         | 2100/1450         | 2100/1550         | 2100/1550         | 2100/1550         | 2100/1550         |
| Headroom above overcab bed mattress (mm)                         | 700               | 700               | 700               | 700               | 700               | 700               |
| Right-hand garage door H/W (mm)                                  | 1250/1150         | 1250/1150         | 1250/1150         | 1250/1150         | 1250/1150         | 1250/1150         |
| Left-hand garage door H/W (mm)                                   | 1250/800          | 1250/800          | 1250/800          | 1250/800          | 1250/800          | 1250/800          |
| <b>Price in euros (including 19 % VAT)</b>                       | <b>129,000.00</b> | <b>130,000.00</b> | <b>142,000.00</b> | <b>146,000.00</b> | <b>154,000.00</b> | <b>159,000.00</b> |

## Cruiser 940 M / 940 MR with Premium bathroom

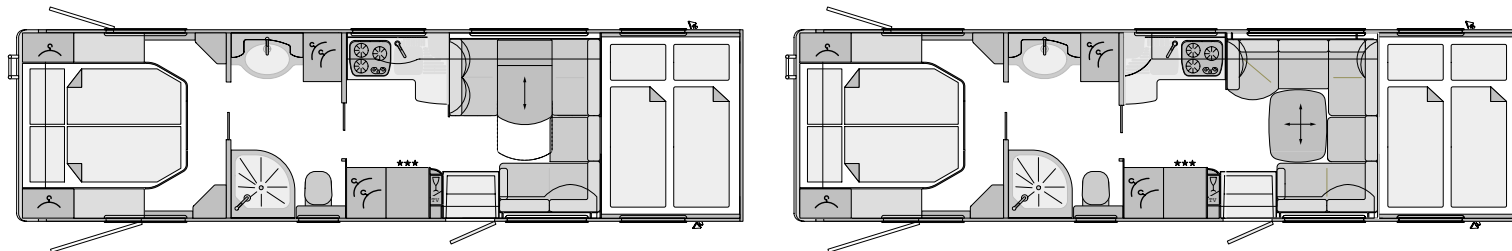

| Basic vehicle  | Iveco Eurocargo   | Iveco Eurocargo   | MAN TGL           | MAN TGL           | MAN TGL           |
|--|-------------------|-------------------|-------------------|-------------------|-------------------|
| Chassis  | 75 E 18           | 80 E 22           | 8.210             | 8.240             | 10.240            |
| Engine   | 4-cylinder        | 6-cylinder        | 4-cylinder        | 6-cylinder        | 6-cylinder        |
| Cubic capacity   | 3,9 l             | 5,9 l             | 4,6 l             | 6,9 l             | 6,9 l             |
| Power  | 130 kW (177 HP)   | 160 kW (217 HP)   | 151 kW (206 HP)   | 177 kW (240 HP)   | 177 kW (240 HP)   |
| Torque   | 570 Nm            | 680 Nm            | 830 Nm            | 925 Nm            | 925 Nm            |
| Overall length (mm)  | 9330              | 9330              | 9330              | 9330              | 9330              |
| Overall width (mm)   | 2490              | 2490              | 2490              | 2490              | 2490              |
| Overall height (mm)  | 3570              | 3600              | 3600              | 3600              | 3600              |
| Wheelbase (mm)   | 4815              | 4815              | 4850              | 4850              | 4850              |
| Maximum permissible weight / Chassis downgrade <sup>1</sup> (kg) | 7490              | 8600              | 8800/7490         | 8800              | 10000             |
| Kerb weight <sup>2</sup> (kg)                                    | 6470              | 6930              | 6810              | 7200              | 7370              |
| Payload / Chassis downgrade <sup>2</sup> (kg)                    | 1020              | 1670              | 1990/680          | 1600              | 2630              |
| Trailer load in kg   | 3500              | 3500              | 3500              | 3500              | 3500 <sup>3</sup> |
| Seats with three-point safety belts M /MR                        | 4/3               | 4/3               | 4/3               | 4/3               | 4/3               |
| Left-hand seating element (mm)                                   | 1910/980          | 1910/980          | 1910/980          | 1910/980          | 1910/980          |
| Right-hand bench seat (mm)                                       | 1270/640          | 1270/640          | 1270/640          | 1270/640          | 1270/640          |
| Rear bed (mm)  | 2000/1600         | 2000/1600         | 2000/1600         | 2000/1600         | 2000/1600         |
| Size of overcab area (mm)  | 2340/1680         | 2340/1680         | 2340/1680         | 2340/1680         | 2340/1680         |
| Overcab bed dimensions (mm)                                      | 2000/1550         | 2000/1550         | 2000/1550         | 2000/1550         | 2000/1550         |
| Headroom above overcab bed mattress (mm)                         | 700               | 700               | 700               | 700               | 700               |
| Right-hand garage door H/W (mm)                                  | 1250/1150         | 1250/1150         | 1250/1150         | 1250/1150         | 1250/1150         |
| Left-hand garage door H/W (mm)                                   | 1250/800          | 1250/800          | 1250/800          | 1250/800          | 1250/800          |
| <b>Price in euros (including 19 % VAT)</b>                       | <b>146,000.00</b> | <b>150,000.00</b> | <b>159,000.00</b> | <b>164,000.00</b> | <b>169,000.00</b> |

# SPECIAL OPTIONS - CHASSIS

## Iveco Daily chassis

|          |  | PRICE IN EUROS<br>including 19 % VAT | EXTRA WEIGHT<br>in kg |
|----------|--|--------------------------------------|-----------------------|
| 709 026  | <b>Complete basic vehicle package 1, Cruiser Daily (Saving in comparison to individual order: 1,560.00 euros)</b><br>Chassis with 6.700 kg maximum permissible weight<br>Aluminium rims on front axle / Wheel trims on rear axle<br>Differential lock for rear axle<br>Elegant wood grain finish for dashboard<br>Fuel tank - 170 l<br>Air suspension on rear axle with "raise + lower" function | 7,990.00                             | 105                   |
| 709 027  | <b>Complete basic vehicle package 2, Cruiser Daily (Saving in comparison to individual order: 2,910.00 euros)</b><br>Additional to basic vehicle package 1:<br>Trailer coupling with 12 V socket-outlet<br>Daily jacks with automatic levelling  | 14,900.00                            | 206                   |
| 702 214  | Aluminium rims on front axle / Wheel trims on rear axle  | 1,490.00                             | - 6                   |
| 700 048  | Trailer coupling with 12 V socket-outlet (only available as a factory-fitted option)   | 1,450.00                             | 29                    |
| 700 043  | Deduction for ball hitch and bumper cutout for trailer coupling  | -150.00                              | - 4                   |
| 700 041  | Removable ball hitch (in conjunction with trailer coupling only)   | 400.00                               | 5                     |
| 125 024  | Agile automated 6-speed manual transmission  | 1,690.00                             | 20                    |
| 125 060  | Differential lock for rear axle  | 850.00                               | 15                    |
| 703 5041 | Elegant wood grain finish for dashboard  | 495.00                               | 1                     |
| 700 078  | Cruiser Daily jacks with automatic levelling   | 6,900.00                             | 72                    |
| 125 503  | Fuel tank - 170 l  | 1,380.00                             | 70                    |
| 125 065  | Air suspension on rear axle with "raise + lower" function  | 4,400.00                             | 25                    |
| 125 152  | Luxury heated cab seats with air suspension and armrest, covered in original material  | 690.00                               | 30                    |



# SPECIAL OPTIONS - CHASSIS

## Iveco Eurocargo chassis

|         |   | PRICE IN EUROS<br>including 19 % VAT | EXTRA WEIGHT<br>in kg |
|---------|---|--------------------------------------|-----------------------|
| 709 020 | <b>Complete basic vehicle package 1, Cruiser Eurocargo 75E18 (Saving in comparison to individual order: 1,485.00 euros)</b><br>Differential lock for rear axle<br>Elegant wood grain finish for dashboard<br>Air suspension on rear axle with "raise + lower" function<br>Stainless steel wheel trims | 3,990.00                             | 46                    |
| 709 021 | <b>Complete basic vehicle package 2, Cruiser Eurocargo 75E18 (Saving in comparison to individual order: 3,125.00 euros)</b><br>Additional to complete basic vehicle package 1:<br>Trailer coupling with 12 V socket-outlet<br>Eurocargo jacks with automatic levelling                                | 11,300.00                            | 150                   |
| 709 022 | <b>Complete basic vehicle package 1, Cruiser Eurocargo 80E22 (Saving in comparison to individual order: 1,485.00 euros)</b><br>Differential lock for rear axle<br>Elegant wood grain finish for dashboard<br>Air suspension on rear axle with "raise + lower" function<br>Stainless steel wheel trims | 5,990.00                             | 66                    |
| 709 023 | <b>Complete basic vehicle package 2, Cruiser Eurocargo 80E22 (Saving in comparison to individual order: 3,125.00 euros)</b><br>Additional to complete basic vehicle package 1:<br>Trailer coupling with 12 V socket-outlet<br>Eurocargo jacks with automatic levelling                                | 13,300.00                            | 170                   |
| 700 511 | Trailer coupling with 12 V socket-outlet (only available as a factory-fitted option)  | 1,450.00                             | 29                    |
| 700 043 | Deduction for ball hitch and bumper cutout for trailer coupling   | - 150.00                             | - 4                   |
| 700 041 | Removable ball hitch (in conjunction with trailer coupling only)  | 400.00                               | 5                     |
| 126 005 | Differential lock for rear axle   | 650.00                               | 15                    |
| 126 018 | Digital tachograf (required for commercial purpose)   | 1,490.00                             | 1                     |
| 703 506 | Elegant wood grain finish for dashboard   | 430.00                               | 1                     |
| 700 077 | Eurocargo jacks with automatic levelling  | 7,500.00                             | 75                    |
| 126 013 | Air suspension on rear axle with "raise + lower" function   | 3,990.00                             | 25                    |
| 126 015 | Air suspension on rear and front axle with "raise + lower" function (model 80E22 only)  | 5,990.00                             | 45                    |
| 702 244 | 17,5" Stainless steel wheel trims   | 340.00                               | 5                     |
| 126 040 | Bumper and front wheelarches in same colour as cab  | 790.00                               | 4                     |

# SPECIAL OPTIONS - CHASSIS

## MAN TGL chassis

|          |  | PRICE IN EUROS<br>including 19 % VAT | EXTRA WEIGHT<br>in kg |
|----------|--|--------------------------------------|-----------------------|
| 709 024  | <b>Complete basic vehicle package 1, Cruiser MAN</b><br><b>(Saving in comparison to individual order: 3,575.00 euros with 210 engine or 4,525.00 euros with 240 engine)</b><br>Automatic 6-speed transmission TipMatic (12-speed with 240 engine)<br>ASR traction control system<br>Bi-xenon headlights with cleaning system and additional high-beam headlights, direction indicators with LED side light array<br>Differential lock for rear axle<br>Elegant wood grain finish for dashboard<br>Air suspension on rear axle with "raise + lower" function<br>Stainless steel wheel trims | 7,990.00                             | 71 (111)              |
| 709 025  | <b>Complete basic vehicle package 2, Cruiser MAN</b><br><b>(Saving in comparison to individual order: 5,615.00 euros with 210 engine, 6,615.00 euros with 240 engine)</b><br>Additional to basic vehicle package 1:<br>Trailer coupling with 12 V socket-outlet<br>MAN jacks with automatic levelling  | 14,900.00                            | 175 (215)             |
| 700 052  | Chassis downgrade to 7,490 kg maximum permissible weight (8.210 engine with adequate remaining payload only)   | 100.00                               | 0                     |
| 700 501  | Aluminium rims 6,75" with 265/70 R 17,5 tyres (in conjunction with 240 engine only)  | 2,990.00                             | - 56                  |
| 700 5011 | Aluminium rims 6,75" x 17,5 with standard tyres  | 2,450.00                             | - 56                  |
| 700 5012 | Aluminium rims 6,75" x 17,5 with 265/70 R 17,5 tyres (instead of wheel trims, with 240 engine in conjunction with basic vehicle pack. 1 or 2 only)   | 2,650.00                             | - 61                  |
| 702 217  | Aluminium rims 6,75" x 17,5 with standard tyres (instead of wheel trims, in conjunction with basic vehicle package 1 or 2 only)  | 2,110.00                             | -61                   |
| 700 511  | Trailer coupling with 12 V socket-outlet (only available as a factory-fitted option)   | 1,450.00                             | 29                    |
| 700 043  | Deduction for ball hitch and bumper cutout for trailer coupling  | - 150.00                             | - 4                   |
| 700 041  | Removable ball hitch (in conjunction with trailer coupling only)   | 400.00                               | 5                     |
| 146 010  | Automatic 6-speed transmission TipMatic (with 210 engine only)   | 2,750.00                             | 10                    |
| 146 012  | Automatic 12-speed transmission TipMatic (with 240 engine only)  | 3,750.00                             | 50                    |
| 146 016  | ASR traction control system  | 1,050.00                             | 5                     |
| 146 024  | Bi-xenon headlights  | 1,990.00                             | 5                     |
| 146 018  | Differential lock for rear axle  | 650.00                               | 15                    |
| 146 026  | MAN digital tachograph (required for commercial purpose)   | 1,490.00                             | 1                     |
| 703 507  | Elegant wood grain finish for MAN dashboard  | 495.00                               | 1                     |
| 146 020  | Air suspension on rear axle with "raise + lower" function  | 4,290.00                             | 30                    |
| 700 077  | MAN jacks with automatic levelling   | 7,500.00                             | 75                    |
| 702 244  | 17,5" Stainless steel wheel trims  | 340.00                               | 5                     |

# SPECIAL OPTIONS - COACHWORK

## Coachwork

|         |   | PRICE IN EUROS<br>including 19 % VAT | EXTRA WEIGHT<br>in kg |
|---------|---|--------------------------------------|-----------------------|
| 240 999 | Cover for rear ladder   | 145.00                               | 6                     |
|         | Rear ladder extension   | Standard                             | 0                     |
| 700 097 | Silver-coloured awning - 5.5 m  | 1,250.00                             | 40                    |
| 700 089 | Electric motor for awning, mounted on the right-hand side                               | 450.00                               | 4                     |
| 700 754 | Midi roof hatch with integrated light in the bedroom instead of the standard roof hatch | 590.00                               | 6                     |
| 700 752 | Panoramic roof hatch with lighting in the bedroom instead of the standard roof hatch    | 1,190.00                             | 18                    |

## Kitchen

|         |   |          |    |
|---------|---|----------|----|
| 709 10. | <b>Kitchen package 1</b> (in conjunction with Electrical power package 1 or 2 only), 175 l refrigerator with silver-coloured door frame, 230-V coffee-maker and Corisan kitchen worktop with seamlessly integrated sink | 1,590.00 | 10 |
| 709 05. | <b>Kitchen package 2</b> (in conjunction with Electrical power package 1 or 2 only), 175 l refrigerator / oven combination, 230-V coffee-maker and Corisan kitchen worktop with seamlessly integrated sink              | 1,999.00 | 26 |
| 700 45. | Corisan kitchen worktop with seamlessly integrated sink   | 1,290.00 | 8  |
| 700 808 | 175 l refrigerator with silver-coloured door frame instead of 142 l standard refrigerator   | 590.00   | 2  |
| 700 809 | 175 l refrigerator / oven combination   | 1,200.00 | 18 |
| 700 436 | Microwave cooker with grill and hot-air functions fitted under hob, stainless steel, 230 V mode, 26 l capacity  | 998.00   | 22 |
| 701 899 | Dish washer unter gas hob (in conjunction with Electrical power package 1 or 2 only, not with microwave cooker)   | 1,410.00 | 25 |

# SPECIAL OPTIONS COACHWORK

## Water / Gas / Heating / Bathroom

|         |  | PRICE IN EUROS<br>including 19 % VAT | EXTRA WEIGHT<br>in kg |
|---------|--|--------------------------------------|-----------------------|
| 700 412 | Outside shower in the garage (Driver's side)   | 275.00                               | 2                     |
| 700 862 | "Motor Caravan" heating system with convenient continuous heating function (5.2 kW) and time switch            | 2,590.00                             | 10                    |
| 701 890 | 350 l freshwater tank  | 420.00                               | 110                   |
| 701 892 | 350 l freshwater and wastewater tanks  | 750.00                               | 120                   |
| 700 898 | Gas alarm for living area  | 360.00                               | 2                     |
| 700 890 | 120 l gas tank with remote switch and level indicator on the control panel display                             | 1,990.00                             | 88                    |
| 700 868 | Heated towel rail  | 750.00                               | 11                    |
| 700 832 | 2.4 kW air conditioner for living area with infrared remote controller, fitted in the intrafloor area          | 2,500.00                             | 37                    |
| 700 836 | 2 x 2.4 kW air conditioner for living area and bedroom/bathroom, separately controllable (from model 890 only) | 4,950.00                             | 74                    |
| 701 811 | SOG toilet roof vent (in conjunction with integrated water-flush toilet only)                                  | 299.00                               | 1                     |
| 701 820 | Porcelain toilet bowl with macerator and 170 l waste tank (recommended: 350 l freshwater tank)                 | 1,590.00                             | 28                    |

## Electrical equipment

|         |  |          |    |
|---------|--|----------|----|
| 700 740 | <b>Electrical power package 1</b><br>Additional 150 Ah gel battery (making a total of 2) with 45 A charger instead of 25 A charger,<br>power inverter from 12 V to 230 V, 1500 W sine-wave with remote control and automatic mains priority circuit    | 1,555.00 | 55 |
| 700 742 | <b>Electrical power package 2</b><br>2 additional 150 Ah gel batteries (making a total of 3)<br>combined 100 A charger with sine-wave converter from 12 V to 230 V, 4000 W peak output and 2000 W<br>continuous output with mains failure compensation | 3,350.00 | 95 |
| 701 200 | Alarm system   | 1,150.00 | 3  |
| 700 684 | Double reversing camera with shutter and 7" TFT display  | 1,495.00 | 4  |
| 700 706 | Additional 150 Ah gel battery (making a total of 2, not in conjunction with Electrical power package)  | 450.00   | 45 |
| 700 705 | Additional 150 Ah gel battery (making a total of 2) + 45 A charger (not in conjunction with Electrical power package)  | 790.00   | 50 |
| 700 704 | 2 additional 150 Ah gel batteries (making a total of 3) + 45 A charger (not in conjunction with Electrical power package)  | 1,240.00 | 98 |
| 700 853 | Generator (gas, 2500 W, in conjunction with gas tank only)   | 4,580.00 | 66 |
| 700 850 | Generator (petrol, 2600 W) permanently installed with separate fuel tank   | 4,580.00 | 50 |
| 700 720 | Solar unit with approx. 120 W maximum power  | 1,490.00 | 15 |
| 700 722 | Solar unit with approx. 240 W maximum power  | 2,590.00 | 30 |
| 700 483 | Power inverter from 12 V to 230 V, 1500 W sine-wave with remote control and automatic mains priority circuit   | 1,190.00 | 8  |

# SPECIAL OPTIONS - COACHWORK

## TV / Radio / Telephone

|           |   | PRICE IN EUROS<br>including 19 % VAT | EXTRA WEIGHT<br>in kg |
|-----------|---|--------------------------------------|-----------------------|
| 700 6903  | Digital satellite receiving system with 85 cm dish, fully automatic orientation, digital receiver with 2 CI slots for encrypted programmes, multi-party capability thanks to TWIN LNB, connection for second receiver with 12 V / 230 V and antenna socket in the bedroom | 3,690.00                             | 25                    |
| 700 610   | Radio with CD and MP3 player, with Bluetooth and hands-free talking facility for the telephone (instead of standard fitted radio)   | 320.00                               | 0                     |
| 700 634   | Connection for radio prepared in coachwork with two additional speakers   | 590.00                               | 2                     |
| 700 670   | Roof-mounted telephone antenna for D and E networks (specify cable end)   | 250.00                               | 1                     |
| 700 6692  | 20" flat panel display in wall glass cupboard on the right-hand side, may be lowered by electric motor, including ceiling-high glass-fronted cabinet near the door  | 1,790.00                             | 20                    |
| 700 699   | 20" flat panel display for rear bedroom (not for H-model)   | 1,190.00                             | 13                    |
| 700 667   | 20" flat panel display under glass-fronted cabinet near the door  | 1,190.00                             | 13                    |
| 700 29021 | Additional digital satellite receiver for the bedroom   | 290.00                               | 3                     |

## Furnishings, fabrics and leather upholstery

|    |   |          |    |
|----|---|----------|----|
| 01 | Soft-look leather upholstery in the living area - Mint Green    | 2,000.00 | 25 |
| 02 | Soft-look leather upholstery in the living area - Caramel       | 2,000.00 | 25 |
| 03 | Soft-look leather upholstery in the living area - Sandstone     | 2,000.00 | 25 |
| 04 | Soft-look leather upholstery in the living area - Dove Blue     | 2,000.00 | 25 |
| 41 | Soft-look microfibre upholstery in the living area - Mint Green | 0.00     | -  |
| 42 | Soft-look microfibre upholstery in the living area - Caramel    | 0.00     | -  |
| 43 | Soft-look microfibre upholstery in the living area - Sandstone  | Standard | -  |
| 44 | Soft-look microfibre upholstery in the living area - Dove Blue  | 0.00     | -  |

## Miscellaneous

|         |   |        |   |
|---------|---|--------|---|
| 800 000 | Delivery (with comprehensive instruction, handover inspection and approx. 80 l diesel ) | 650.00 | - |
|---------|---|--------|---|

<sup>1</sup> HGV driving licence required for vehicles with a maximum permissible weight of 7,500 kg and above.

<sup>2</sup> The kerb weight includes: driver (75 kg), full fuel and freshwater tanks, gas, tools and spare wheel. Weights and dimensions may vary according to special options and accessories. All measurements and weights reflect the specifications at the time of going to press. Deviations by +/- 5 % are possible and permitted.

<sup>3</sup> Maximum permissible weight of 13.400 kg



# SECTIONAL DRAWING

## THE CABIN CONSTRUCTION OF THE CONCORDE CRUISER

As far as motorhome building is concerned, the name Concorde is regarded as being a synonym for perfect insulation and outstanding stability. This is primarily due to the fully bonded Solidtherm® cabin construction with high-density solid PU profiles to eliminate cold spots and the side wall insulation with a 40 millimetre layer of RTM foam. As if that were not enough: sandwich constructions are also used for the floor and intermediate panels, with insulation layers adding up to a total of 70 millimetres, contributing to the as yet unparalleled insulation values achieved by Concorde. Furthermore, the side skirts, the bumpers and the front and rear sections are made of rugged but flexible GRP material. The completely smooth, high gloss, aluminium sandwich wall panels create an automobile impression and aluminium roof profile sections with rain channels reduce soiling of the side walls to ensure that the attractive appearance is maintained over the years.

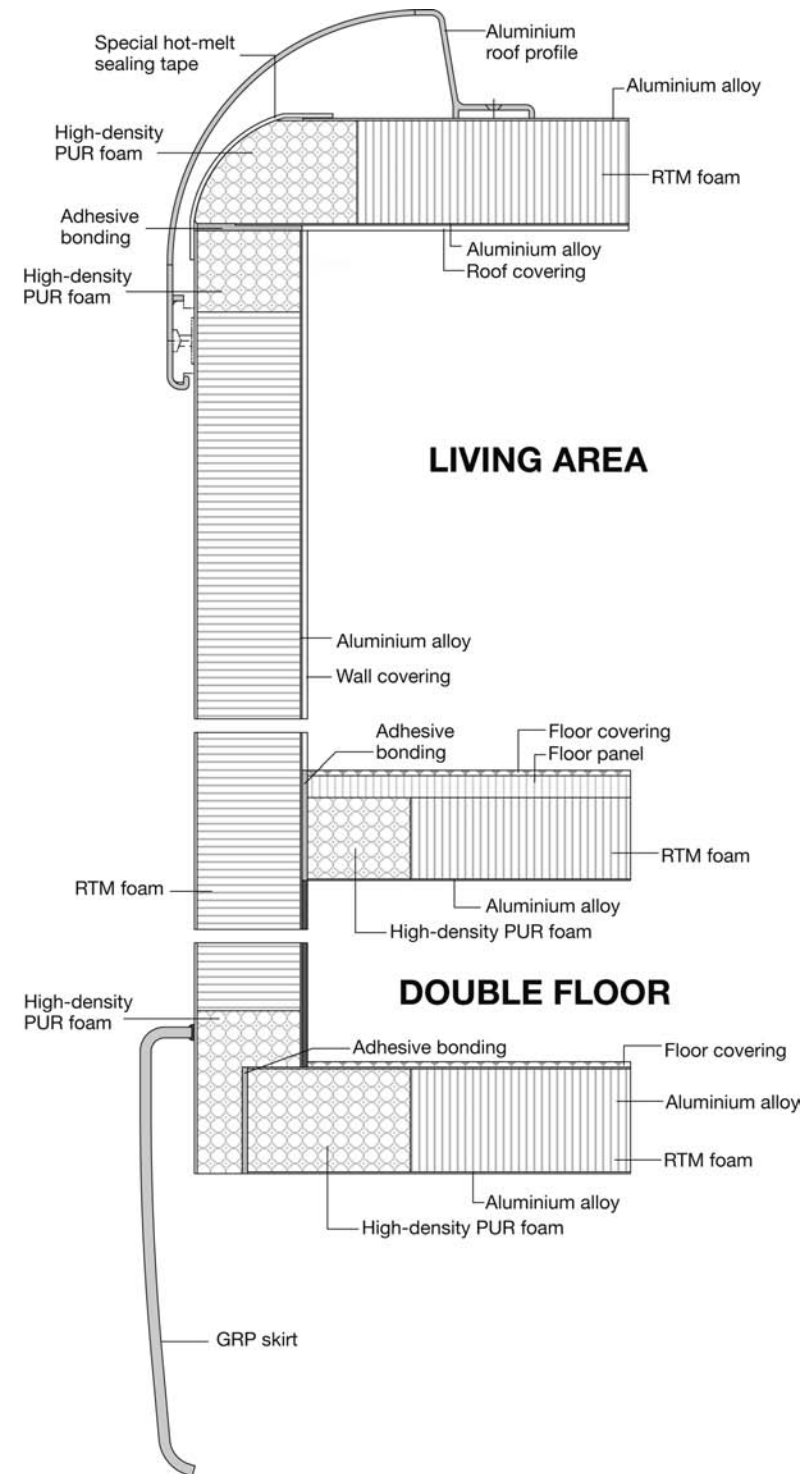

The prices for vehicles and special options apply to vehicles purchased and registered in Germany and are quoted in euros including 19 % value-added tax. Concorde reserves the right to adjust the quoted prices in the event of an increase in value-added tax between order and delivery. All prices are recommended retail prices ex works. If the vehicle manufacturers change their prices, this will necessitate a corresponding adjustment to the price of the finished vehicle. The prices for special options only apply where these are installed in the factory, assuming that adequate notice has been given. Retrospective installation work incurs additional costs for materials and labour. The quoted prices include the ancillary expenses for delivery of the chassis and acceptance by the German Technical Inspectorate (TÜV). Concorde reserves the right to implement technical modifications as long as the quality of the product remains the same or is improved, and the intended purpose is not adversely affected. This price list supersedes all previous price lists.

# ***Concorde***

REISEMOBILE AUS LEIDENSCHAFT

Concorde Reisemobile GmbH  
Concorde-Strasse 2-4, 96132 Schlüsselfeld-Aschbach, Germany  
Phone ++49(0) 95 55 / 92 25-0 - Fax ++49(0) 95 55 / 92 25-44  
Web site: [www.concorde.eu](http://www.concorde.eu)  
eMail: [info@concorde.eu](mailto:info@concorde.eu)