

Price List 1-2010

Credo



Concorde
REISEMOBILE AUS LEIDENSCHAFT

STANDARD SPECIFICATION

Fiat Ducato Chassis

Credo
Emotion

Turbocharged diesel engine with electronically controlled Common Rail direct injection

•

Compliance with Euro 4 emissions standard by means of exhaust gas recirculation

•

6-speed transmission with dashboard gear shift

•

Front wheel drive with ASR traction control system

•

Alko low-frame lowered by 220 mm

•

Galvanized frame parts

•

Independent front and rear wheel suspension

•

Wheel sizes 215/70 R 15 (for chassis version 3.500 kgs / 3.700 kgs maximum permissible weight)

•

Wheel sizes 225/75 R 16 (for chassis version 4.250 kgs maximum permissible weight)

•

Disc brakes on front and rear axles

•

Electronic brake-pad wear indicator

•

Electronic brake-force distribution (EBD)

•

Electronically controlled anti-locking braking system (ABS)

•

Alternator 14 V, 110 A / 1.400 W

•

Battery 12 V / 95 Ah

•

Fuel tank 90 l

•

Twin headlights

•

Tinted windscreen

•

Adjustable steering wheel

•

Electrically adjustable, heated outside mirrors

•

Flat tyre kit with compressor

•

Warning triangle and first-aid kit

•

Warning lamp and wheel chock

•

STANDARD SPECIFICATION

Iveco Daily chassis

	Credo Passion	Credo Action
Turbocharged diesel engine with electronically controlled Common Rail direct injection	•	•
Compliance with Euro 4 emissions standard by means of exhaust gas recirculation	•	•
6-speed transmission with dashboard gear shift	•	•
Rear wheel drive with ASR traction control system	•	•
Rear axle with comfortable parabolic springs (air suspension available as an optional extra)	•	–
Twin rear wheel size 195/75 R 16 (Iveco 50C18)	•	–
Twin rear wheel size 225/75 R 16 (Iveco 60C18)	–	•
Disc brakes on front and rear axles	•	•
Electronic brake-pad wear indicator	•	•
Electronically controlled anti-lock braking system (ABS)	•	•
Cruise control	•	•
Alternator 14 V, 140 A / 1.960 W	•	•
Battery 12 V / 110 Ah	•	•
Fuel tank 100 l	•	•
Tinted windscreen	•	•
Power-operated driver and passenger windows	–	•
Fog lights	–	•
Twin headlights	•	–
Electrically adjustable, heated outside mirrors	•	•
Spare wheel	•	•
Warning triangle and first-aid kit	•	•
Warning lamp and wheel chock	•	•

STANDARD SPECIFICATION

Coachwork

	Credo Emotion	Credo Passion	Credo Action
Modern bus design	•	•	–
Panoramic, tinted, laminated glass windscreen	•	•	–
Sliding, toughened, tinted, insulating glass side windows with integrated blind	•	•	–
Tinted double-glazed tilting/sliding plastic windows in the living area with integrated blind and fly screen	•	•	•
Darkening blind for windscreen	•	–	–
Electrically operated insulating roller blind for windscreen	–	•	–
Rugged long-life Solidtherm aluminium sandwich construction	•	•	•
„Faraday cage“ lightning protection	•	•	•
Fully insulated wall joining technique using high-density solid PU profiles to eliminate cold spots	•	•	•
Wall thickness 32mm with 30 mm closed-cell, high-resistance RTM foam	•	•	•
Chromated aluminium alloy external and internal wall, roof and underbody panels	•	•	•
Smooth outer panels with white baked enamel finish	•	•	•
Walk-on roof	•	•	•
Side skirts made of strong but flexible, corrosion-free GRP material	•	•	•
GRP sandwich rear wall construction with PU foam core	•	•	•
Heated double floor approx. 300 mm high	•	–	–
Heated double floor approx. 334 mm (Credo Passion) and 357 mm (Credo Action)	–	•	•
Sandwich-type floor and intermediate panel construction with 30 mm RTM foam insulation, total floor insulation 60mm	•	•	•
Rugged GRP wheel arches with fully insulated sandwich construction for the rear axle	•	•	•
Illuminated, heated rear garage with loading flap on the right-hand side, floor rail tracks with fastening eyelets (for Credo Passion only)	•	•	–
Illuminated, heated rear garage with loading flap on the right- and left-hand side, floor rail tracks with fastening eyelets	–	–	•
Heated double step inside the entrance door	•	•	•
Electrically retractable outside steps with safety circuit	–	•	•
Solid entrance door with safety lock	•	•	•
Exterior light with safety circuit, switches off automatically when the engine is started	•	•	•
Cockpit seats with armrests (same material as the seats in the living room, height-adjustable, Daily with integrated safety belts)	•	•	–
Cockpit seats in original fabrics, passenger seat adjustable	–	–	•
Credo decals in blue/silver	•	•	•

STANDARD SPECIFICATION

Living area / Bedroom

	Credo Emotion	Credo Passion	Credo Action
Walls and ceiling in colour-coordinated carpet	•	•	•
Easy-clean laminated floor covering	•	•	•
Ergonomic, high-quality, Diolen-upholstered seating elements with zip-off covers	•	•	•
Microfibre covers on the seats in the living area (Credo Emotion and Passion, including cockpit seats)	•	•	•
Lengthwise bench can be combined with seating elements to make a spacious seating arrangement (incl. table extension for dinette)	–	–	•
High-quality furniture with laminate or veneer construction	•	•	•
Furniture flaps and doors with metal hinges and catches	•	•	•
Lighted wardrobe	•	•	•
Rear bed with slatted frame and comfortable cold foam mattress	•	•	•
Sliding door used as room divider leading to the bedroom (not available for models with H beds)	•	•	•
Insulated sliding door leading to the cab, may be locked from the living area	–	–	•
Double-glazed Midi roof hatch in the living area with blind and fly screen	•	•	•
Roof hatch in the bedroom with integrated blind and fly screen	•	•	•
Sturdy laminated table with wood grain finish	•	•	•
Fabric curtains at the windows in the living area and bedroom	•	•	•
Glass-fronted cabinet with shelves next to the entrance door, incl. assorted glasses	•	•	•
Lighting canopies with halogen spotlights and integrated lighting	•	•	•
Solid metal handle inside the entrance door	•	•	•
230-V sockets	•	•	•

Over-cab

Size of over-cab (mm)	–	–	2180 x 1580
Mattress dimensions (mm)	–	–	2050 x 1450
Headroom above bed (mm)	–	–	715
Two-part sprung slatted frame with single Carawinx mattress	–	–	•
Curtain to separate the over-cab bedroom from the living area	–	–	•
Roof hatch with integrated blind and fly screen	–	–	•
Shelves and reading lights	–	–	•
Two double-glazed opening windows with blinds	–	–	•
Rear ladder	–	–	•

STANDARD SPECIFICATION

Pulldown Bed (optional extra)

	Credo Emotion	Credo Passion	Credo Action
Mattress dimensions (mm)	1920 x 1320	1920 x 1320	–
Headroom above bed (mm)	800	800	–
Two-part sprung slatted frame with single cold foam mattress	•	•	–
Roof hatch with integrated blind and fly screen	•	•	–
Curtain to separate the living area	•	•	–

Kitchen

Flush-fitted three-flame stainless steel gas hob with automatic ignition and glass cover	•	•	•
Stainless steel sink	•	•	•
Single-lever chrome sink mixer	•	•	•
Worktop area with hard-wearing laminate finish	•	•	•
97l refrigerator/freezer combination, AES (automatic and manual energy selection 12 V / 230 V / gas)	•	–	–
142l refrigerator/freezer combination, AES (automatic and manual energy selection 12 V / 230 V / gas)	–	•	•
Cutlery drawer	•	•	•
Lighting with halogen spotlights in the canopy and underneath the wall cupboards	•	•	•
230-V sockets	•	•	•
Wastebin integrated in worktop area	•	•	•

Bathroom / Toilet

Bathroom cabinet with mirror and shelf	•	•	•
Lighting with halogen spotlights and outside switch	•	•	•
Corisan washstand with flush integrated washbasin	•	•	•
Single-lever chrome mixer on the washstand	•	•	•
Shower with double acrylic door and detachable clothes bar	•	•	•
Shower column with soap dish and chrome railing	•	•	•
Shower mixer with wall rail and shower head with height adjustment facility	•	•	•
Cassette toilet	•	•	•
Toilet paper holder and towel hooks	•	•	•
Roof hatch with integrated fly screen and blind	•	•	•
230-V socket	•	•	•

STANDARD SPECIFICATION

Water / Gas / Heating

	Credo Emotion	Credo Passion	Credo Action
Gas compartment for 2 x 11 kg gas bottles	•	•	•
Cut-off valves for all appliances	•	•	•
Freshwater and wastewater tanks fitted in the heated double floor, ca. 140 l each (driving position freshwater tank: 40 l)	•	–	–
Freshwater and wastewater tanks fitted in the heated double floor, ca. 160 l each (driving position freshwater tank: 100 l)	–	•	•
Easy access wastewater drain valve in the heated double floor	•	•	•
Access to both tanks from living area for easy cleaning	•	•	•
Direct drainage facility for freshwater tank via valve in double floor	•	•	•
Automatically operating central water pump with surge tank	•	•	•
5.500 W hot water engine-independent gas fired central heating with thermostatic control and time switch, 230 V / 3.000 W electric heater, automatic vent valve, non return valve	•	•	•
Integrated hot-water boiler to supply all taps	•	•	•

Electrical Equipment / TV / Radio

90-AH-AGM-Battery	•	•	•
Battery watch system avoiding overloading or total discharge of batteries	•	•	•
230-V-CEE connection in the storage compartment with cable routing through the double floor	•	•	•
Central control and distribution module with microprocessor technology	•	•	•
Automatic battery charging facility with electronic control and battery temperature sensor, 25 A maximum charging current	•	•	•
Automatic charging of leisure and vehicle batteries when connected to an external power supply and while driving	•	•	•
Automatic connection and disconnection of leisure and vehicle batteries	•	•	•
Automatic refrigerator cut-off in 12 V mode when engine is switched off	•	•	•
Deactivation of on-board electrical system when voltage too low or in the event of overheating, with automatic reactivation	•	•	•
Automatic residual-current-operated circuit breaker	•	•	•
350 W sine-wave power inverter and mains priority circuit (230 V for all sockets even when not connected to external power supply)	–	•	•

STANDARD SPECIFICATION

On-board electronics

	Credo Emotion	Credo Passion	Credo Action
Ultra-modern microprocessor-controlled electronic system with BUS technology (Binary Unit System)	•	•	•
Central control and monitoring panel with 3,5" color screen	•	•	•
Master switch for all electrical equipment	•	•	•
Pushbuttons to switch off the following items:			
• Heating	•	•	•
• Anti-freeze system for gas pressure regulator	•	•	•
• Lighting	•	•	•
• Water pump	•	•	•
• Power inverter	•	•	•
LCD indicator panel for monitoring of:			
• Freshwater tank	•	•	•
• Wastewater tank	•	•	•
• Voltage of leisure and vehicle battery	•	•	•
• Outside and inside temperature	•	•	•
• Charging and discharging current	•	•	•
• External power supply	•	•	•
• Batteries connected in parallel	•	•	•
• Date and time with alarm clock function	•	•	•
Alarm facilities for:			
• Wastewater tank full	•	•	•
• Freshwater tank empty	•	•	•
• Low battery voltage	•	•	•
• Reserve gas bottle in use	•	•	•
• Step extended	–	•	•



Concorde

Concorde

Credo ****

Credo
Credo

CONCORDE

TECHNICAL DATA

Credo Emotion Fiat Ducato

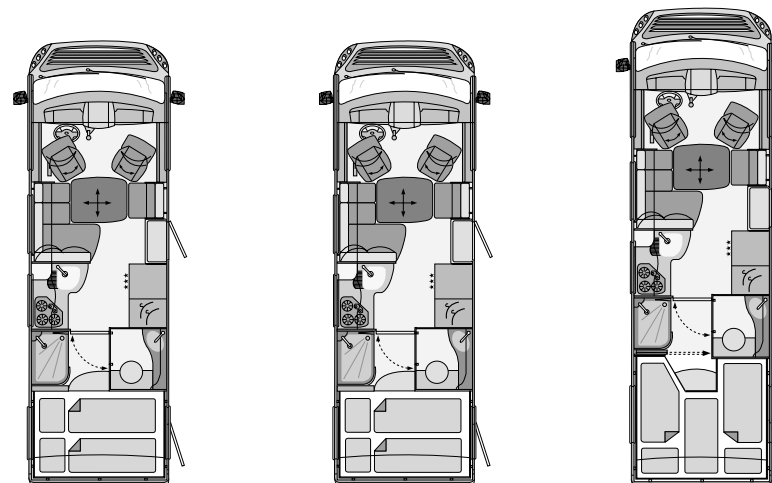

	Credo Emotion 693 H	Credo Emotion 693 H	Credo Emotion 763 L
Basic vehicle	Fiat Ducato	Fiat Ducato	Fiat Ducato
Chassis	130 Multijet	130 Multijet	130 Multijet
Engine	4-cylinder	4-cylinder	4-cylinder
Cubic capacity	2,3 l	2,3 l	2,3 l
Power	96 kW (130 HP)	96 kW (130 HP)	96 kW (130 HP)
Torque	320 Nm	320 Nm	320 Nm
Overall length (mm)	7150	7150	7710
Overall width (mm)	2290	2290	2290
Overall height (mm)	2990	2990	2990
Wheelbase (mm)	4035	4143	4443
Maximum permissible weight / downgraded (kg)	3700 / 3500	4250	4250
Weight in running order ¹ (kg)	3150	3210	3310
Payload ¹ (kg)	550 / 350	1040	940
Trailer load (kg)	2000 ²	2000 ²	2000 ²
Seats with three-point safety belts / lapbelt	3/1	4	4
Left-hand seating element (mm)	1290/950	1290/950	1290/950
Right-hand seating element (mm)	590/620	590/620	590/620
Rear bed (mm)	2100/1400	2100/1400	2010/850 + 1980/850
Right-hand garage door H/W (mm)	1100/750	1100/750	1100/750
Price in euro (incl. 19% VAT)	82.900,-	84.900,-	87.900,-

TECHNICAL DATA

Credo Passion Iveco Daily

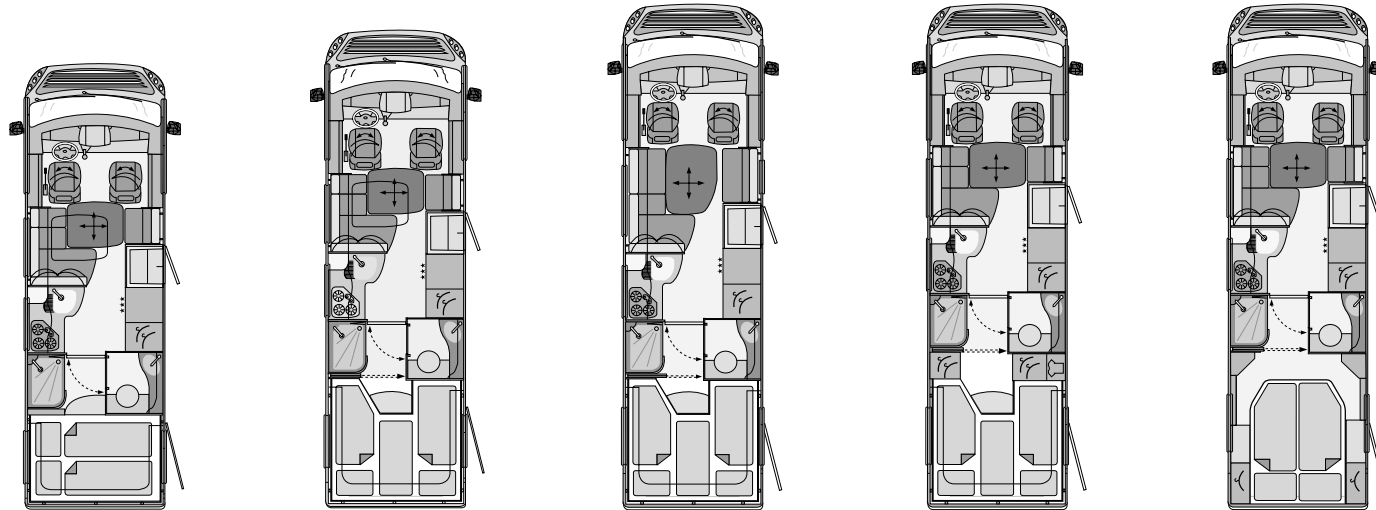

	Credo Passion 713 H	Credo Passion 773 L	Credo Passion 813 L	Credo Passion 813 LS	Credo Passion 813 M
Basic vehicle Iveco Daily	Iveco Daily	Iveco Daily	Iveco Daily	Iveco Daily	Iveco Daily
Chassis	50C18	50C18	50C18	50C18	50C18
Engine	4-cylinder	4-cylinder	4-cylinder	4-cylinder	4-cylinder
Cubic capacity	3,0 l	3,0 l	3,0 l	3,0 l	3,0 l
Power	130 kW (177 PS)	130 kW (177 HP)	130 kW (177 HP)	130 kW (177 HP)	130 kW (177 HP)
Torque	400 Nm	400 Nm	400 Nm	400 Nm	400 Nm
Overall length (mm)	7150	7710	8130	8130	8130
Overall width (mm)	2310	2310	2310	2310	2310
Overall height (mm)	3220	3220	3220	3220	3220
Wheelbase (mm)	3750	4150	4350	4350	4350
Maximum permissible weight (kg)	5200	5200	5200	5200	5200
Weight in running order ¹ (kg)	3970	4110	4180	4180	4180
Payload ¹ (kg)	1230	1090	1020	1020	1020
Trailer load manual / automatic transmission (kg)	3500/2500	3500/2500	3500/2500	3500/2500	3500/2500
Seats with three-point safety belts	4	4	4	4	4
Left-hand seating element (mm)	1290/950	1290/950	1700/950	1290/950	1290/950
Right-hand seating element (mm)	590/620	590/620	910/620	590/620	590/620
Rear bed (mm)	2100/1400	2010/850 + 1980/850	2010/850 + 1980/850	2010/850 + 1980/850	2000/1550
Right-hand garage door H/W (mm)	1180/950	1180/950	1180/950	1180/950	1180/950
Price in euro (incl. 19% VAT)	106.000,-	109.000,-	109.000,-	109.000,-	109.000,-

TECHNICAL DATA

Credo Action Iveco Daily

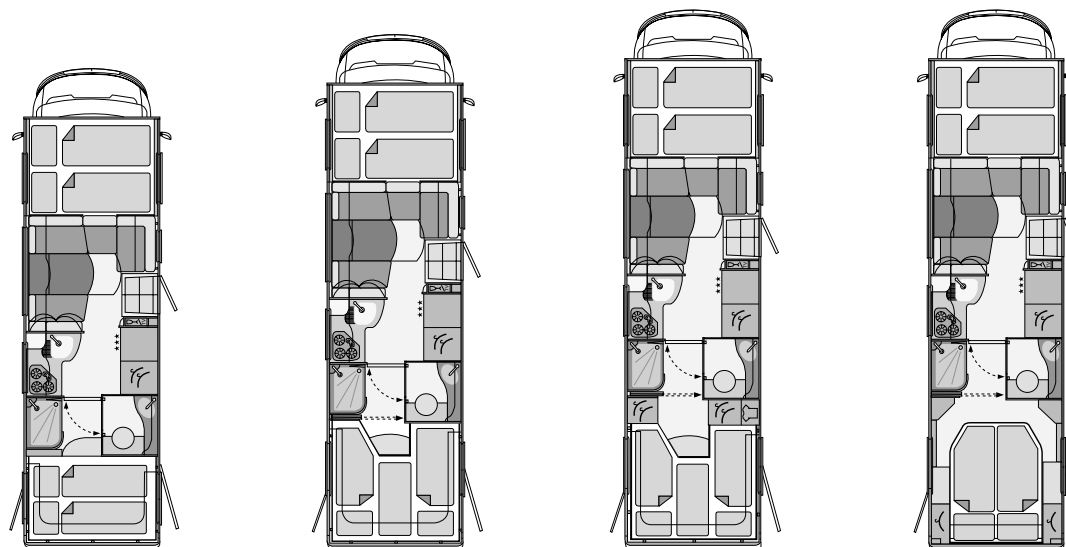

	Credo Action 783 H	Credo Action 843 L	Credo Action 893 LS	Credo Action 893 M
Basic vehicle	Iveco Daily	Iveco Daily	Iveco Daily	Iveco Daily
Chassis	60C18	60C18	60C18	60C18
Engine	4-cylinder	4-cylinder	4-cylinder	4-cylinder
Cubic capacity	3,0 l	3,0 l	3,0 l	3,0 l
Power	130 kW (177 HP)	130 kW (177 HP)	130 kW (177 HP)	130 kW (177 HP)
Torque	400 Nm	400 Nm	400 Nm	400 Nm
Overall length (mm)	7920	8480	8900	8900
Overall width (mm)	2310	2310	2310	2310
Overall height (mm)	3420	3420	3420	3420
Wheelbase (mm)	4350	4750	4900	4900
Maximum permissible weight (kg)	6000	6000	6000	6000
Weight in running order ¹ (kg)	4730	4840	4930	4930
Payload ¹ (kg)	1270	1160	1070	1070
Trailer load manual / automatic transmission (kg)	3500/2500	3500/2500	3500/2500	3500/2500
Seats with three-point safety belts	4	4	4	4
Left-hand seating element (mm)	1920/970	1920/970	1920/970	1920/970
Right-hand seating element (mm)	940/620	940/620	940/620	940/620
Rear bed (mm)	2100/1400	2010/850 + 1980/850	2010/850 + 1980/850	2000 x 1550
Right-hand garage door H/W (mm)	1180/950	1180/950	1180/950	1180/950
Price in euro (incl. 19% VAT)	105.000,-	108.000,-	113.000,-	113.000,-



OPTIONAL EXTRAS - CHASSIS

Fiat Ducato

		PRICE IN EURO incl. 19% VAT	EXTRA WEIGHT in kg
710 003	Chassis-package Credo Emotion (Saving compared to individual order: 565,-) Engine variation 160 Multijet, cubic capacity 3,0 l, 116 kW / 157 HP, 3600 rpm, Torque 400 Nm at 1700 - 2500 rpm Dashboard with noblewood inserts Cab air conditioning Rear steadies, mechanical Radio / CD Cruise control	4.900,-	98
115 035	Engine 160 Multijet, cubic capacity 3,0 l, 116 kW / 157 HP, 3600 rpm, Torque 400 Nm at 1700 - 2500 rpm	2.690,-	50
105 020	Chassis downgrade to 3,5 t maximum permissible weight (only with adequate remaining payload)	0,-	0
105 030	Trailer coupling (increases overall vehicle length by approx. 120 mm)	1.150,-	50
115 055	Automated 6-speed transmission (only for engine 160 Multijet, without ASR)	1.990,-	20
703 513	Dashboard with noblewood inserts	190,-	1
105 073	Cab air conditioning manual	1.350,-	30
700 060	Rear steadies, mechanical	310,-	12
105 330	Aluminium rims 15" (Chassis 3700 / 3500 kg)	790,-	0
105 331	Aluminium rims 16" (Chassis 4250 kg)	890,-	0
115 460	Air suspension rear axle with „raise and lower“ function (only for 4250 kg chassis)	2.990,-	40
710 630	Radio / CD system with cab loudspeakers	650,-	5
105 074	Cruise Control	275,-	2

Iveco Daily

710 001	Chassis package Credo Passion (Saving compared to individual order: 1.590,-) Chassis upgrade 5400 kg permitted laden mass Differential locks for rear axle Cab air conditioning Aluminium rims front axle with widened spur and 225/65R16 tyres Hub caps for steel rims of rear axle with 195/75R16 tyres Radio / CD system with cab loudspeakers	4.690,-	56
---------	--	---------	----

OPTIONAL EXTRAS - CHASSIS

Iveco Daily

		PRICE IN EURO incl. 19% VAT	EXTRA WEIGHT in kg
710 002	Chassis-package Credo Action (Saving compared to individual order: 1.400,-) Chassis upgrade to 6.700 kg permitted laden mass Differential locks for rear axle Cab air conditioning Aluminium rims front axle / Hub caps for steel rims of rear axle Radio / CD system with cab loudspeakers and coachwork	4.190,-	48
125 048	Engine variation Euro 5 , cubic capacity 3,0 l, 125 kW / 170 HP, 3600 rpm, torque 400 Nm at 1250 - 3000 rpm	1.000,-	10
125 038	Chassis upgrade to 5.400 kg permissible weight (instead of 5.200 kg, only for Credo Passion)	1.000,-	0
125 057	Chassis upgrade to 6.700 kg permissible weight (instead of 6.000 kg, only for Credo Action)	1.000,-	0
710 150	Trailer coupling (only available as a factory-fitted option, increases the overall length of the vehicle by approx. 130 mm)	1.450,-	29
700 043	Deduction for ball hitch and bumper cutout for trailer coupling	- 150,-	- 4
700 041	Removable ball hitch (only in combination with trailer coupling)	400,-	5
125 024	Agile automated 6-speed transmission (Trailer load 2.500 kg)	1.690,-	20
710 160	Bi-Xenon headlights with pressure cleaning and additional high-beam headlights (only for Credo Passion in conjunction with rear axle air suspension)	1.490,-	5
125 060	Differential locks for rear axle	850,-	15
710 260	Dashboard with noblewood inserts	495,-	2
703 400	Concorde-steering wheel "Exclusive" (for Credo Passion only)	350,-	0
700 078	Daily jacks with automatic levelling	6.900,-	68
125 070	Cab air conditioning	1.590,-	30
125 503	Fuel tank 160 l (for Credo Action only)	1.590,-	76
702 218	Aluminium rims front axle 50C18 with spur widening and 225/65R16 tyres, hub caps for steel rims rear axle with 195/75R16 tyres (for Credo Passion only)	2.190,-	8
702 219	Aluminium rims front axle 60C18 / wheel trims on rear axle (for Credo Action only)	1.500,-	0
702 235	Stainless steel wheel trims (for Credo Action only)	510,-	8
125 072	Full air suspension rear -and front axle 60C18, 4-canal-system with „Auto-Levelling“ function (only for Credo Action in conjunction with aluminium rims)	8.990,-	64
125 064	Air suspension rear axle of chassis 50C18 with „raise and lower“ function (for Credo Passion only)	3.300,-	25
125 065	Air suspension rear axle of chassis 60C18 with „raise and lower“ function (for Credo Action only)	4.990,-	25
125 067	Additional air suspension front axle (only for Credo Passion in conjunction with aluminium rims or chassis package)	1.990,-	42
125 152	Air suspended luxury cab seats with armrests in living room fabrics, hydraulically suspended and heated (for Credo Action only)	780,-	30
710 630	Radio / CD system with cab loudspeakers (additional loudspeakers in coachwork for Credo Action)	650,-	3

OPTIONAL EXTRAS - COACHWORK

Coachwork

		PRICE IN EURO incl. 19% VAT	EXTRA WEIGHT in kg
710 250	Dinette against driving direction equipped with lapbelts (incl. registration for 6 persons, for Credo Action only)	590,-	30
710 135	Fly screen behind entrance door	390,-	5
710 114	Garage door left hand side 1020 x 560 mm (for Credo Emotion only)	450,-	9
710 110	Garage door left hand side 1100 x 750 mm (for Credo Passion, serial standard Credo Action)	450,-	10
240 999	Rear ladder safety panel	145,-	6
710 360	Electrically operated insulating roller blind for windscreen and 350 W-inverter (for Credo Emotion, serial standard Credo Passion)	950,-	10
710 104	Awning 4.5 m, manual (for Emotion 693 H, Passion 713 H and Action 783 H)	1.050,-	47
710 108	Awning 4.5 m, electrical (for Emotion 693 H, Passion 713 H and Action 783 H)	1.500,-	51
710 105	Awning 5.0 m, manual (for Emotion 763 L and Action 843 L)	1.150,-	50
710 109	Awning 5.0 m, electrical (for Emotion 763 L and Action 843 L)	1.600,-	54
710 112	Awning 5.5 m, manual (for Passion 813 L, LS and M and Action 893 LS and M)	1.250,-	54
710 113	Awning 5.5 m, electrical (for Passion 813 L, LS and M and Action 893 LS and M)	1.700,-	58

Living area / Bedroom

710 208	Pulldown bed instead of overhead cupboards, mattress 1980 x 1320 mm (for Credo Emotion and Credo Passion only)	890,-	35
710 222	Midi roof hatch with lighting in the bedroom instead of standard roof hatch	590,-	6
710 225	Overhead lockers for bedroom sidewise (only Credo Emotion, serial standard for Credo Passion and Credo Action)	790,-	11
710 220	Panoramic roof light in the living room instead of standard Midi roof hatch	650,-	18
710 230	Lowerable table with extra cushion (not for Credo Action)	450,-	8

Kitchen

710 303	Kitchen package (Credo Emotion): 175 l refrigerator/freezer/gas oven (with a grill) combination, dark front, Corisan kitchen worktop with seamlessly integrated sink, extensible water tap	2.290,-	45
710 306	Kitchen package (Credo Passion and Credo Action): 175 l refrigerator/freezer/gas oven (with a grill) combination, dark front, Corisan kitchen worktop with seamlessly integrated sink, extensible water tap	1.990,-	26
710 326	Corisan kitchen worktop with seamlessly integrated sink	990,-	8
710 350	Thermostatically controlled ventilating roof hatch instead of standard roof hatch	320,-	4
710 340	Refrigerator 142 l instead of standard 97 l refrigerator (for Credo Emotion)	790,-	13
710 341	Refrigerator 175 l instead of standard 142 l refrigerator (for Credo Passion and Credo Action)	590,-	2
710 345	Refrigerator 175 l / gas oven (with a grill) instead of standard 142 l refrigerator (for Credo Passion or Credo Action)	1.200,-	18
710 344	Refrigerator 175 l / gas oven (with a grill) instead of standard 97 l refrigerator (for Credo Emotion)	1.500,-	37
710 346	Refrigerator 175 l instead of standard 97 l refrigerator (for Credo Emotion)	890,-	16

OPTIONAL EXTRAS - COACHWORK

Electrical equipment

		PRICE IN EURO incl. 19% VAT	EXTRA WEIGHT in kg
710 501	Electrical power package Credo 1 160 Ah AGM battery (instead of 90 Ah standard battery) Power inverter from 12 V to 230 V, 1.500 W, sine-wave, with remote control and automatic mains priority circuit	1.290,-	34
710 502	Electrical power package Credo 2 2 x 160 Ah AGM batteries (instead of 90 Ah standard battery) with 45-A charger Power inverter from 12 V to 230 V, 1.500 W, sine-wave, with remote control and automatic mains priority circuit	2.190,-	79
710 550	Alarm system	1.150,-	3
700 853	Gas generator 2.500W permanently installed (for Credo Action in combination with gas tank only)	4.750,-	50
700 5403	Interior with LED-lights instead of standard halogen lights	390,-	0
710 545	Reversing camera with shutter and 7" display	950,-	4
710 540	Bifocal reversing double camera with shutter and 7" display	1.495,-	4
710 510	160 Ah AGM battery instead of 90 Ah (not in combination with electric power package)	290,-	26
710 530	Solar panel with approx. 120 W max. power	1.490,-	15
710 520	Power inverter from 12 V to 230 V, 1.500 W sine-wave with remote control and automatic mains priority circuit	1.190,-	8

TV / Radio / Telephone

710 602	Satellite TV system Credo 1 with 22" flatscreen monitor situated to the left of the entrance door underneath glass cabinet , dish 50 x 50 cm, fully automatic orientation digital receiver with 2 CI slots for encrypted programmes, audio playback facility via radio (for Credo Action only)	3.290,-	35
710 601	Satellite TV system Credo 2 with 22" flatscreen monitor situated in the overhead glass cabinet on the right-hand side , dish 50 x 50 cm, electrically lowerable, fully automatic orientation, digital receiver with 2 CI slots for encrypted programmes, audio playback facility via radio (for Credo Emotion and Credo Passion only)	3.790,-	35
710 628	22" flatscreen monitor for bedroom with a second infrared tuner for controlling of receiver in the living area (not for models with H beds)	990,-	15
710 620	Concorde multi-media-system (navigation with touchscreen monitor, integrated radio with DVD-player, CD and MP 3 player, sound system with additional loudspeakers and subwoofer, hands-off installation for bluetooth telephone, bifocal reversing double camera with shutter, for Credo Emotion and Credo Passion only)	3.190,-	14
710 622	Concorde multi-media-system Credo in connection with chassis package (for Credo Emotion and Credo Passion only)	2.890,-	12
710 615	Navigation system with touchscreen monitor, bifocal reversing double camera with shutter and hands-off device for bluetooth telephone	1.990,-	4
710 640	Radio with CD, DVD and MP3 player in living area, sound system with additional loudspeakers and subwoofer (for Credo Action only)	1.490,-	15

OPTIONAL EXTRAS COACHWORK

Water / Gas / Heating / Bathroom

		PRICE IN EURO incl. 19% VAT	EXTRA WEIGHT in kg
710 450	Outside shower in garage (only in combination with garage door on left hand side)	275,-	2
710 469	230 l freshwater tank (for Credo Passion and Credo Action only)	390,-	8
710 470	230 l freshwater and wastewater tank (for Credo Passion and Credo Action only)	690,-	16
700 865	Floor heating in living room and bathroom separately adjustable	1.890,-	10
710 460	Gas alarm for living area	360,-	2
700 890	120 l gas tank with remote switch and level indicator on the control panel display (for Credo Action only)	1.990,-	88
710 440	Gas control with automatic gas bottle switch-over function „Secumotion“	250,-	3
700 830	2100 W air conditioner for living area with 1200 W heating element (roof mounted, extra height of 110 mm for Credo Emotion and Passion)	1.890,-	34
710 410	Heat exchanger using motor temperature to heat the living room area	890,-	4
710 420	SOG toilet roof vent	299,-	1
710 471	Additional toilet cassette with storage unit	200,-	3

Fabrics / Leather / Carpet

03	Soft-look leather upholstery - Sandstone	2.700,-	25
06	Soft-look leather upholstery - Mother of pearl	2.700,-	25
07	Soft-look leather upholstery - Mocha	2.700,-	25
08	Soft-look leather upholstery - Amber	2.700,-	25
62	Soft-look microfibre upholstery - Caramel	0,-	0
63	Soft-look microfibre upholstery - Sandstone	standard	0
66	Soft-look microfibre upholstery - Mother of pearl	0,-	0
69	Soft-look microfibre upholstery - Cappuccino	0,-	0
700 1551	Carpet removable	270,-	8

Other

800 000	Delivery ex works (with comprehensive instruction, handover inspection and approx. 80 l diesel)	690,-	-
---------	--	-------	---

¹ Weight in running order includes: driver (75 kg), full fuel, 40 l freshwater for Credo Emotion, 100 l freshwater for Credo Passion and Credo Action, filled gas bottle, tools, Tire-Fit-System for Credo Emotion, spare wheel for Credo Passion and Credo Action. Weights and dimensions may vary according to special options and accessories fitted. All measurements and weights reflect the specifications at the time of going to press. Deviations by +/- 5 % are possible and permitted.

² Maximum permissible train weight: 5500 kg

SECTIONAL DRAWING

THE CABIN CONSTRUCTION OF THE CONCORDE CREDO

As far as motorhome building is concerned, Concorde stands for perfect insulation and outstanding stability. This is primarily due to the fully bonded Solidtherm® cabin construction with high-density solid PU profiles to eliminate cold spots and the side wall insulation with a 30 millimetre layer of RTM foam. As if that were not enough: sandwich constructions are also used for the floor and intermediate panels, with insulation layers adding up to a total of 60 millimetres, contributing to the as yet unparalleled insulation values achieved by Concorde. Furthermore, the side skirts, the bumpers and the front and rear sections are made of rugged but flexible GRP material. The completely smooth, high gloss, aluminium sandwich wall panels create an automobile impression and aluminium roof profile sections with rain channels reduce soiling of the side walls to ensure that the attractive appearance is maintained over the years.

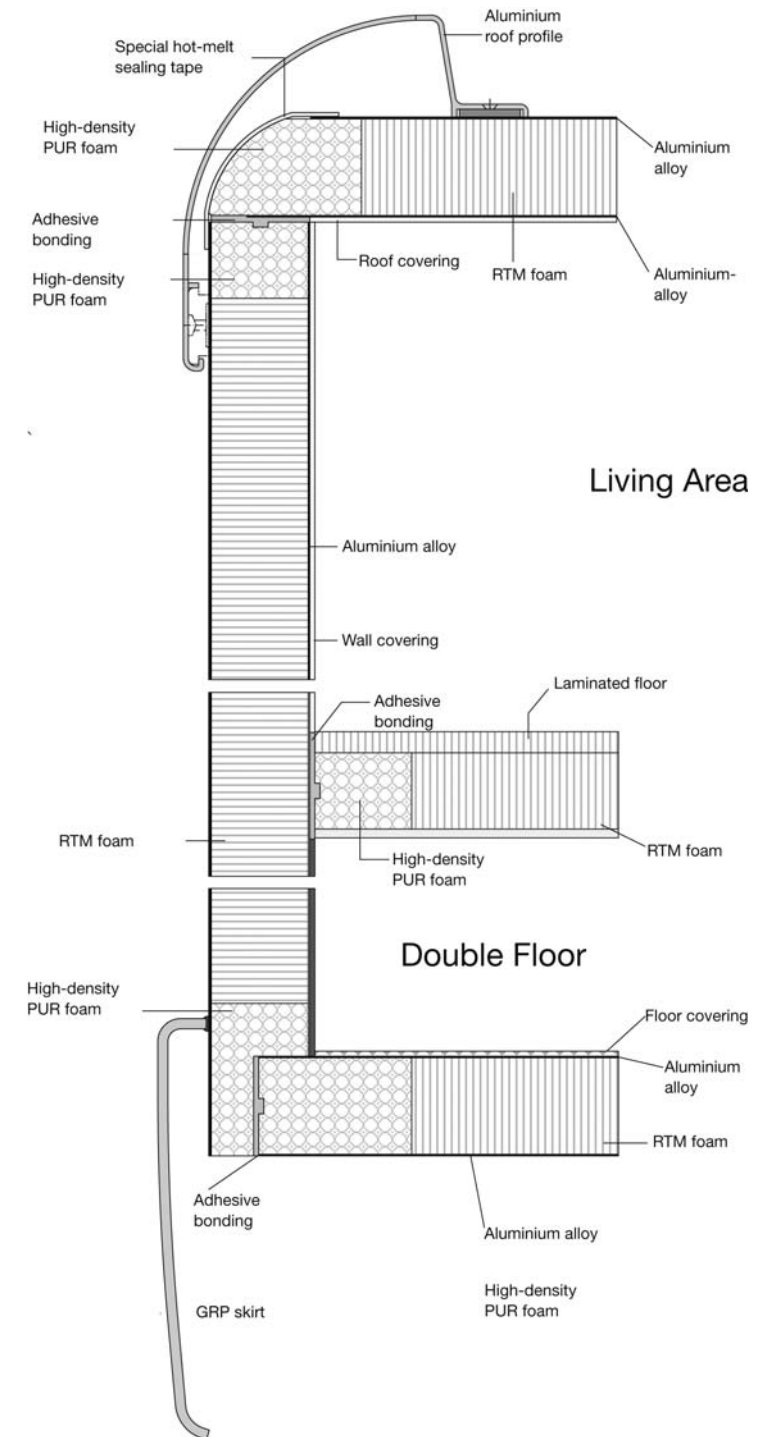

The prices for vehicles and special options apply to vehicles purchased in Germany and are quoted in euros including 19 % value-added German tax. Concorde reserves the right to adjust the quoted prices in the event of an increase in value-added tax between order and delivery. All prices are recommended retail prices ex works. If the vehicle manufacturers change their prices, this will necessitate a corresponding adjustment to the price of the finished vehicle. The prices for special options only apply where these are installed in the factory, assuming that adequate notice has been given. Retrospective installation work incurs additional costs for materials and labour. The quoted prices include the ancillary expenses for delivery of the chassis and acceptance by the German Technical Inspectorate (TÜV). Concorde reserves the right to implement technical modifications as long as the quality of the product remains the same or is improved, and the intended purpose is not adversely affected. This price list supersedes all previous price lists.

Concorde

REISEMOBILE AUS LEIDENSCHAFT

Concorde Reisemobile GmbH

Concorde-Straße 2-4, 96132 Schlüsselfeld-Aschbach

Phone: +49 (0) 95 55 / 92 25-0, Fax: +49 (0) 95 55 / 92 25-44

Website: www.concorde.eu

eMail: info@concorde.eu