

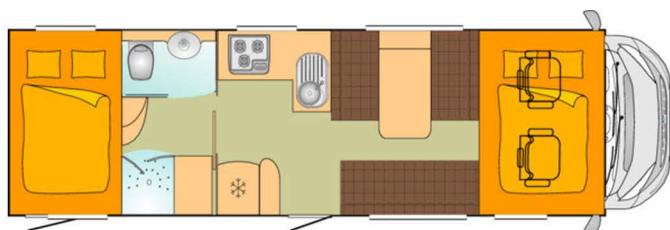

New Bürstner Argos A 747-2 G, 7 berth 8.86metres long Luxury Tag axle Coachbuilt with fixed transverse double bed over garage, fixed double bed over cab and large lounge area - Fantastic family vehicle.

2015 model. Fiat Ducato, Euro 5+ 3.0L 180PS, Heavy Tag axle chassis Plated at 5000kg GVW (£83,460). Comfortmatic Automatic 6 speed gearbox (£1,494). ESP including ASR, Hill holder and traction plus Aluminium trim to dashboard, Instrument panel with chrome bezels, Leather steering wheel and gear knob, Driver & Passenger airbag, Electrically adjustable and heated mirrors, Six x 16" Alloy wheels in Black polish design (£1,496). Remis integrated cab blinds (£491). Hartal Habitation door with integrated window, waste bin and fly screen, Central locking to habitation door (£204). Rear camera with 7" colour monitor. Air-conditioning upgrade to automatic climate control (£259). Alde wet gas and electric heating system with heat exchanger for travel heating. Additional water tank 130 litres (total water capacity 250 litres) (£262). Dometic Tec Tower - 160litre fridge freezer with gas oven and grill. Rear corner steadies. Outside shower with mixer tap (£252). Exterior gas point (£188). Upholstered in Havana leather (£1,415). Carpets to cab and living area. Rear ladder mounted to rear wall (£273). Roof rails (£512).

(In stock) £90,306.00 Including options



Layout Diagrams are not to scale

**Please telephone our sales team
on 02392 674820
for further information**

MOTORHOME SPECIFICATION:

MANUFACTURER: Bürstner
MODEL: Argos A 747-2 G
BERTHS: 7
MAKE: Fiat Ducato
ENGINE: Euro 5+ 3.0L 180PS
TRANSMISSION: Comfort Matic (Automatic 6 Speed)
Three Point Seat Belts in Living Area: 4
Length approx. 8.86m
Width approx. 2.3m
Height approx. 3.25m
GVW: 5000 kg

It is possible to fund this motorhome from 1 year up to 10 years (120 mths). Details available on request.

blackhorse
CARAVAN & MOTORHOME FINANCE



Whilst every effort has been made to check the accuracy of the information above, some errors in compiling this information may have occurred. You are therefore strongly advised not to rely on the information provided in respect of the above vehicle, and to examine the vehicle to check the accuracy of the information supplied before deciding to purchase the vehicle as described above. Your statutory rights as a consumer are not affected by this statement.

Southdowns Motorhome Centre, Painter Close, Anchorage Road, Anchorage Park, Portsmouth, Hampshire PO3 5UH

(Version-a-15-05-15)

Tel: 02392 674820 Fax: 02392 674821 Web: www.southdownsmotorcaravans.co.uk