



A brand new improved model range for 2015 with innovative Alu-tech build technology and new Peugeot facelifted cab.

**New Bailey Approach Autograph 740 Motorhome. 4 berth 7.45metres long low profile with rear fixed French bed and twin side sofas. Massive specification at a "great price"**

**2015 Model. "New look" Facelifted** Peugeot Boxer 2.2 HDI 130 bhp. 6 speed manual gearbox, 2 seatbelts in total. **New** Fully winterised Twin floor construction with AL-KO AMC Ultra-low profile lightweight chassis plated at 3500kgs GVW. Driver and passenger airbags, Twin swivel adjustable cab seats, Cab air-conditioning, Cruise control, Remote Central locking, Electric heated and adjustable wing mirrors, Radio CD player, **New** Graphite metallic cab with colour coded bumpers, **New** 'Polar white' body shell colour and co-ordinating graphics scheme. **New** aero dynamic & aesthetically enhanced front and rear body shell profiles, Remis concertina cab blinds. **Alu-Tech body shell** supplied with 6-year body shell integrity guarantee extendable to 10 years at extra cost. **New** furniture design in Bailey 'Walnut' finish and upholstered in 'Piccadilly' soft furnishings option (£199) and **New** 'Bamboo' finish high impact scratch resistant floor vinyl. **New** Banner 105ah leisure battery with dedicated under floor storage locker and provision for additional battery. **Kitchen equipment** - Dometic 117 litre fridge/freezer, **New** Thetford Caprice 'anti rattle oven', **New** Thetford dual fuel hob with electric hotplate and 3 burner gas hob, Stainless steel 700 watt microwave. 100litre fresh water tank with Whale auto fill system and 100litre wastewater tank. **New** Alde Hydronic Compact 3020 programmable wet radiator-heating system with combined water heating, Dual fuel 3.4kw gas and 3kw electric with 'user friendly' control panel. **Additional 2015 standard features** - New look cab, daytime running lights, Dab radio with Bluetooth and USB connectivity, Tyre pressure sensors and Brake pad monitoring system.

**£46,414.00 (In stock)**

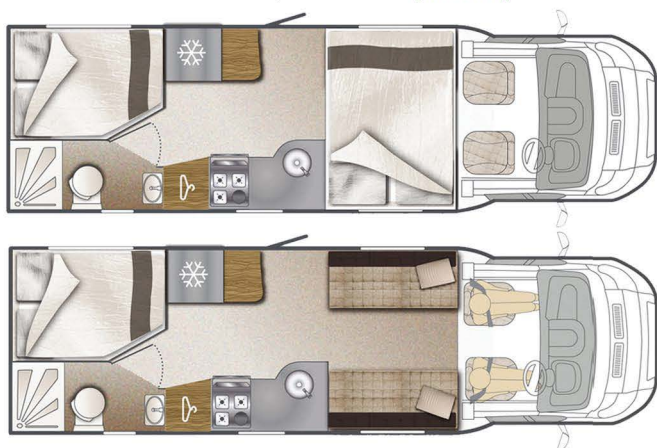

**MOTORHOME SPECIFICATION:**

MANUFACTURER: Bailey  
MODEL: Approach Autograph 740  
BERTHS: 4  
MAKE: Peugeot Boxer  
ENGINE: 2.2L Hdi 130bhp  
TRANSMISSION: 6-Speed Manual  
Length (approx.) 7.45m  
Height (approx) 2.785m  
Width (approx) 2.412m  
GVW: 3500kg

It is possible to fund this motorhome from 1 year up to 10 years (120 mths). Details available on request.



**blackhorse**  
CARAVAN & MOTORHOME FINANCE



Whilst every effort has been made to check the accuracy of the information above, some errors in compiling this information may have occurred. You are therefore strongly advised not to rely on the information provided in respect of the above vehicle, and to examine the vehicle to check the accuracy of the information supplied before deciding to purchase the vehicle as described above. Your statutory rights as a consumer are not affected by this statement.

Southdowns Motorhome Centre, Painter Close, Anchorage Road, Anchorage Park, Portsmouth, Hampshire PO3 5UH

(Version-a-27-08-15)

Tel: 02392 674820 Fax: 02392 674821 Web: [www.southdownsmotorcaravans.co.uk](http://www.southdownsmotorcaravans.co.uk)