

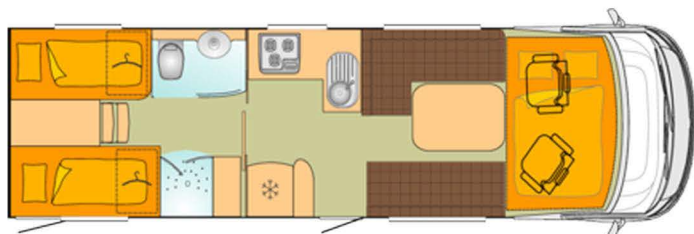

**Used Burstner Elegance i 810 G Motorhome, 4 berth, 9.2 metres long Luxury Tag axle A class with fixed rear twin single beds over garage and electric drop down double bed over cab.**

**2011 Facelifted model.** Fiat Ducato 40 maxi chassis, 3.0 Multijet 160PS 6 speed Comfortmatic automatic gearbox, Plated at 5000kg GVW, 16,431 miles. Right hand drive. Cab air conditioning, Driver and passenger Airbags, Twin cab doors with Electric Windows, Electric mirrors, Cruise control, Pioneer CD/Radio. Reversing camera, Snooper S7000 Sat Nav, Gemini alarm, Remis Integrated cab blinds, LED daytime running lights, and Alloy wheels. Large electric drop down double bed over cab with Access ladder, Privacy curtains and Small Heki roof light. Large L shape lounge with two additional seat belts, Twin swivel front cab seats, Large adjustable dining table, Large side sofa, Upholstery in Strada leather, Removable fitted carpets, Large Skylight, Glass cabinet by entrance door, TV cabinet with roller shutter doors, TV bracket complete with TV/ DVD, Aerial/power points, Multi aspect LED mood lighting throughout and Habitation stereo speakers. Large L shape kitchen with Thetford Spinflo 3 gas burner hob unit, Extractor fan, Dometic TEC tower – (fridge with separate freezer and gas oven/grill) Stainless steel sink with mixer tap, Integrated drainer and glass hinged cover. Rear dividing sliding partition door to rear living area/ bedroom opening up separate shower unit, Roller shutter door to washroom with Small Heki roof light, Thetford cassette toilet, Warm water radiator and Vanity unit with washbasin. Large wardrobe with lower chest of drawers. Alde wet central heating system with heat exchanger. Remote switched gas regulator. Rear bedroom with twin single beds, integrated steps, Slide out middle bed infill to make into large double with integrated slide out access ladder, Large under bed storage units including drawers and wardrobe. TV with DVD, Small Heki roof light over beds. Hartal habitation door with flyscreen door. Vehicle finished in Silver metallic paint. Electric step. Large garage doors on both sides of vehicle. Omnistor 6.0 metre roll out awning. Satellite dish with Maxview, External TV/Satellite plugs. External shower point. Tow Bar and Electrics. (YX11CYJ – 03/2011)

**£74,995.00 (In stock)**



Layout Diagrams are not to scale

#### MOTORHOME SPECIFICATION:

MANUFACTURER: Burstner  
MODEL: Elegance i 810 G  
BERTHS: 4  
MAKE: Fiat Ducato  
ENGINE: 3.0L 160PS  
TRANSMISSION: Comfort Matic (Automatic 6 Speed)  
Three Point Seat Belts in Living Area: 2  
Length approx. 9.2m  
Width approx. 2.3m  
Height approx. 2.85m  
GVW: 5000 kg

It is possible to fund this motorhome from 1 year up to 10 years (120 mths). Details available on request.



**blackhorse**  
CARAVAN & MOTORHOME FINANCE



Whilst every effort has been made to check the accuracy of the information above, some errors in compiling this information may have occurred. You are therefore strongly advised not to rely on the information provided in respect of the above vehicle, and to examine the vehicle to check the accuracy of the information supplied before deciding to purchase the vehicle as described above. Your statutory rights as a consumer are not affected by this statement.

Southdowns Motorhome Centre, Painter Close, Anchorage Road, Anchorage Park, Portsmouth, Hampshire PO3 5UH

(Version-a-25-6-14)

Tel: 02392 674820 Fax: 02392 674821 Web: [www.southdownsmotorcaravans.co.uk](http://www.southdownsmotorcaravans.co.uk)