

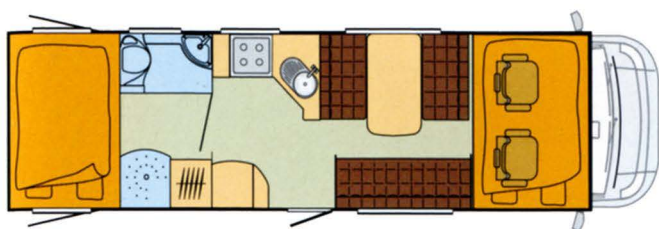

Used Burstner Argos A 747-2 Motorhome. 6 berth, 8.86metres long Tag axle Coachbuilt with fixed transverse double bed over garage, fixed double bed over cab and large lounge area.

Fiat Ducato 3.0L 160PS Multijet diesel engine. 6-Speed manual gearbox. 28,834miles, Tag axle, Alko chassis plated at 5000kgs GVW. Right hand drive. Cab air conditioning, Electric windows, Electric mirrors, Remote central locking, ASR, Driver and passenger airbags, CD/radio, wood effect dashboard and rear camera. Fixed double bed over cab with large skylight, privacy curtain and access ladder. Large lounge area comprising wooden partition sliding/folding door to front cab area, large double dinette with 4 additional seatbelts, dinette table, large side sofa, Fabric upholstery, overhead storage cabinets and large Heki roof light. TV cupboard with roller shutter door and slide out TV bracket. Large L shape kitchen area with Dometic full oven, separate grill and 4 burner gas hob, Extractor fan, Dometic fridge with separate freezer, Stainless steel sink with integrated drainer and cover. Alde wet central heating system. Divided washroom with opening door creating rear division to bathroom/bedroom area with Washbasin, Radiator, Small Heki, Thetford cassette toilet. Separate shower enclosure with roof vent and shower screen door. Rear Transverse double bed with Integrated steps to rear bed, overhead storage cabinets and roof light. Status aerial, Hartal habitation door. Large rear garage with twin access doors. Roof rails, 4 x Bike rack and electric step. (DX57JXJ -/2007)

£43,995.00 (In stock)



Layout Diagrams are not to scale

**Please telephone our sales team
on 02392 674820
for further information**

MOTORHOME SPECIFICATION:

MANUFACTURER:	Burstner
MODEL:	Argos A 747-2
BERTHS:	6
MAKE:	Fiat Ducato
ENGINE:	3.0L 160PS
TRANSMISSION:	6 Speed manual
Length (approx.)	8.86m
Width (approx.)	2.3m
Height (approx.)	3.25m (Excluding Additional Roof mounted equipment)
GVW:	5000 kg

It is possible to fund this motorhome from 1 year up to 10 years (120 mths). Details available on request.



Whilst every effort has been made to check the accuracy of the information above, some errors in compiling this information may have occurred. You are therefore strongly advised not to rely on the information provided in respect of the above vehicle, and to examine the vehicle to check the accuracy of the information supplied before deciding to purchase the vehicle as described above. Your statutory rights as a consumer are not affected by this statement.

Southdowns Motorhome Centre, Painter Close, Anchorage Road, Anchorage Park, Portsmouth, Hampshire PO3 5UH

(Version-a-21-09-15)

Tel: 02392 674820 Fax: 02392 674821 Web: www.southdownsmotorcaravans.co.uk