

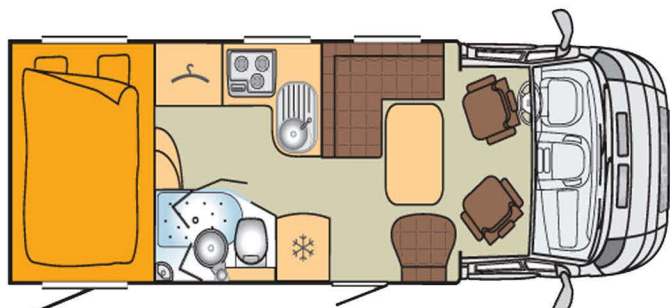

*Used **Burstner Solano t 697 Motorhome**, 3 berth, 6.97 metres long low profile with L shape front lounge and fixed rear transverse double bed over garage.*

Fiat Ducato 2.3L 130PS Multijet diesel engine. 6-Speed manual gearbox. 16,100miles, Chassis plated at 3500kgs GVW. Right hand drive. Cab air conditioning, ASR. Driver and passenger airbags, Electric windows, Electric mirrors, Central locking, Blaupunkt CD/Radio. Large skylight over cab. Front Lounge comprising of twin swivel front cab seats, L-Shape sofa with 2 additional seatbelts, side seat, fabric upholstery, central adjustable dining table, overhead storage cabinets and slide out TV bracket. L-Shape kitchen with stainless steel sink and cover, draining board, 3 burner gas hob, Dometic TEC tower – fridge/freezer with oven/grill, overhead storage cabinets and roof light. Wardrobe. Truma Combi gas and electric blown air heating. Wetroom with Thetford cassette toilet, Washbasin with vanity unit, shower and roof light. Privacy curtain to fixed rear transverse double bed, overhead storage cabinets and small rooflight. Hartal habitation door, Fiamma 3 bike rack and Omnistor roll out awning. (LA60FTE-/-).

£41,995.00 (In stock)



Layout Diagrams are not to scale

**Please telephone our sales team
on 02392 674820
for further information**

MOTORHOME SPECIFICATION:

MANUFACTURER: Burstner
MODEL: Solano t 697
BERTHS: 3
MAKE: Fiat Ducato
ENGINE: 2.3L 130PS Multijet Diesel
TRANSMISSION: 6 speed manual gearbox
Three Point Seat Belts in Living Area: 2
Length approx. 6.97m
Width approx. 2.3m
Height approx. 2.85m (Excluding Additional Roof mounted equipment)
GVW: 3500 kg

It is possible to fund this motorhome from 1 year up to 10 years (120 mths). Details available on request.

blackhorse
CARAVAN & MOTORHOME FINANCE



Whilst every effort has been made to check the accuracy of the information above, some errors in compiling this information may have occurred. You are therefore strongly advised not to rely on the information provided in respect of the above vehicle, and to examine the vehicle to check the accuracy of the information supplied before deciding to purchase the vehicle as described above. Your statutory rights as a consumer are not affected by this statement.

Southdowns Motorhome Centre, Painter Close, Anchorage Road, Anchorage Park, Portsmouth, Hampshire PO3 5UH

(Version-a-29-09-15)

Tel: 02392 674820 Fax: 02392 674821 Web: www.southdownsmotorcaravans.co.uk