



Used Burstner Nexxo t 660 Motorhome, 3 berth, 6.71metres long low profile with fixed rear French bed.

Ford Transit 350L 2.2 diesel. 5 speed manual, Front wheel drive, 13,341miles, Plated 3500kgs GVW, **1 owner**, Chassis pack (Cab air conditioning, electrically operated mirrors and passenger airbag) Remote central locking, Cruise control, Electric windows, Gemini alarm system, Ford CD/ radio. Lounge with Twin swivel front seats, Half dinette with 2 additional seatbelts, Side sofa, Upholstered in Pacific Motion cloth, Dinette table with extension leaf, Large Heki roof light over lounge, Rear sound speakers, TV cabinet with roller shutter door with slide out TV bracket, and Storage shelf over cab. L shape kitchen with Stainless steel sink, Separate draining board, Dometic 3 burner gas hob, Dometic 104litre fridge freezer and Dometic oven and grill. Truma Gas blown air heating. Wet room with Thetford cassette toilet, Washbasin with vanity unit, Shower screen partition doors, Wooden footboard and Small Heki roof light. Privacy pleated blinds to rear French bed with Midi Heki roof light and Bedspread. Large wardrobe and Tall shelved storage unit. Flyscreen door. Electric step. Status aerial. Fiamma 3.5metre awning. Fiamma 2 bike rack. Removable pleated blinds to cab. Fiamma security lock to hab door. Cab window wind deflectors.

(YX59AYW - 11/2009)

£32,995.00 (In stock)

Layout Diagrams are not to scale

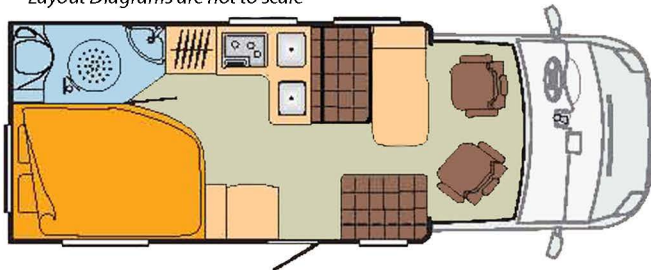

**Please telephone our sales team
on 02392 674820
for further information**

MOTORHOME SPECIFICATION:

MANUFACTURER: Burstner
MODEL: Nexxo t 660
BERTHS: 3
MAKE: Ford Transit 350 L
ENGINE: 2.2L Diesel
TRANSMISSION: 5 Speed Manual
Three Point Seat Belts in Living Area: 2
Length app. 6.71m
Width app. 2.3m
Height app. 2.76m
GVW: 3500 kg

It is possible to fund this motorhome from 1 year up to 10 years (120 mths). Details available on request.



blackhorse
CARAVAN & MOTORHOME FINANCE

Whilst every effort has been made to check the accuracy of the information above, some errors in compiling this information may have occurred. You are therefore strongly advised not to rely on the information provided in respect of the above vehicle, and to examine the vehicle to check the accuracy of the information supplied before deciding to purchase the vehicle as described above. Your statutory rights as a consumer are not affected by this statement.

Southdowns Motorhome Centre, Painter Close, Anchorage Road, Anchorage Park, Portsmouth, Hampshire PO3 5UH

(Version-b-20-5-13)

Tel: 02392 674820 Fax: 02392 674821 Web: www.southdownsmotorcaravans.co.uk

