

Discover the world.  
In complete comfort.



**Truma's World of Camping 2009**

Comfort on the move



## Discover the world. In complete comfort.

You know the feeling – the anticipation, the excitement, the feeling that it won't be long and soon you'll be getting away from it all. Seeing new places and meeting new people. Out in the country, surrounded by wonderful scenery. And to make sure that your trip is even more enjoyable, you will find that our high-tech products have been designed with your ultimate camping experience in mind. So why not take us along?



## Product overview

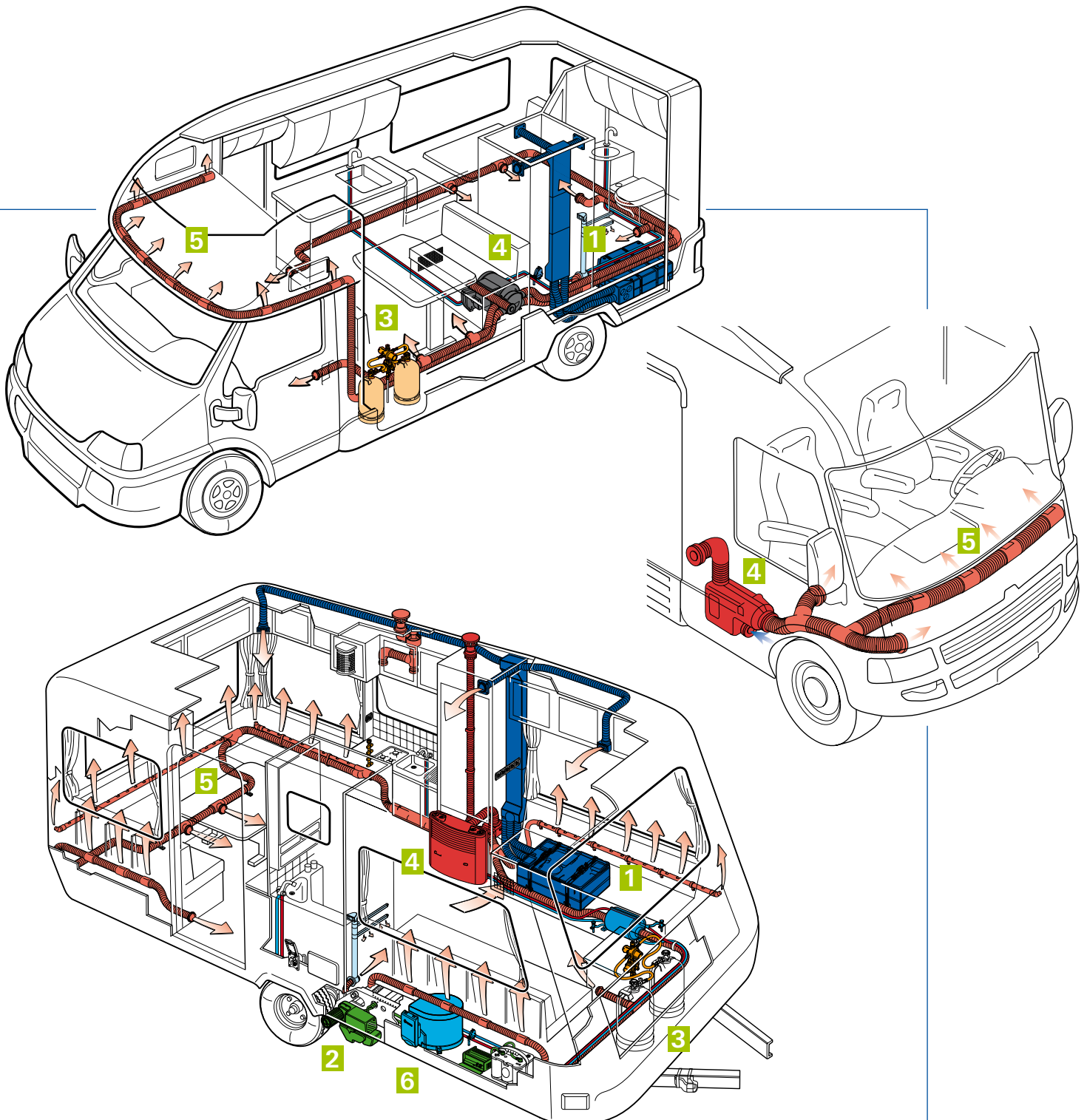



## Product overview

### Our products at a glance

	Page		Page
<b>1 Air conditioning systems</b>		<b>4 Heating systems</b>	
Saphir compact	5	Front case with flame effect	18
Saphir comfort	5	Ultraheat	18
Saphir vario	5	Trumatic S	18
		Combi 4/Combi 6	20
<b>2 Manoeuvring systems</b>		Combi D 6	20
Mover SE	11	Trumatic E	21
Mover TE	11		
Mover S	11	<b>5 Air technology</b>	
<b>3 Energy systems</b>		Fans	22
SecuMotion	12	Airmix	22
DuoComfort	13	Truma air distribution	23
DuoControl	13	Towel dryer	23
High-pressure hoses	13		
DuoC remote indicator	14	<b>6 Water Heating</b>	
Gas remote switch	14	Electric boiler	24
TG 1000 sinus	14	Therme	25
power inverter	15	Boiler	25



## Comfort means always having an ideal climate.

With Truma you will never need to sweat. As of this summer, your holiday enjoyment will be even more complete, with our Saphir air conditioning systems. Our systems cool and dehumidify the air in your vehicle, turning the interior space into a veritable oasis of comfort. Whatever type of climatic control you require, Truma has just the solution.



## Air conditioning systems



### Quiet

Pleasantly quiet noise level

### Compact

Ideal for installing in the false floor (Saphir vario)

### Popular

Elected "Best brand" (in a "promobil" readers survey) among the lightest and quietest air conditioning systems of their class, for the third time in a row

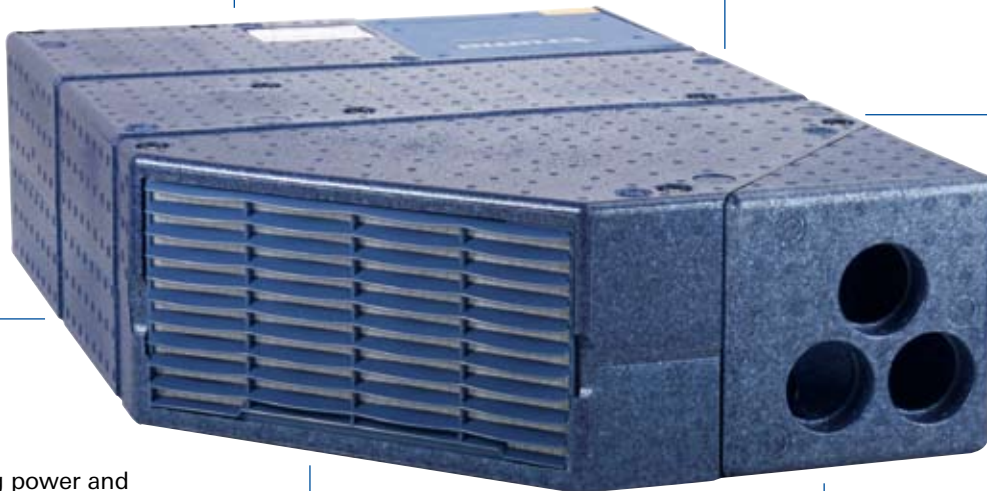

Light  
Only 27 kg  
(Saphir vario)

### Powerful

High cooling power and variable fan levels

Saphir vario

### Clean

All Truma air conditioning systems are fitted with pollen filters as standard

### Flexible

Three high-performance air outlets



TG 1000 sinus power inverter

### Independent cooling

Together with the TG 1000 sinus power inverter, the system runs completely independently, powered either by the battery when stationary (Saphir vario) or by the vehicle alternator when driving (Saphir vario and Saphir compact). See page 15 for more information.



## Air conditioning systems

### Saphir compact

**Small, light and low energy.** The less weight, the better, and at only 20 kg, the Saphir compact is unique. The unit's low energy consumption makes it ideal for use in any camp site in Europe. The extra-quiet Sleep function adds

a whole new dimension of cooling comfort.

- For vehicle lengths of up to 5.5 m
- Low energy
- Also cools while driving, when operated by the TG 1000 sinus power inverter



Saphir compact

### Saphir comfort

**Small, quiet, and high performance.** The Saphir comfort's high power means that it is able to provide sufficient cooling, right through to the last corner, for vehicles over 5.5 m in length. At only 24 kg, it sets new standards in its class.

Enjoy all the benefits and the confidence of knowing you have a test winner on board.

- For vehicles of around 5.5 m and over
- High performance



Saphir comfort



### Saphir vario

**The intelligent automatic air conditioning system.** The only air conditioning system in the world which, thanks to its installation height of only 20 cm, can be installed in the false floor of a variety of motorhomes. The three variable power levels and automatic voltage

recognition\* ensure a high level of comfort. Together with the Truma TG 1000 sinus power inverter, you can have cool air powered by the vehicle alternator while you are driving, or running on the battery when stationary.

\* with the TG 1000 sinus power alternator



Saphir vario

#### Technical Data

	Saphir compact	Saphir comfort	Saphir vario
<b>Operating voltage</b>	230 V ~, 50 Hz	230 V ~, 50 Hz	230 V ~, 50 Hz
<b>Power consumption</b>	230 V: 2.8 A 12 V: 55 A	230 V: 4.2 A 12 V: -	230 V: 1.7 A/3 A/4.4 A 12 V: 35 A/62.5 A
<b>Cooling power</b>	1,800 W	2,400 W	600 W/1,500 W/2,000 W
<b>Coolant</b>	R 407C	R 407C	R 407C/R 134a
<b>Weight</b>	20 kg	24 kg	27 kg
<b>Dimensions L x W x H</b>	560 x 400 x 290 mm	710 x 400 x 290 mm	800 x 550 x 200 mm

## All campers are different.

And the same applies to camper vans. Which is why all Truma air conditioning systems have been designed for flexible installation, so you can fit it just the way you need it. Whatever the external climatic conditions may be, the air distribution system ensures that the conditions in your vehicle are always pleasant, so that you can enjoy every day of your holiday in complete comfort.



## Air conditioning systems

### Air conditioning is not just a matter of temperature control.

Basically, a [pleasant in-vehicle climate](#) is down to three factors: temperature, humidity, and air speed.

As far as [temperature](#) is concerned, it would be an oversimplification to say that the cooler the better. What is important is to find the right relation between the ideal felt temperature on the inside and the actual temperature on the outside.

Another decisive factor is the [humidity of the air](#). The more moisture there is in the air, the more uncomfortable it is.

Then there is the important point that people tend to be sensitive to [draughts](#). We find it unpleasant to be exposed to rapid air movements, particularly when it is cooler than the surrounding air and emanates from the same constant point.

This means that an ideal air conditioning system must be able to provide an adequate supply of cool air to the vehicle's interior, irrespective of the temperature outside, for us to feel comfortable. It should be as free as possible of local draughts, and its humidity should be as low as possible.

[Ideal climate control from Truma](#). Saphir air conditioning systems are designed especially for use in your mobile home. These light and compact air conditioners are mounted in the vehicle's interior, where they are protected from the effects of the weather. They will fit well into virtually any storage space.

If installed in the floor, the vehicle will have a lower centre of gravity. This will enhance the performance of your motorcaravan or caravan. The closed cold circuit means that the system is maintenance free. Pollen filters are fitted as standard. The noise level is pleasantly low, both inside and outside.

Truma air conditioning systems first cool, clean and dry the air, which is then distributed evenly via several adjustable outlets. The air distribution pattern can be configured to suit your requirements and those of your vehicle interior.





## Air conditioning systems

### Choose your own climate.

You should base your choice of air conditioning unit on the following considerations:

- The larger the internal volume of your vehicle,
- The warmer and more humid the outside climate, and
- The less shade there is on the vehicle,

the higher the cooling performance that you will require to ensure a pleasant climate inside your vehicle.

You can select between three systems, depending on your vehicle and individual air conditioning requirements:

- Saphir compact
- Saphir comfort
- Saphir vario

By employing custom air distribution you will be able to enjoy your ideal personal climate inside your vehicle. It is an easy matter to direct the cool air just where you want it, whenever you want it!

**Eco.** Cooling for a pleasant indoor climate. This solution is ideal for pre-cooling your vehicle so that you can be sure of a good night's sleep even on a warm summer night.

**Comfort.** Refreshing coolness wherever you are. The air is emitted upwards and then sinks naturally to the floor. This means that it is able to cool the vehicle interior without any draughts. Moreover, the air is distributed in three different directions. You can feel the freshness all over the interior. For even more climate comfort.

**Luxury.** For maximum comfort during the day and during the night. The system allows you to individually supply cool air to the living and sleeping areas. With the adjustable outlets, you are free to decide how much cool, clean air you wish to have in which area.

**Vario.** Individual installation. Installation in the false floor means you can save even more space. Again, you will enjoy the full benefit of the air's natural current properties.

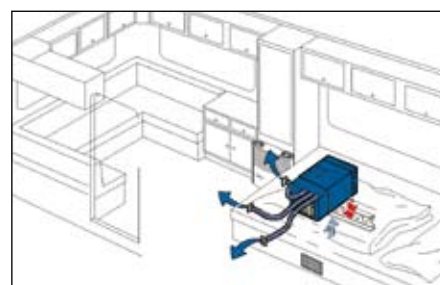

Eco-solution

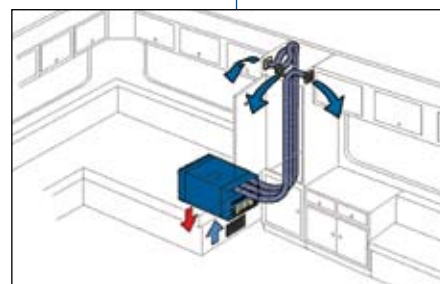

Comfort-solution

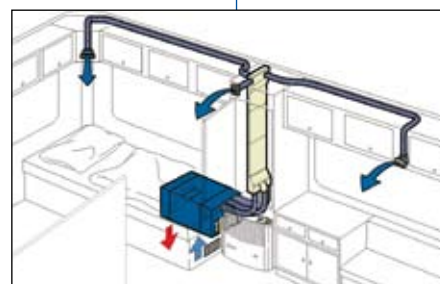

Luxury-solution

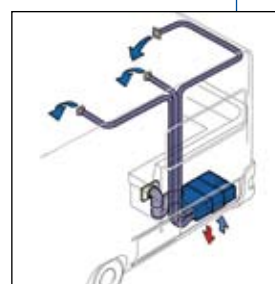

Vario-solution

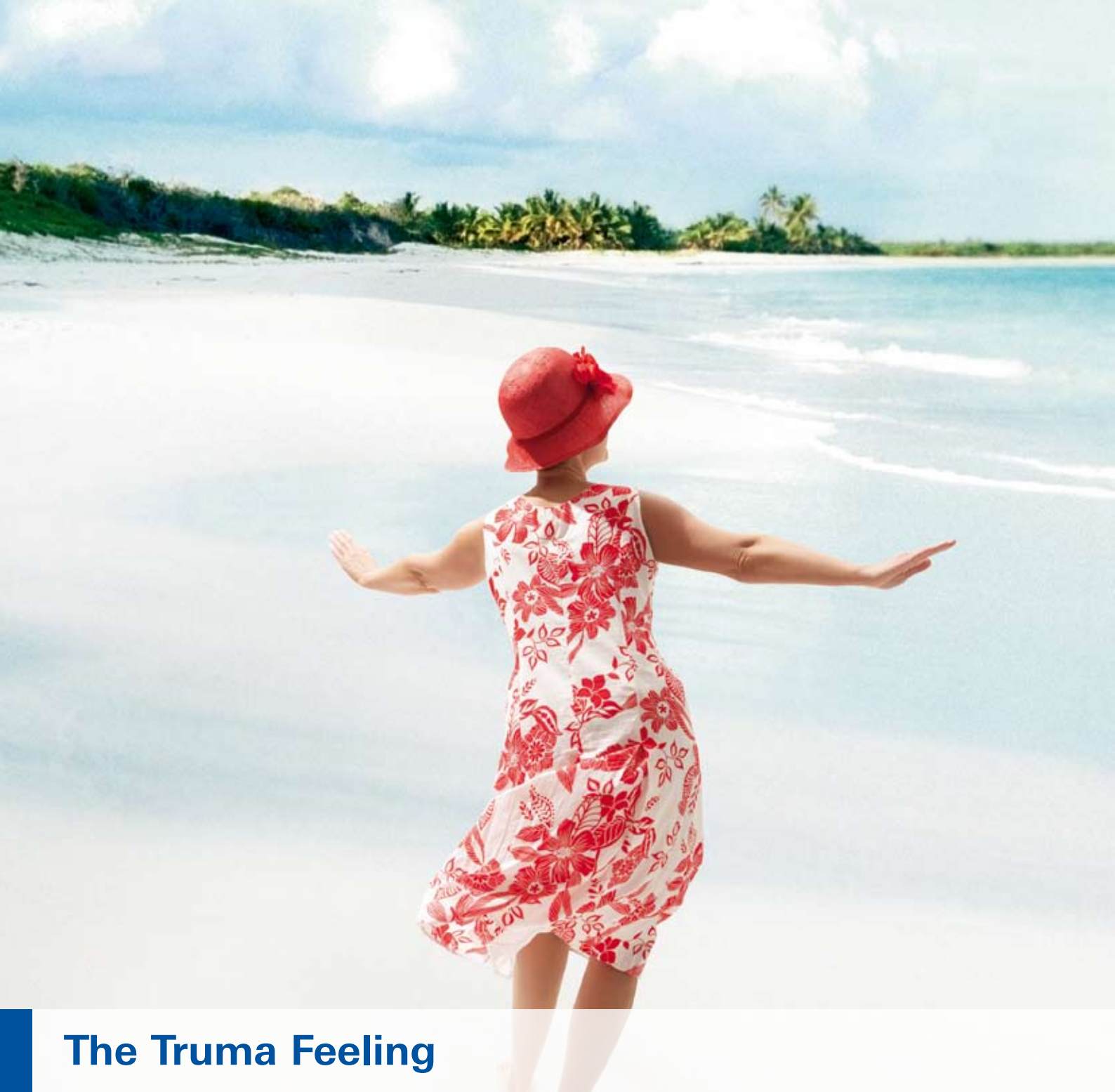

## The Truma Feeling

*By campers for campers.*

At Truma, we all love camping. And you can tell it from all of our products. Right down to the last detail, they are designed by campers, for campers. With all the features you need, well designed, and easy to use. We do our utmost to ensure that your camping holiday is as unencumbered as possible. So leave your worries at home, and choose Truma.





### [At one with the environment.](#)

Like all campers, we love the countryside. Which also means that we attach great importance to treating the environment properly. We have therefore decided to focus on liquid gas as a clean energy source. The aim of all our innovations is that they can be employed on sustainable and environmentally sound products, which help to ensure that we will be able to continue enjoying unspoilt natural beauty for generations to come.

## Comfort is when you can get to the most beautiful locations.

Using a Truma Mover, you can manoeuvre your caravan simply and precisely to its location by remote control, even in difficult locations. Truma Movers are highly resistant to rolling back when used on slopes. There is simply nothing better than the original.



## Manoeuvring systems

### The Mover family

#### The original from Truma.

You can sense the progress that experience brings. You can perform coupling and manoeuvring with millimetre accuracy, as well as smooth starting and halting, even on slopes, thanks to the Durasoft drive. As specialists in manoeuvring systems, we are able to fulfil the highest demands in terms of safety, quality, and comfort.

#### Tyre-friendly engineering

Even when turning and in wet conditions

#### Durasoft drive

For millimetre accuracy and safe manoeuvring, even on slopes

#### Soft start and soft stop

For smooth starting and halting

#### Safety

Automatic switch off for optimum protection of drive and battery

#### Light weight

The lightest in its performance class – up to 50 % lighter than comparable designs (Mover TE)

#### NEW: The Mover PowerSet\*.

This unique, optimally configured set comprises the Calira charger and OPTIMA® battery. The benefits to you: up to 50 % longer moving time. More than double as fast charging time. Lowest self-discharge and 20 % weight reduction with equal effective battery capacity.



Calira charger and OPTIMA® battery

\* Only available in conjunction with a Mover S/SE or TE.



engaged



disengaged





## Manoeuvring systems

### Mover SE

Comfortable manoeuvring with single-axle caravans.

This luxury manoeuvring system requires no external forces. It is engaged at the touch of a button and is henceforth in place. Manoeuvring doesn't get any easier than this.

- Electrically engaged or disengaged by remote control
- Weighs 33 kg: up to 15 % lighter than comparable manoeuvring systems
- For use with single-axle caravans up to 1,800 kg



Mover SE/TE

### Mover TE

Powerful manoeuvring with double-axle caravans.

With the Mover TE, you can even manoeuvre heavyweights up to 2,250 kg into position with a touch of the remote control's button. The sophisticated rotational mechanism means that the tyres are not subjected to excessive wear, even when turning!

- Electrically engaged or disengaged by remote control
- Weighs 33 kg: up to 50 % lighter than comparable manoeuvring systems
- For use with double-axle caravans up to 2,250 kg



### Mover S

Manoeuvring in limited spaces.

Manoeuvring your caravan into difficult, cramped positions suddenly becomes child's play with the Mover S. You just manually engage the two sides of the drive, and then you can direct your caravan by remote control.

- Extremely easy manual engagement or disengagement from one side
- Remote control manoeuvring
- Weighs 35 kg: up to 15 % than comparable manoeuvring systems
- For use with single-axle caravans up to 1,800 kg



Mover S

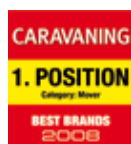

Manoeuvring with the Truma Mover

means: **Safe** stability even on slopes. Does not roll back, even on steep slopes.

## Carefree and flexible all over Europe.

Regulators, valves, and high-pressure hoses from Truma are the best choice if you require the comforts of gas throughout Europe. With no connection problems and of course with the highest safety standards – with Truma everything is fully under control.



## Energy systems

### Energy from A to Z

**The new standard.** Truma engineering defines the new reference class for energy comfort in mobile homes. The required regulators and valves are easy to install and will fit into even the most cramped cylinder box.

Safety is everything. Which is why all Truma gas pressure regulators and changeover valves are DVGW tested and fulfil all European guidelines. Which means you are perfectly equipped for any location in Europe.

For detailed information on gas supplies in Europe, see

[www.truma.com](http://www.truma.com)

### SecuMotion

**Safety in movement.** The innovative gas pressure regulator SecuMotion represents a safe and convenient gas supply, even when you are on the move. With the integrated gas flow monitor, you can even use your liquid gas heater while you are driving.

The gas cylinders are connected with the country-specific hoses for your location. Which means that you can use SecuMotion anywhere in Europe, on the camp site or on the road.

Integrated gas flow monitor

Safe heating even when driving

Optimum basis for the DuoComfort two-cylinder system

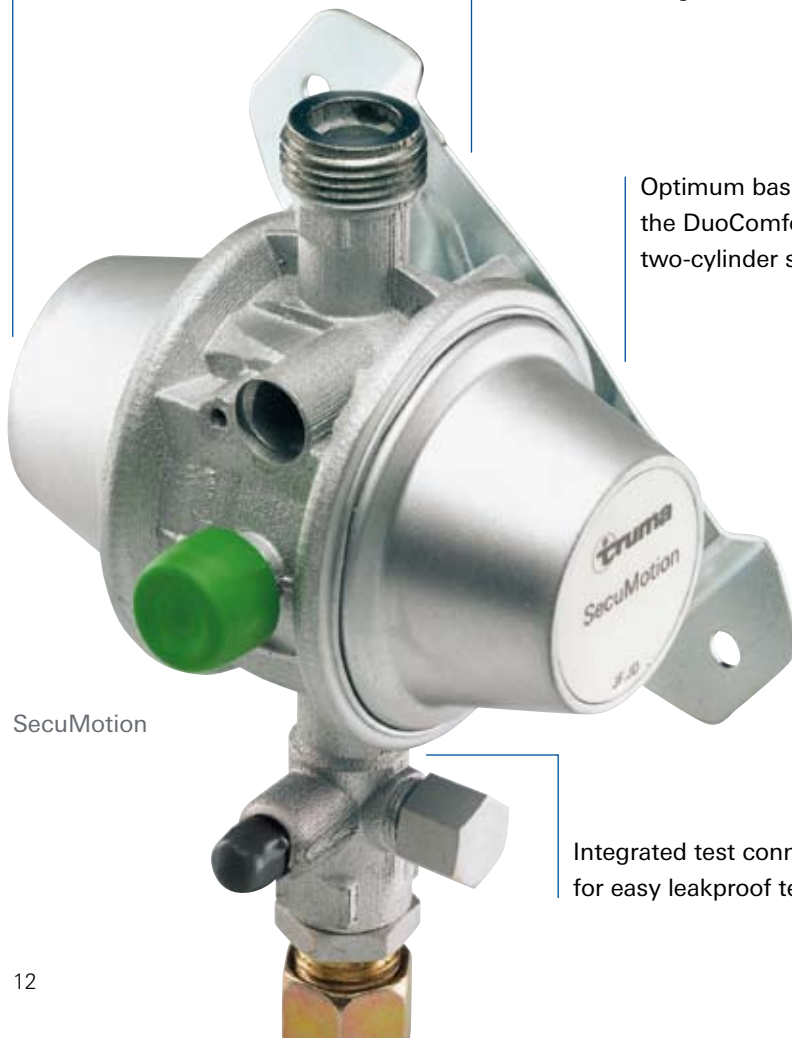

SecuMotion

Also available as a gas tank model

Integrated test connection for easy leakproof testing





# Energy systems

## DuoComfort

**For an uninterrupted gas supply.**  
Employed in a two-cylinder system, DuoComfort automatically switches over to the spare cylinder when the main cylinder is empty. A visual display on the regulator indicates the status of the current cylinder.

- DuoComfort complies with all guidelines for heating while driving\*.
- Perfect addition to SecuMotion
  - Automatically switches over to spare cylinder when main cylinder is empty
  - Status indicator for current cylinder
  - Main cylinder can be selected by rotary switch

\* with high-pressure hoses with rupture protection

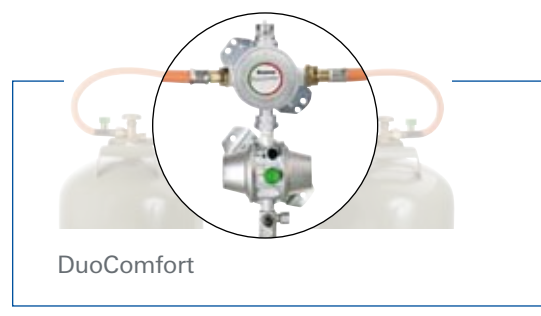

DuoComfort

## DuoControl

**Two cylinders – one unit.**  
With DuoControl a two-cylinder system can be retrofitted with the greatest of ease. DuoControl is a gas pressure regulator and changeover valve in one unit. When the current cylinder is empty, DuoControl switches over automatically to the spare cylinder.

- Retrofittable in vehicles (manufactured before end of 2006) for stationary heating\*
- Gas pressure regulator and changeover valve in a single unit
- Automatically switches over to spare cylinder when main cylinder is empty
- Status indicator for current cylinder
- Main cylinder can be selected by rotary switch

\* with high-pressure hoses without rupture protection

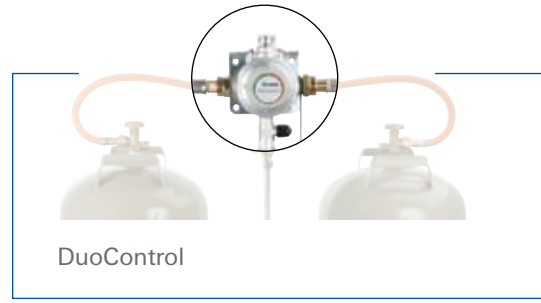

DuoControl

## High-pressure hoses

**The right hose in the right place.**  
Never again will you have to suffer supply problems due to incompatible cylinder valves – with Truma country-specific hoses you can travel wherever you like with confidence. Depending on requirements, our country-specific hoses are supplied with or without rupture protection.

- The integrated rupture protection means that these hoses can be used for heating while driving anywhere in Europe.
- Six country-specific high-pressure hoses
  - Gas supply without problems, anywhere in Europe

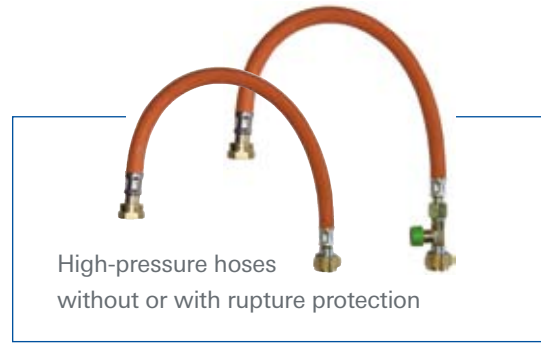

High-pressure hoses without or with rupture protection

## The latest in convenient gas supply.

If you think gas power is a complicated matter, then you haven't discovered Truma. With our kits, you have comfort and convenience on every trip. Naturally, all Truma products are perfectly configured for simultaneous use. For all-round energy comfort.



## Energy systems

### DuoC remote indicator

**All clear.** DuoC, the new remote display system for DuoComfort and DuoControl, is fitted to the vehicle interior, and indicates which cylinder is currently in operation and which is the spare. So there are no more nasty surprises. Which is also the purpose of EisEx. It prevents the regulator from freezing up at low temperatures. All you have to do is activate winter mode via the remote display.

- Current status (full/empty) of the gas cylinders is displayed in the vehicle interior
- EisEx prevents the regulator from freezing in cold temperature conditions



DuoC remote indicator

### Gas remote switch

**Everything is under control.** With the Truma gas remote switch it is a simple matter to shut off the gas supply from the interior. Now you no longer need to go to the cylinder box and close off the supply valve. Highly convenient and very safe.

- Shut off the gas supply without exiting your vehicle
- A comfortable addition to single and double cylinder systems

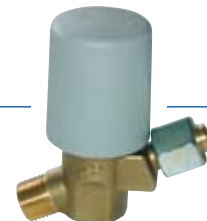

Gas remote switch

### Technical Data

	DuoC remote indicator	Gas remote switch
<b>Operating voltage</b>	12 V	12 V
<b>Power consumption</b>	1.5 mA	2 A (for opening)
<b>Average consumption in constant operation</b>	Summer: 1.5 mA Winter incl. EisEx: 160 mA	40 mA



## TG 1000 sinus power inverter

**One for all.** Even on a camping holiday, there are many things that you just don't want to do without. And the TG 1000 sinus power inverter makes sure that you have the power to run all manner of equipment and appliances – such as a coffee machine, radio, television, CD player, laptop, or hairdryer. The power inverter provides an independent energy supply with up to 1,000 W total power consumption. So you can enjoy as much comfort when you are out and about as you do when you are at home.

**Independent cooling.** With the TG 1000 sinus power inverter for Saphir compact and Saphir vario, you can enjoy perfect cooling comfort in all situations. When you are travelling through the countryside, you can cool your vehicle via the alternator or battery. And at the camp site, you can use the 230 V mains connection. The intelligent system automatically recognises which power source is currently in use.

- Automatic recognition of 12 V or 230 V input voltage
- Supplies a pure 230 V sine-wave current for sensitive loads
- Constant operation for all devices up to 1,000 W
- Top safety characteristics for carefree comfort
- Various kits available for adding extra functions

- Cools while driving, with power fed from the alternator (Saphir compact and Saphir vario)
- Completely independent cooling using battery (Saphir vario)

The **intelligent addition** to Truma air conditioning systems.  
For more information see pages 4 to 7.



TG 1000 sinus power inverter

### Technical Data

	TG 1000 sinus power inverter
<b>Input voltage</b>	10.5 V... 14.8 V direct current (additional battery)
<b>Output power</b>	1,000 W at 45°C ambient temperature (constant operation)
<b>Output voltage</b>	230 V ± 5% alternating current (sine wave)
<b>Weight</b>	approx. 2.0 kg
<b>Dimensions L x W x H</b>	300 x 160 x 72 mm



## Take the heat with you

If you have ever sat in a damp camper van in driving rain with the temperatures plummeting, you will certainly have learnt to appreciate the benefits of good heating. This is not only essential in winter, but also in the interim seasons, during bad weather, and on cool summer nights.

With a comfort heating system from Truma, you can enjoy your motorcaravan or caravan for a greater part of the year. The holiday season is never ending, increasing your scope for extra adventure. You can have a camping trip whenever and wherever you like – spring, summer, autumn or winter, on stormy North Sea beaches, or up in the mountains.





Does this idea fill you with a warm glow? Particularly when you realise that our heating systems are borne of the experience gained from producing more than five million heating units for caravans and motorcaravans. The benefit to you is perfectly clear – the incomparable reliability which has made Truma the most trusted brand among discerning campers.

## Heating comfort from the professionals.

For more than 50 years, Truma has led the market for heating systems in Europe. Whichever Truma heater you use, you can be sure to benefit from the expertise of a technical pioneer and a real trend setter. For example their unbeaten efficiency – Truma heating systems have an efficiency of 95 %. A warm glow of satisfaction is guaranteed!



## Heating systems

### Front case with flame effect

**The romance of the caravan.** It doesn't get any cosier than this: now you can even sit in front of the fire when you are away from home – you can even hear the crackling of the wood. It is easy to enjoy this special atmosphere – the exclusive flame effect casing can be added quickly and simply.

- Startlingly realistic flame effect
- Wood fire crackle
- Easy to retrofit
- Operates independently of heating
- Only for S 5002



Front case with flame effect

### Ultraheat

**The electric auxiliary heater.** Employed together with the Trumatic S, it uses the latter's fan to distribute the warm air throughout the caravan.

- For rapid heating whatever the weather
- Three power levels for custom heating comfort



Ultraheat

### Trumatic S 3002 / S 5002

**Perfect for the caravan.** The Trumatic S is fitted as standard to virtually all caravans. But if required, it is also easy to retrofit. Choose between the Trumatic S 3002, with 3,400 W suitable for medium-size caravans, and the Trumatic S 5002, whose 5,500 W make it the perfect choice for large caravans and mobile homes.

- In the absence of electricity, it can still be operated without the fan
- Warm air is distributed by the extensive Truma warm air system
- High efficiency for low gas consumption



Trumatic S 3002 / S 5002



## Heating systems

### Trumatic S 2200

For cosy comfort in small spaces.

With an output of 1,850 W, the Trumatic S 2200 is the ideal solution when it comes to warming up a small caravan as quickly as possible.

- Competitive price
- Compact size
- Flexible installation

### Trumatic S 3002 FS

Heat your awning safely. Now the

awning can be as comfortable as the caravan. With its closed combustion air circulation, the Trumatic S 3002 FS is ideal for safe and fast heating.

- Easy assembly thanks to pre-mounted installation box
- Rapid heating of awning
- Closed combustion air circulation
- Fresh air intake through side panel
- Exhaust flue in roof



Trumatic S 3002 FS



#### Technical Data

	Ultraheat	S 5002 (E)	S 3002	S 3002 FS	S 2200
<b>Nominal thermal output</b>	500 W/1,000 W/ 2,000 W	5,500 W propane/butane 4,600 W natural gas	3,400 W	3,400 W	1,850 W
<b>Gas consumption</b>		60–480 g/h propane/butane 64.5–517 l/h natural gas	30–280 g/h	30–280 g/h	50–170 g/h
<b>Weight</b>	2 kg	17.5 kg	9.8 kg	18.5 kg including case and fan	6.7 kg
<b>Current consumption for automatic ignition, 1.5 V</b>		50 mA	50 mA	50 mA	50 mA
<b>Current consumption, 230 V</b>	500 W: 2.2 A 1,000 W: 4.5 A 2,000 W: 8.5 A	Models with automatic ignition, 1.5 V, models with fan 12 V or 230 V			
<b>Operating voltage</b>	230 V ~, 50 Hz	Operation possible with or without fan, as required (see table in air technology section)			



## The right solution, whatever you need.

What is it you're looking for? Do you want a purely gas-powered heater or do you prefer a combined gas-electric model? Or maybe you require diesel heating. Do you just need a heater or would you also like a hot water supply. For large or small interiors. Truma heating systems offer all this and much more.



## Heating systems

### Heating and hot air in one.

The Combi family is characterised by its great flexibility. The heater can be operated without water and hot water is available without heating.

Choose from gas, gas/electric or diesel power, always with the highest efficiency to reduce the load on the vehicle battery and take the strain off your wallet.



### Combi 4 (E)/Combi 6 (E)

#### Our popular heaters

- Efficiency approx. 97 %
- Available in four variant models
- Combined gas/electric operation possible (E)

- Constant comfort temperature
- Four warm air outlets for perfect heat distribution
- Short water heating time for long and relaxed showering
- Highly durable, stainless steel water tank
- The lightest and most compact combination heater
- Fitted as standard with Frost-Control, the non-electric bleeder valve with frost monitoring
- Interior installation to protect from the effects of the environment, such as flying gravel, dirt and frost

### Combi D 6

#### The new diesel model

- Efficiency approx. 90 %
- The most efficient combination diesel heater

Environmentally friendly

Maintenance free



Combi (gas model)

Incomparably low electricity consumption

Easy to integrate into existing gas system

Virtually the same dimensions as the gas model

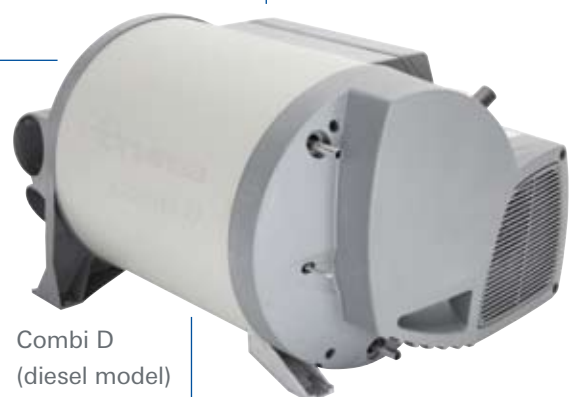

Combi D (diesel model)

Diesel burner designed by J. Eberspächer



## Heating systems

### Trumatic E 2400

**Compact and flexible.** 2,400 W of heating power and low space requirements. Can be installed in virtually any position, completely automatic operation thanks to electronic control unit: the E 2400 is the perfect, reliable and safe heater for small camper vans.

- Maintenance free operation
- Low electricity consumption
- Flexible installation positions
- Ideal as auxiliary heater
- Electronic control unit
- Also available for use with natural gas



Trumatic E 2400

### Trumatic E 4000

**All the heat you need.** With a thermal power output of 3,700 W the Trumatic E 4000 will fill even the biggest motorcaravans with warmth. It is controlled from the operating panel of an electronic control unit.

- Maintenance free operation
- Low electricity consumption
- Flexible installation positions
- Extreme power
- Electronic control unit



Trumatic E 4000

#### Technical Data

	Combi 4 (E) / Combi 6 (E)	Combi D 6	E 2400	E 4000
<b>Nominal thermal output</b>				
• Electric	900 W/1,800 W (E only)			
• Gas	2,000 W/4,000 W/6,000* W		2,400 W	3,700 W
• Diesel		2,000 W/4,000 W/6,000 W		
<b>Operating voltage</b>	12 V/230 V (E)	12 V	12 V	12 V
<b>Current consumption</b>	Heater + boiler at 12 V: 0.2–5.6 A Heating boiler 0.4 A at 230 V: 900 W: 3.9 A/1,800 W: 7.8 A	Heater + boiler at 12 V: 1.8–7 A Boiler mode: max. 1.8 A	12 V: 0.6 A/1.1 A	12 V: 1.0 A/2.3 A
<b>Standby current</b>	0.001 A	approx. 0.001 A	0.01 A	0.01 A
<b>Water capacity</b>	10 l	10 l		
<b>Water heating time</b>	From approx. 15°C to approx. 60°C: approx. 20 mins. (boiler)			
<b>Air flow rate</b>	max. 287 m³/h	max. 287 m³/h	Half setting: 49 m³/h Full setting: 78 m³/h	Half setting: 70 m³/h Full setting: 102 m³/h
<b>Gas consumption</b> burner levels 1/2/3	160 g/h/320 g/h/480* g/h gas consumption in regular operation at medium heat output (1,000 W) 80 g/h	220–630 ml/h fuel consumption in regular operation at medium heat output (1,000 W) 110 ml/h	Half setting: 100 g/h Full setting: 200 g/h <b>E 2400 E (nat. gas)</b> Half setting: 130 l/h Full setting: 240 l/h	Half setting: 150 g/h Full setting: 310 g/h
<b>Weight</b> (incl. periph. devices)	14.0 kg/15.1 kg (E)	15.8 kg	4.8 kg	8.6 kg
<b>Weight</b> (excl. periph. devices)	14.5 kg/15.6 kg (E)	17.2 kg	5.1 kg	8.9 kg

\* Combi 6 (E) only

## Comfort is in the air.

The even distribution of warm or cold air throughout the interior is of decisive importance. This is the only way to create even more comfort in caravans and motorcaravans, and it is the reason why we developed the sophisticated Truma air distribution system. Yet again, we are setting new standards of flexibility and efficiency.



## Air technology

### Truma fans

Truma has designed two fan models for reliable comfort and warmth: the Trumavent and the Multivent.

- High air throughput
- Easy installation
- Flexible applications

**Trumavent.** Runs on 12 V or 230 V and creates an even air distribution.

**Multivent.** A two-level 12 V universal fan, this is the perfect addition to the Trumatic S 2200 heater system.

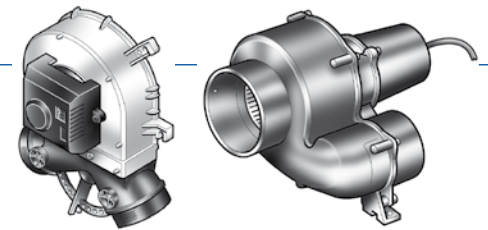

Trumavent and Multivent

### Airmix comfort kit

The Airmix mixes heat and air and is the ideal addition to the Trumavent fan for anyone who wishes to have a pleasant caravan climate. In summer, it functions like a ventilator, sucking in cool, fresh air from underneath the caravan, while in winter it adds fresh air to the heater air.

- Improves the climate in the caravan
- Ventilation and fresh air in summer
- Additional fresh air in winter

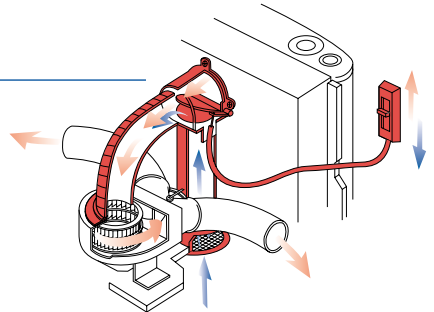

Airmix

### Technical Data

	<b>Trumavent fan</b> TEB-2 12 V for Trumatic S	<b>Trumavent fan</b> TN 230 V for Trumatic S	<b>Multivent fan</b> TBM 12 V
<b>Current consumption</b>	0.3–1 A (4–13 W)	0.5 A (65 W)	Half setting: 0.23 A (3 W) Full setting: 0.5 A (6 W)
<b>Air flow rate</b> using ventilator pipe ÜR Ø 65 mm ventilator pipe VR Ø 72 mm	135 m³/h 142 m³/h	169 m³/h 182 m³/h	Half setting: 29 m³/h Full setting: 60 m³/h





## Air technology

### Truma air distribution

Perfected down to the last detail, we have developed a special air technology kit to guarantee you all-round comfort. You can put together your ideal heating and air conditioning system with this perfectly configured modular system.

- Quiet air circulation
- Warm air directed at thermal bridges (e.g. windows or driver's cabin)
- Air flow regulation
- Adjustable flow direction

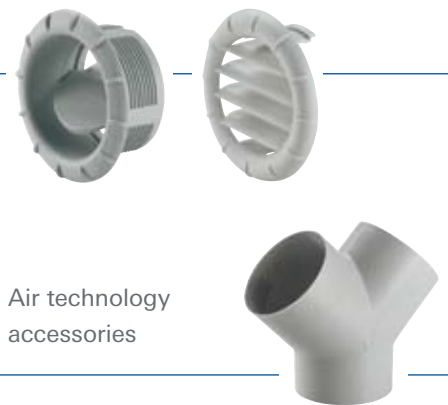

Air technology accessories

### Towel dryer

Five-star bathroom comfort. Whether you have towels to dry or ski shoes to warm: with the Truma towel dryer you can do it quickly and reliably. The hot air produces an even effect throughout the entire length of the support pipes. The swivel pipes can carry up to 4 kg. The riser pipe is particularly flexible, and can be shortened to suit installation requirements. The dimensions are (L x W x H) 760 x 420 x 80 mm and the weight is 0.7 kg.



- Highly flexible
- High-quality design
- Simple assembly



Towel dryer

## Water is well-being.

What do you need to start the day in good spirits or to cool off after a long hike? Of course – a refreshing shower. Truma water systems are of mature design and supply hot water just the way you want it. Whether from a shower or a tap. Convenience itself.



## Water comfort

### Electric boiler

**Hot water for longer.** Thanks to the special insulation, the water temperature in the electric boiler only falls by 1°C per hour. The water stays hotter for longer, representing a considerable energy saving.

**Noiseless**  
With highly effective sound insulation

**Short heating times**  
From 15°C to 70°C in only 70 minutes

**Low weight**  
Only 3 kg without water

**Suitable for drinking**  
Thanks to stainless steel water tank

**Easy assembly**  
Rapid, uncomplicated installation

Gas or electric? 5, 10 or 14 litres?  
Truma supplies

models to suit  
all requirements!



Electric boiler



## Water comfort

### Therme

Especially for the caravan.

This five-litre water boiler supplies convenient hot water with a small-dimension unit. The water is heated by the hot air from the heater. It is also fitted with an additional heater element.

- Water heated by hot air pipes from heater system and/or by an electric element
- Short heating times
- Compact dimensions



Therme

### Boiler B 10 / B 14

**Powerful.** The gas burner heats up the water extremely quickly without the need for vehicle current. The temperature settings are continuously variable. You can choose between capacities of 10 l and 14 l. For even quicker heating, you can also fit an additional 850 W electric element.

- Inexpensive gas-powered water heater
- Short heating times
- Water temperature range 30°C–70°C
- Stainless steel water tank



Boiler B 10 / B 14

#### Technical Data

	Electric boiler	Boiler B 10 / B 14	Therme
<b>Water capacity</b>	14 l	10 l / 14 l	5 l
<b>Dimensions L x W x H</b>	405 x 405 x 292 mm	10 l: 350 x 350 x 260 mm 14 l: 350 x 350 x 320 mm	370 x 220 x 230 mm
<b>Weight (empty)</b>	3 kg	6.7 kg / 7.3 kg	2 kg
<b>Water pressure</b>	Max. 2.8 bar	Max. 2.8 bar	Max. 1.2 bar
<b>Gas consumption</b>		120 g/h	
<b>Current consumption at 12 V</b>		Ignition: 0,17 A Heating: 0,08 A Standby: 0,04 A	
<b>Electric heating element</b>	230 V ~ (850 W)	Altern. 230 V ~ (850 W)	230 V ~ (300 W)
<b>Heating time</b>	From approx. 15°C to approx. 70°C: approx. 70 mins	For 10 l approx. 15°C to 70°C Gas mode: approx. 34 mins Electr. mode: approx. 45 mins Gas + electr.: approx. 25 mins	From approx. 15°C to approx. 60°C: approx. 50 mins
<b>Temperature limiter</b>	70°C	70°C	65°C





## Truma Service

With Truma you can travel without a care. Because you know that you can always rely on Truma. The excellent quality of our products as well as our services are your guarantee.

Should you ever require assistance [in Germany](#), our team of mobile service technicians is there to help you. They are all available throughout all federal states and they will come directly to your location. Our expert customer service personnel will give you advice over the phone, and our service workshop in Putzbrunn has the solution to any problem arising. You can also contact any Truma ServicePartner or KlimaProfi and benefit from their expertise.



## At your side throughout Europe

There are 34 service points available to you [in Europe](#) and throughout the world. Their addresses are listed in our comprehensive Truma service book. There is always somebody not far away who can be with you quickly, even in more remote countries like Iceland, Lithuania, and New Zealand.

Visit us [on the Internet](#) at [www.truma.com](http://www.truma.com), where you will find a wide range of product information along with a whole host of tips and answers to frequently asked questions. You can also download installation and user manuals for all Truma products. In the large service section of our homepage, we also tell you which Truma dealers in your area are looking forward to your visit.



## Quality "Made in Germany"

Truma is one of the world's leading manufacturers of comfort products for caravans, motorcaravans, utility vehicles, and boats. Truma has had a defining impact on the developments in the modern camping movement.

Every Truma product embodies 60 years of experience in the field. Our products' legendary reliability combined with our first-class service result in highly satisfied customers all over the world.

Our uncompromising Truma quality is exemplary. We are constantly applying our innovative spirit and enthusiasm to devise new solutions for making life on the road that much more comfortable.